



TECHNICAL SERVICE BULLETIN 980530-008

DATE: 01/01/98 page 1 of 2

TITLE:
REAR SQUEEGEE

APPLICABLE MACHINES:
530E

SYNOPSIS:

New parts for improved performance.

The squeegee lift cable, Tennant Company part number 86566, has been replaced by a new cable on machines with serial number 4000 and above. To replace the old cable order Tennant Company part number 12411. When replacing the old cable, the lift bracket 86871 should also be replaced.

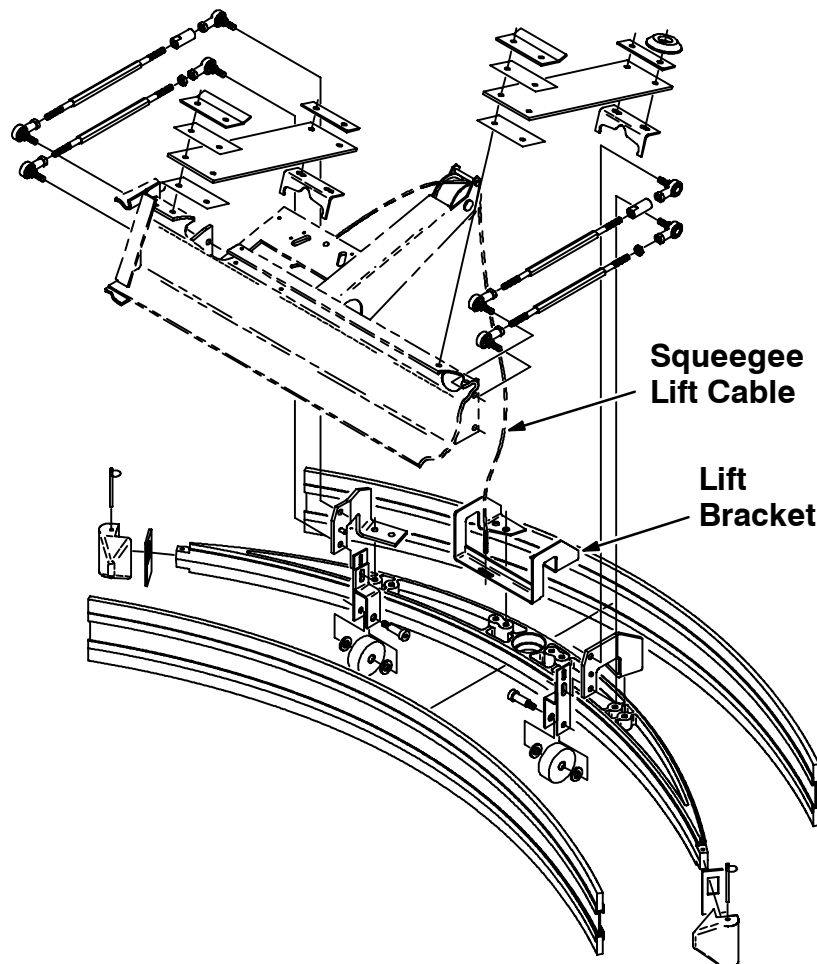

REAR SQUEEGEE LIFT CABLE AND BRACKET

SCRUBBER

If the rear squeegee cannot be adjusted for the correct deflection, check the wheel supports. Proper adjustment of rear squeegee is not possible if either, or both of the wheel supports are bent. Wheel support, Tennant Company part number 86805, has been strengthened to prevent the chance of bending. The new wheel support is now in production.

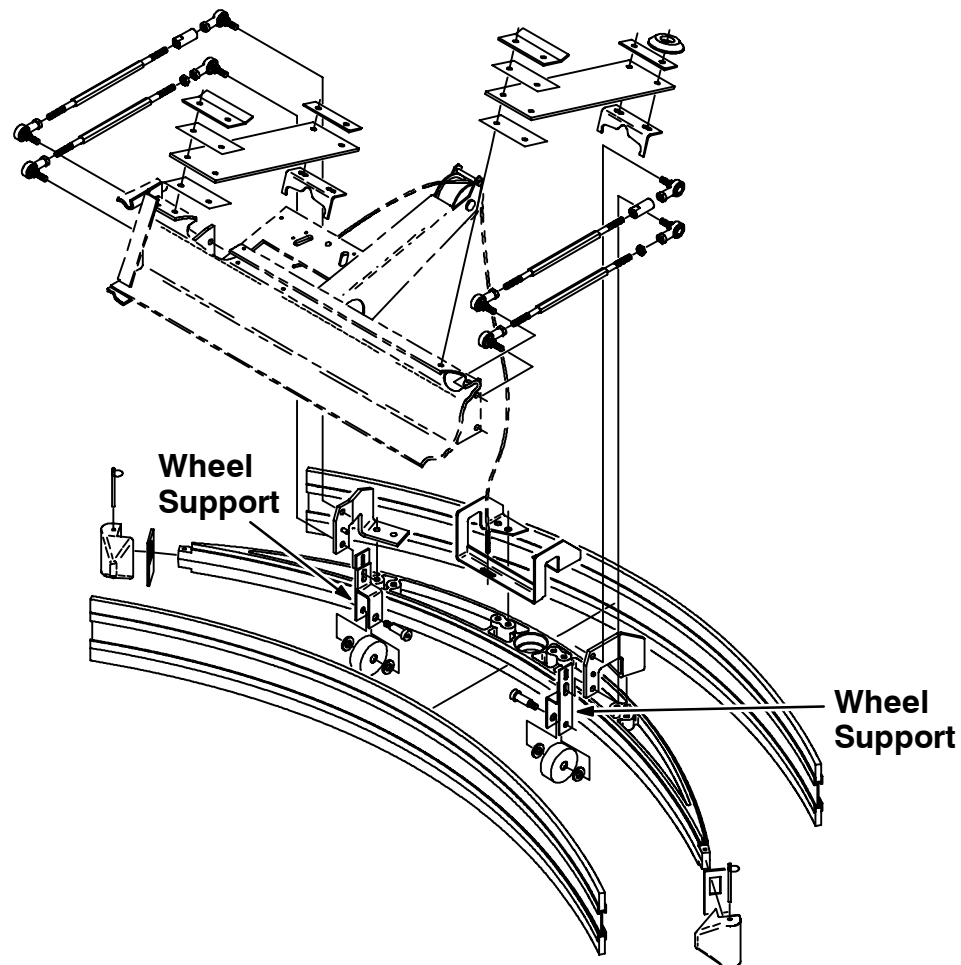

REAR SQUEEGEE WHEEL SUPPORT

04134