

# Technical Service Bulletin

**MODEL(S) AFFECTED:** **Speed Scrub 500 (SS500) Walk-behind Scrubber**

Models manufactured before May 11, 2017

**SUBJECT:** Potential drive wheel mounting hardware issue. The axle nut may back off and cause the wheel to become loose and possibly damage wheel and axle.

**PURPOSE:** To prevent axle nut from backing off, install improved hardware listed below.

**NOTES:** **Warranty Information:** When servicing machine on a non-related issue, replace the wheel mounting hardware accordingly. Standard warranty terms apply.

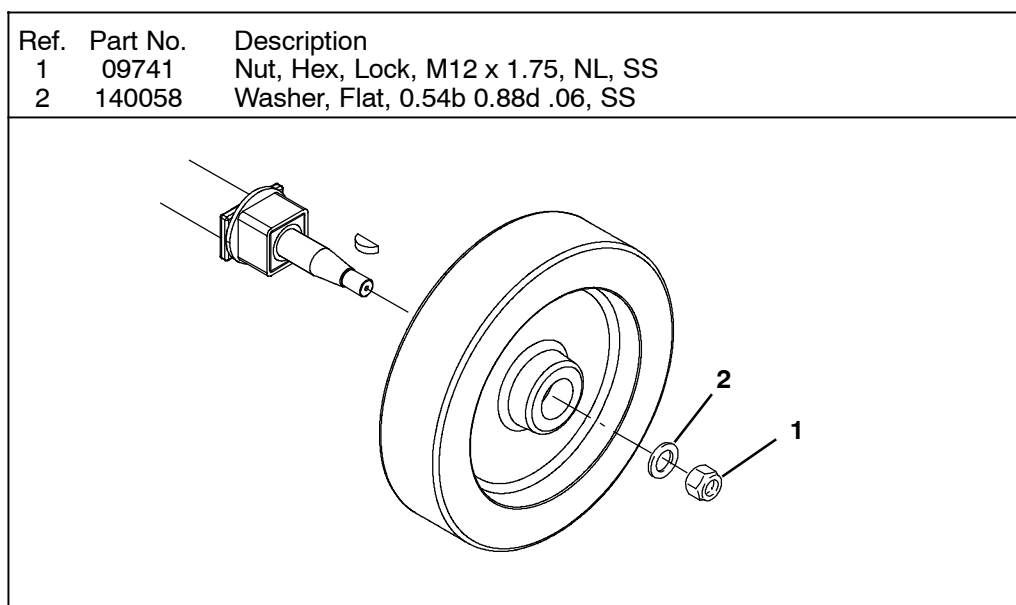

Maximum torque 24 Nm/18 ft-lbs. Do not over tighten nut. Higher torques will deform the center of the wheel, compromising the conical fit to the transaxle.