

Technical Service Bulletin

MODEL(S) AFFECTED: **M20 (machines serial numbers 007150 and below)**
M30 (machines serial numbers 004600 and below)

SUBJECT: Hardware securing the hydraulic cylinder(s) and the safety arm to the hopper arms coming loose due to not having Loctite 243® applied prior to installation.

PURPOSE: Inspect machines for loose hardware securing the hydraulic cylinder(s) and safety arm to the hopper arms. Remove loose hardware, apply Loctite 243, and reinstall / tighten hardware.

NOTES: **ALL MACHINES:**
FOR SAFETY: When using machine, make sure adequate clearance is available before raising hopper.
WARNING: Lift arm pinch point. Stay clear of hopper lift arms.
Park the machine on a level surface, raise the hopper, insert the hopper support pin into the middle hopper support hole, lower the hopper until it rests on the support pin, turn off the machine, set the parking brake, and remove the key from the ignition switch.
WARNING: Raised hopper may fall. Engage hopper support pin.
FOR SAFETY: Before leaving or servicing machine, stop on level surface, turn off machine, set parking brake, and remove key.
Refer to Fig. 1 / Fig. 3 for M20 machines and Fig. 2 / Fig. 3 for M30 machines if the hardware securing the hydraulic cylinder(s) and safety arm to the hopper arms is loose.
Questions, contact the Tennant Customer Service Department at (800) 553- 8033 or (763) 513- 2850.
Warranty Information: Standard terms apply.

M20

1. Remove top M6 hex screw from upper clevis pin plate / pin. Set M6 hex screw aside.
2. Apply Loctite 243 into blind hole in pin.
3. Reinstall M6 hex screw into upper clevis pin plate / pin.
4. Remove bottom M6 hex screw from upper clevis pin plate / hydraulic cylinder.
5. Apply Loctite 243 onto threads of M6 hex screw.
6. Reinstall M6 hex screw into upper clevis pin plate / hydraulic cylinder.
7. Repeat Step 1 through Step 6 for hardware securing safety arm to hopper arms.

Loctite 243® is registered trademarks of the Henkel Corporation

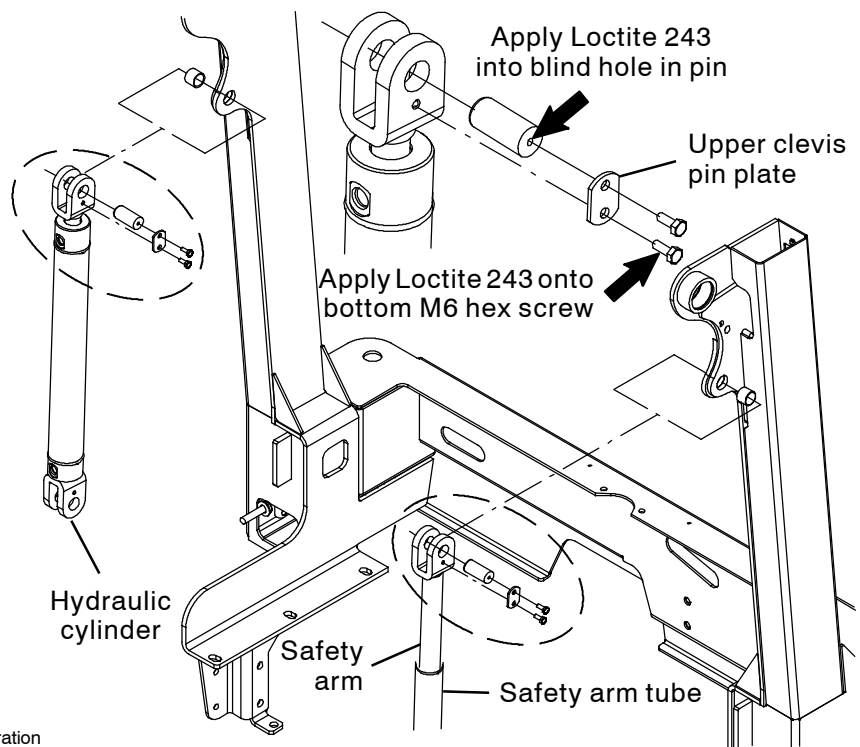
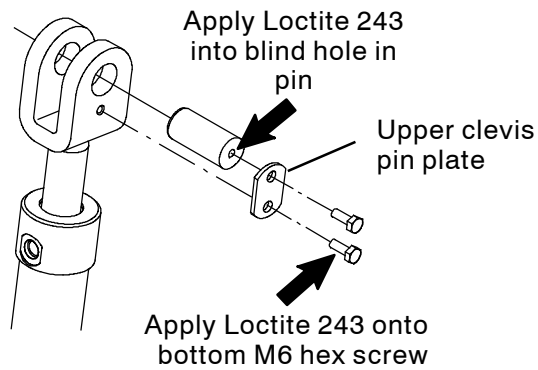
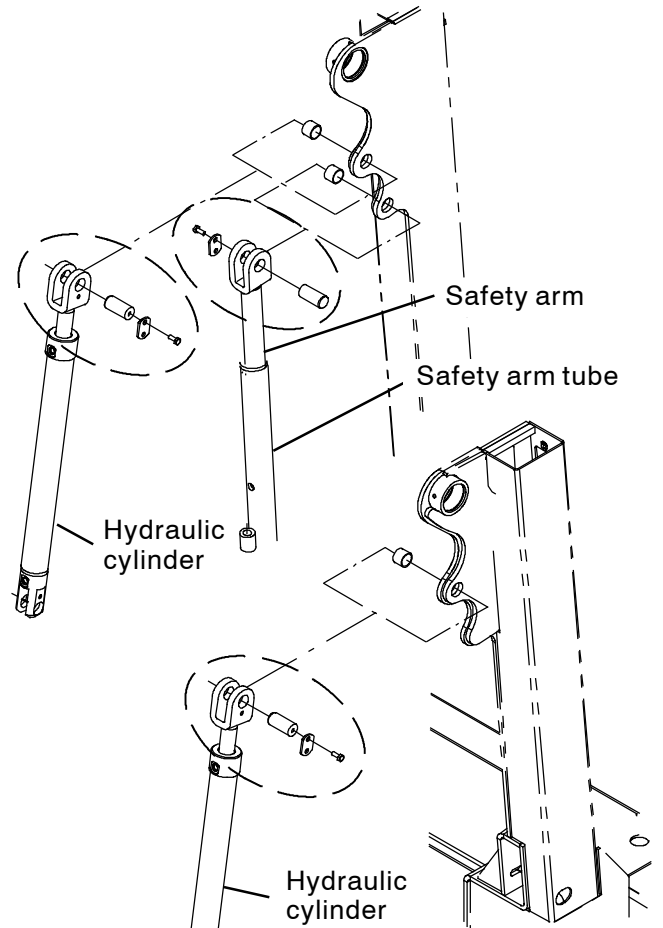
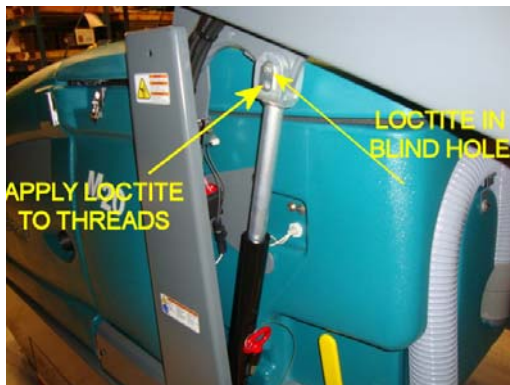

FIG. 1

M30

1. Remove top M6 hex screw from upper clevis pin plate / pin. Set M6 hex screw aside.
2. Apply Loctite 243 into blind hole in pin.
3. Reinstall M6 hex screw into upper clevis pin plate / pin.
4. Remove bottom M6 hex screw from upper clevis pin plate / hydraulic cylinder.
5. Apply Loctite 243 onto threads of M6 hex screw.
6. Reinstall M6 hex screw into upper clevis pin plate / hydraulic cylinder.
7. Repeat Step 1 through Step 6 for hardware securing safety arm and other hydraulic cylinder to hopper arms.

**FIG. 2**M20
MachinesM30
Machines**FIG. 3**