



INSTRUCTION BULLETIN

No. 3785
Machine: 515/515SS
Published: 3-96/00
System: SWEEPING

NOTE: DO NOT DISCARD the Parts List from the Instruction Bulletin. Place the Parts List in the appropriate place in your machine manual for future reference. Retaining the Parts List will make it easier to reorder individual parts and will save you the cost of ordering an entire kit.

NOTE: Numbers in parenthesis () are reference numbers for parts listed in Bill of Materials.

Installation Instructions for Kit number 363488

SYNOPSIS / PROBLEM:

This kit contains the parts needed to replace a sweeper lift actuator on the model 515/515SS machine

Please follow step-by-step instructions.

SPECIAL TOOLS / CONSIDERATIONS: None

(Estimated Time to complete: 1 hour)

ACTUATOR INSTALLATION:

(Refer to FIG. 1)

1. Stop the machine and set the machine parking brake.
2. The hopper must be in the down position.

FOR SAFETY: Before Leaving Or Servicing Machine; Stop On Level Surface, Set Parking Brake, Turn Off Machine And Remove Key.

3. Remove the right hand side cover.
4. Disconnect the sweeper assembly lift actuator from the main harness.
5. Remove the cotter and clevis pins holding the lift actuator to the machine frame and sweeper frame. Remove the actuator. (Refer to FIG. 1)
6. Lift the sweeper assembly up until it is within 1/4 in. of the bottom of the machine frame. Install blocks under the assembly frame. (Refer to FIG. 1)
7. Position the new actuator on the sweeper frame in the same orientation as the old one. Place the tube end in the sweeper first. Do not install the clevis pin yet. (Refer to FIG. 1)
8. Reconnect the back of the head lift actuator to the main machine frame. Reconnect the actuator to the main electrical harness. (Refer to FIG. 1)
9. Turn on the machine and extend the actuator all the way out. Screw the tube in or out until the mount hole in the tube lines up with the top end of the mounting slot on the sweeper frame. Install the clevis and cotter pin. Remove the blocks from under the frame. Lower the assembly. (Refer to FIG. 1)

10. Reinstall the right hand side panel.

NOTE: Make sure the top of the sweeper assembly frame does not hit the bottom of the machine frame.

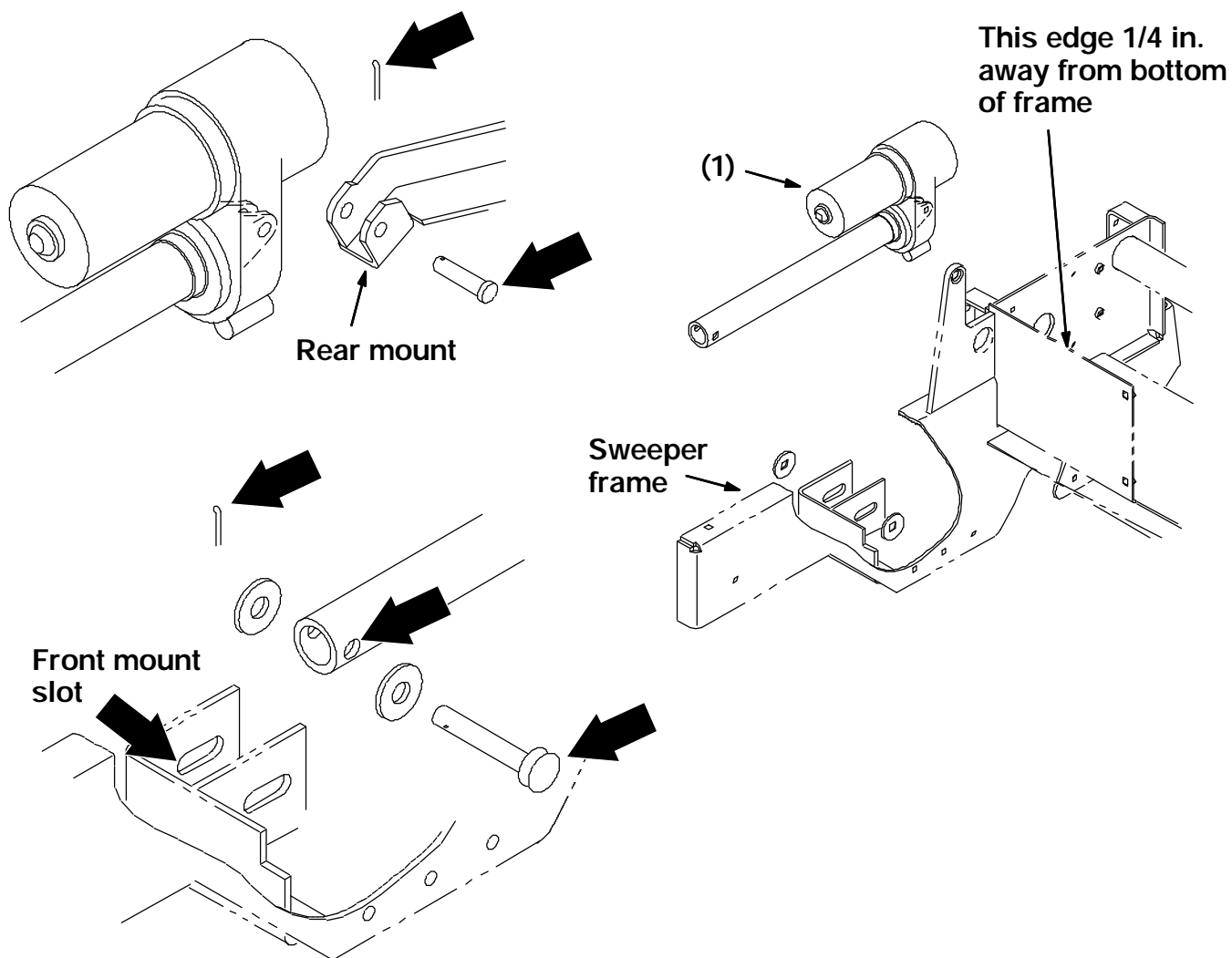

FIG. 1- Sweeper Assembly

11. Operate the machine and check the sweeper assembly lift actuator for proper operation.

BILL OF MATERIALS FOR ACTUATOR REPLACEMENT KIT 363488

Ref.	TENNANT Part No.	Description	Qty.
1	363099	Actuator	1

TENNANT COMPANY
P. O. Box 1452
Minneapolis, MN 55440-1452