



## INSTRUCTION BULLETIN

No. 3759  
Machine: 510  
Published: 10-95/00  
System: SCRUBBING

**NOTE: DO NOT DISCARD the Parts List from the Instruction Bulletin. Place the Parts List in the appropriate place in your machine manual for future reference. Retaining the Parts List will make it easier to reorder individual parts and will save you the cost of ordering an entire kit.**

*NOTE: Numbers in parenthesis ( ) are reference numbers for parts listed in Bill of Materials.*

Installation Instructions for Kit number 363421

### **SYNOPSIS / PROBLEM:**

This kit contains the parts needed to replace the rear squeegee lift lever bearing sleeve and brass washer on the model 510 scrubber. The existing fiberglide and brass washer may have worn and caused a loose condition in the lift lever pivot area. The new sleeve and fiberglide washers will eliminate this problem.

Please follow step-by-step instructions.

**SPECIAL TOOLS / CONSIDERATIONS:** None

(Estimated Time to complete: 1 hour)

### **INSTALLATION:**

(Refer to FIG. 1)

1. Lower the rear squeegee and turn off the machine. (Refer to Fig. 1)

**FOR SAFETY: Before leaving or servicing machine, stop on level surface and set parking brake. Then turn off machine and remove key.**

2. Reach in over the top of the rear squeegee and remove the hex screw holding the squeegee lift lever to the squeegee mount frame. Retain this hex screw and washer. (Refer to Fig. 1)
3. Lift the squeegee lift lever up enough to remove the existing brass washer, bearing sleeve, and fiberglide washer. Discard these three pieces of hardware. (Refer to Fig. 1)
4. Install one new fiberglide washer (2) under the lift lever in place of the brass washer. (Refer to Fig. 1)
5. Install the new bearing sleeve (1) and the second fiberglide washer (2) on top of the lift lever. (Refer to Fig. 1)
6. Reinstall the hex screw and washer. Tighten to 37 - 48 Nm (26 - 34 ft lb). (Refer to Fig. 1)
7. Start the machine and operate the rear squeegee. Check for proper operation of the rear squeegee lift lever.

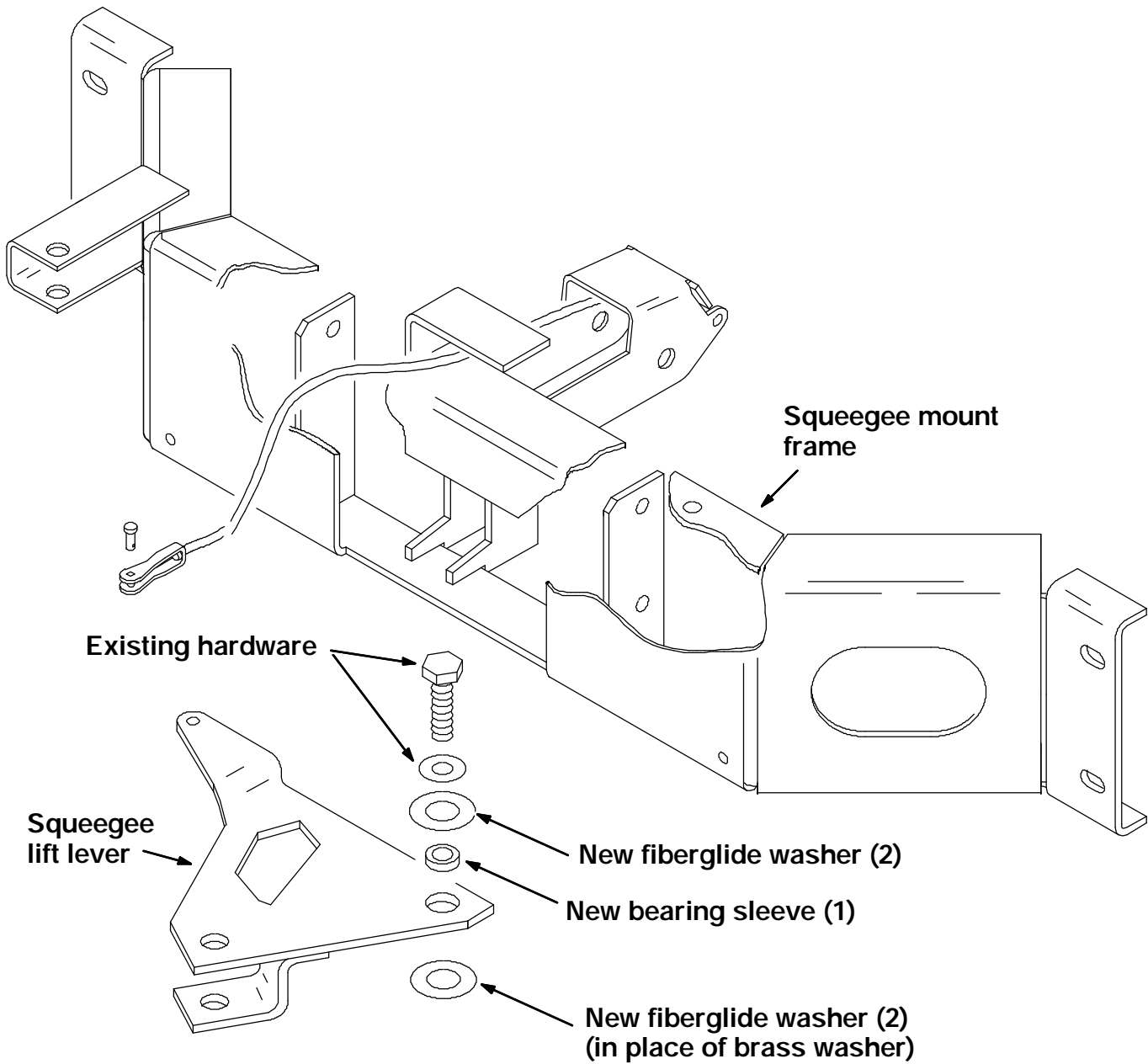

**FIG. 1 - Rear Squeegee Lift Lever Assembly**

**BILL OF MATERIALS FOR REAR SQUEEGEE LIFT LEVER BEARING KIT 363421**

Ref.	TENNANT Part No.	Description	Qty.
1	363420	Bearing sleeve	1
2	64425	Fiberglide washer	2

TENNANT COMPANY  
P. O. Box 1452  
Minneapolis, MN 55440-1452