



INSTRUCTION BULLETIN

No. 762057-3692

Machine: 830

Published: 02-95/00

System: HYDRAULICS

NOTE: DO NOT DISCARD the Parts List from the Instruction Bulletin. Place the Parts List in the appropriate place in your machine manual for future reference. Retaining the Parts List will make it easier to reorder individual parts and will save you the cost of ordering an entire kit.

NOTE: Numbers in parenthesis () are reference numbers for parts listed in Bill of Materials.

Installation Instructions for Kit number 762057

SYNOPSIS / PROBLEM:

This kit contains the parts needed to install a side brush relief valve on the machine listed above. Please follow step-by-step instructions.

SPECIAL TOOLS / CONSIDERATIONS: None

(Estimated Time to complete: 3 hours)

PREPARATION:

(Refer to FIG. 1)

1. Lower the right and left (if equipped) side brushes.

FOR SAFETY: Before leaving or servicing machine, stop on level surface and set parking brake. Then turn off machine and remove key.

2. Remove the knobs from the hydraulic valve handles inside the cab area. (Refer to Fig. 1)
3. Remove the knobs from the water valve handles inside the cab area. Use a 2.5 mm hex key to loosen the set screw on the knob.
4. Remove the valve top access panel. (Refer to Fig. 1)

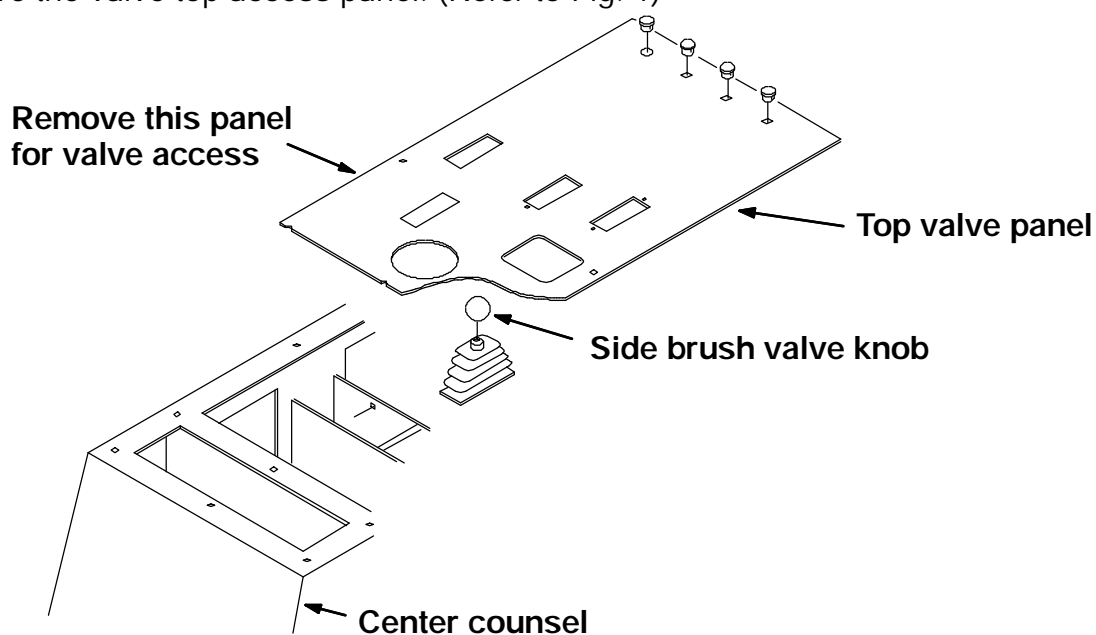

FIG. 1 - Remove Top Valve Panel

INSTALLATION:

(Refer to FIG. 1 and 2)

1. Disconnect hose #762403 (the hose with the 90° end) from port "B" on the side brush valve (#762042 RH and #762037 LH). (Refer to Fig. 2)
2. Install cap (5) on the tee fitting were the hose was removed in step 1. (Refer to Fig. 2)
3. Install plug (6) in the end of the hose that was removed in step 1. Tie this hose to the hose next to it using a wire tie or electrical tape. (Refer to Fig. 2)

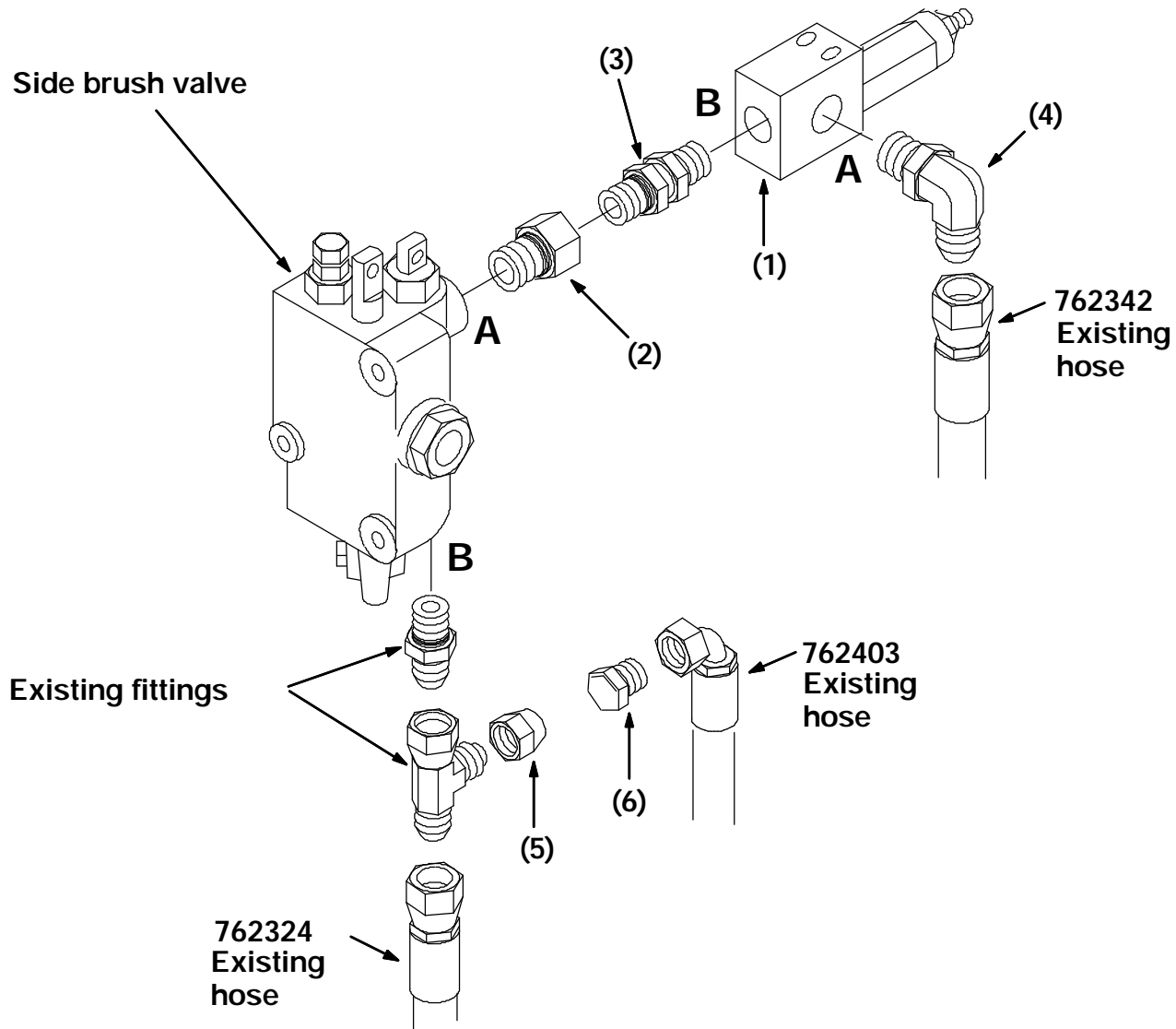

FIG. 2 - Side Brush Valve Assembly

4. Disconnect hose #762342 from the fitting in the "A" port of the side brush valve. (Refer to Fig. 2)
5. Remove the 90° fitting from the "A" port of the side brush valve. Discard fitting. (Refer to Fig. 2)
6. Install straight fitting (2) in the "A" port of the side brush valve. (Refer to Fig. 2)
7. Install union fitting (3) in the straight fitting that was installed in step 6. (Refer to Fig. 2)
8. Install port "B" of the new relief valve (1) on the union fitting installed in step 7. (Refer to Fig. 2)

9. Install 90° fitting ~~a~~ in port "A" of the new relief valve (1). Point the fitting down.
(Refer to Fig. 2)
10. Connect hose # 762342, that was disconnected in step 4, to the 90° fitting ~~a~~ that was installed in step 9. (Refer to Fig. 2)
11. Start the machine and raise and lower the side brushes. Check all the hoses for leaks.
12. Reinstall the valve top access panel. (Refer to Fig. 1)
13. Reinstall the water and hydraulic valve knobs. (Refer to Fig. 1)

BILL OF MATERIALS FOR SIDE BRUSH VALVE KIT 762057

Ref.	TENNANT Part No.	Description	Qty.
1	762070	Kickback relief valve	1
2	762065	Straight fitting, 6-8	1
3	762499	Union fitting	1
4	762446	90 degree fitting	1
5	762155	Cap fitting	1
6	762440	Plug fitting	1

TENNANT COMPANY
P. O. Box 1452
Minneapolis, MN 55440-1452