



# INSTRUCTION BULLETIN

No. 3460

Machines: 355/385, 355E, 800/  
810D 6550E, 6500/6550,

Published: 02–2007

Rev: 03

**NOTE: DO NOT discard Parts List from Instruction Bulletin. Place Parts List in the machine manual for future reference. Retaining the Parts List will make it easier to reorder individual parts and saves the cost of ordering an entire kit.**

*NOTE: Numbers in parenthesis ( ) are reference numbers for parts listed in Bill of Materials.*

Installation Instructions for Replacement Kits:

56346 for fault lamps on Models 355 and 385  
59950 for lamps on Model 355E  
59957 for instrument panel on Model 355E  
59959 for circuit board on Model 355E  
59960 for touch panel on Model 355E  
59970 for instrument panel on Models 355/385 and 800/810 diesel  
59971 for backlighting lamps on Models 355 and 385  
59974 for circuit board on Models 355 and 385  
59979 for touch panel on Models 355 and 385  
379657 for circuit board on Model 6500E  
379658 for circuit board on Model 6500/6550  
379659 for instrument panel on Model 6500E  
379660 for instrument panel on Models 6500 and 6550

## SYNOPSIS:

These kits contain parts needed to replace lamps, instrument panels, touch panels, and circuit boards on the 355/385, 355E, 800/810 Diesel, 6550E, and 6500/6550 machines. Please follow step-by-step instructions.

**SPECIAL TOOLS / CONSIDERATIONS:** None.

(Estimated Time to complete: 1 hour)

## PREPARATION:

1. Park the machine on a clean level surface, turn off the machine, remove the key, and set the parking brake.

**FOR SAFETY: Before leaving or servicing machine, stop on level surface, turn off machine, and remove key.**

2. Disconnect the battery cables from the batteries.



**WARNING: Always disconnect battery cables from machine before working on electrical components.**

3. **FOR CONTACT WITH CIRCUIT BOARD:**  
Attach the ground strap (4) to wrist and attach clip to the frame of the machine.

*NOTE: Use ground strap (4) to prevent static electricity from damaging the circuit board.*

4. Remove the existing sun shield and Velcro® strips from instrument panel if installed on machine. Retain these items for installation on new instrument panel. Remove four mounting bolts from instrument panel assembly. Retain hardware.
5. Carefully pull instrument panel assembly up and tilt forward. Rest assembly on machine frame.
6. Disconnect the wire harness from the case assembly by removing retaining screw with a 5/32" (4 mm) allen wrench.
7. Remove existing instrument panel from instrument panel shroud by removing four mounting screws. Retain hardware.

*NOTE: Velcro is a registered trademark of Velcro Industries B.V.*

**INSTRUMENT PANEL SHROUD INSTALLATION:**  
(Refer to Figure 1 and Figure 2)

1. Connect the wire harness to the instrument panel and use the existing retaining screw to secure the wire harness to the instrument panel.
2. Use four existing mounting screws to install the instrument panel onto the instrument panel shroud (1).
3. Use the existing hardware to install the instrument panel shroud (1) onto the machine frame.
4. **800 / 810 diesel:** Install the touch panel cover label (12) over the throttle controls on the instrument panel.

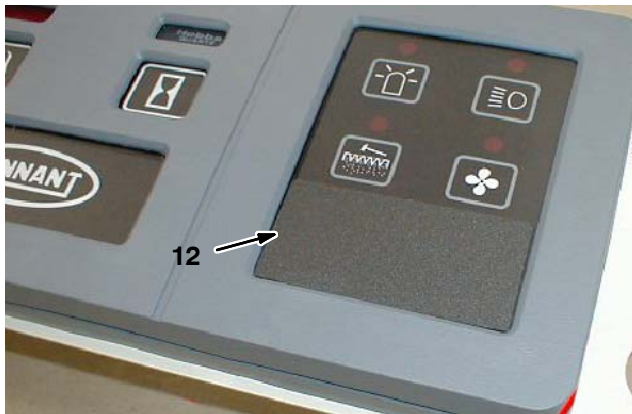

**FIG. 1-800/810 Diesel Only**

**FAULT LAMP INSTALLATION:**  
(Refer to Figure 2)

1. Place instrument panel face down and remove twelve pan screws from case assembly. Retain hardware.
2. Remove four pan screws from center of case box and remove case box from case assembly. Retain hardware.
3. Remove the burned out lamps from the circuit board.
4. Install new lamps (10) in new sockets (11).
5. Install new lamp assemblies (10)(11) into the circuit board.
6. Use twelve existing pan screws to install the case box onto the case cover.
7. Install four pan screws on center of case box.
8. Use the four existing mounting screws to install the instrument panel onto the shroud.
9. Connect the wire harness to case assembly and use the existing retaining screw to secure the wire harness to the case assembly.
10. Use existing hardware to install the instrument panel assembly onto the machine frame.

**LAMP INSTALLATION:**  
(Refer to Figure 2)

1. Place instrument panel face down and remove twelve pan screws from case assembly. Retain hardware.
2. Remove four pan screws from center of case box and remove case box from case assembly. Retain hardware.
3. Remove the burned out lamps from the circuit board.
4. Install the new lamps (2) into the new sockets (3).
5. Install new lamp assemblies (2)(3) into the circuit board.
6. Use twelve existing pan screws to install the case box onto the case cover.
7. Install four pan screws on center of case box.
8. Use four existing mounting screws to install the instrument panel onto the shroud.
9. Connect wire harness to instruction panel and hold in place with existing retaining screw.
10. Use existing hardware to install the instrument panel assembly onto the machine frame.

**CIRCUIT BOARD INSTALLATION:**  
(Refer to Figure 2)

1. Place instrument panel face down and remove twelve pan screws from case assembly. Retain hardware.
2. Remove four pan screws from center of case box and remove case box from case assembly. Retain hardware.
3. Remove one existing seal from case box and gasket from contact connector on circuit board.
4. Disconnect the 7-pin connector and ground strip from circuit board.
5. Remove eight pan screws from circuit board and remove circuit board from touch panel assembly. Retain hardware.
6. Remove touch panel assembly from case cover and remove seal from case cover.
7. Install a seal (6) into case cover and install touch panel assembly in case cover.

*NOTE: Grease may be used to hold seal in place for assembly.*

8. Using existing hardware to install the new circuit board (5) onto the touch panel assembly.

*NOTE: Route the 7-pin connector and ground strip through slot in circuit board before installing hardware.*

9. Connect the 7-pin connector and ground strip to the circuit board.
10. Install a seal (6) into the case box and the connector gasket (7) onto the contact connector. Be sure the mounting holes are aligned.

*NOTE: Grease may be used to hold seal in place for assembly.*

11. Use the twelve existing pan screws to install the case box onto the case cover.
12. Install four pan screws on center of case box.
13. Use the four existing mounting screws to install the instrument panel onto the shroud.
14. Connect wire harness to case assembly and hold in place with existing retaining screw.
15. Use existing hardware to install the instrument panel assembly onto the machine frame.

**TOUCH PANEL ASSEMBLY INSTALLATION:**  
(Refer to Figure 2)

1. Place instrument panel face down and remove twelve pan screws from case assembly. Retain hardware.
2. Remove four pan screws from center of case box and remove case box from case assembly. Retain hardware.
3. Disconnect the 7-pin connector and ground strip from circuit board.
4. Remove eight pan screws from circuit board and remove circuit board and light tray from touch panel assembly. Retain circuit board, light tray, and hardware.
5. Remove touch panel assembly from case cover.
6. Install new touch panel assembly (8) and new plastic sleeves (9) in case cover.
7. Use the existing hardware to install the circuit board assembly and light tray onto the touch panel assembly.

*NOTE: Route the 7-pin connector and ground strip through slot in circuit board before installing hardware.*

8. Connect the 7-pin connector and ground strip to the circuit board.
9. Use the twelve existing pan screws to install the case box onto the case cover.
10. Install four pan screws on center of case box.
11. Use the four existing mounting screws to install the instrument panel onto the shroud.
12. Connect wire harness to case assembly and hold in place with existing retaining screw.
13. Use existing hardware to install the instrument panel assembly onto the machine frame.

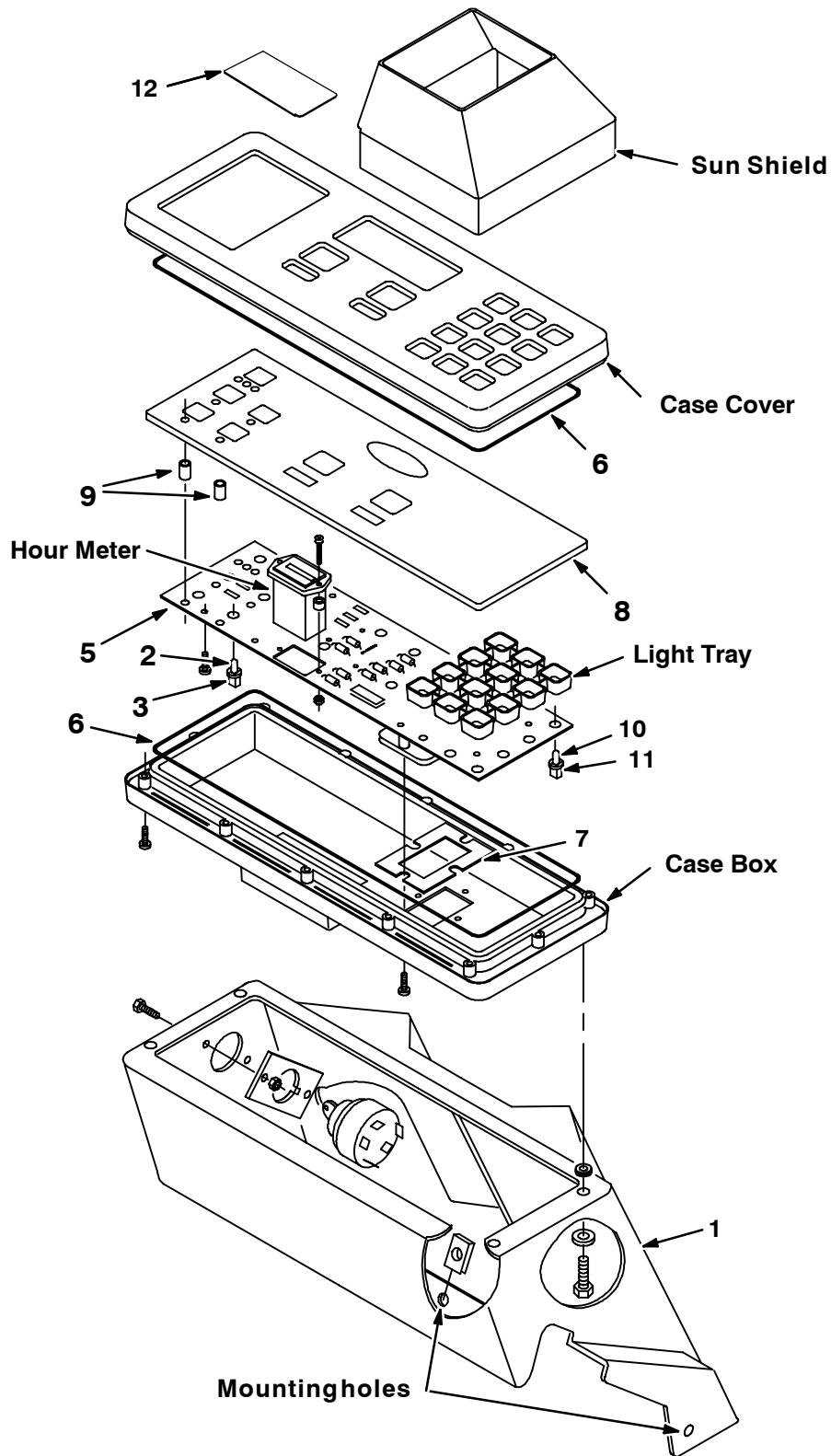

FIG. 2 - Instrument Panel Assembly

**BILL OF MATERIALS FOR REPLACEMENT KITS FOR MODEL 355E**

<b>Ref.</b>	<b>TENNANT Part No.</b>	<b>Description</b>	<b>Qty.</b>
1	59957	Instrument Panel Replacement Kit	1
	59956	Panel, Instmt, Ele	1
2	59950	Lamp Replacement Kit	1
	59963	Lamp, 12vdc, Watt 0.10A 0.7cp [#74]	8
	59973	Lampholder	8
	27964	Strap, Static Ground, Disposable	1
5	59959	Circuit Board Replacement Kit	1
	59958	Circuitboard Assy, [355E]	1
	56316	Seal, Org, .070 X 12.00ID Non-Std	2
	1022298	Gasket, Connector	1
	27964	Strap, Static Ground, Disposable	1
8	59960	Touch Panel Replacement Kit	1
	71568	Panel Assy, Touch,[355E]	1
	56228	Tube, Plstc, 0.31D 0.25B 00.5L Blk	4
	27964	Strap, Static Ground, Disposable	1

**BILL OF MATERIALS FOR REPLACEMENT KITS FOR MODELS 355 / 385 AND 800 / 810 DIESEL**

<b>Ref.</b>	<b>TENNANT Part No.</b>	<b>Description</b>	<b>Qty.</b>
1	59970	Instrument Panel Replacement Kit	1
	56296	Panel, Instmt, Ele, [800/810]	1
	70646	Label, Cover 3.2 X 1.5 Blk, Touch Pnl	1
2	59971	Backlighting Lamp Replacement Kit	1
	59972	Lamp, 12vdc, Watt 0.08A 0.3cp [#73]	8
	59973	Lampholder	8
	27964	Strap, Static Ground, Disposable	1
5	59974	Circuit Board Replacement Kit	1
	56360	Circuitboard Assy, [800L/355L]	1
	56316	Seal, Org, .070 X 12.00ID Non-Std	2
	1022298	Gasket, Connector	1
	27964	Strap, Static Ground, Disposable	1
8	59979	Touch Panel Replacement Kit	1
	71567	Panel Assy, Touch,[355]	1
	56228	Tube, Plstc, 0.31D 0.25B 00.5L Blk	7
	27964	Strap, Static Ground, Disposable	1
10	56346	Fault Lamp Replacement Kit	1
	56330	Lamp, 12vdc, Watt 0.04A 0.3cp [#85]	8
	59973	Lamp socket	8
	27964	Strap, Static Ground, Disposable	1

**BILL OF MATERIALS FOR REPLACEMENT KITS FOR MODEL 6500E**

<b>Ref.</b>	<b>TENNANT Part No.</b>	<b>Description</b>	<b>Qty.</b>
1	379660	Instrument Panel Replacement Kit	1
	379640	Panel, Instmt, Ele, [6550E]	1
2 3 4	59950	Lamp Replacement Kit	1
	59963	Lamp, 12vdc, Watt 0.10A 0.7cp [#74]	8
	59973	Lampholder	8
	27964	Strap, Static Ground, Disposable	1
5 6 7 4	379657	Circuit Board Replacement Kit	1
	379641	Circuitboard Assy, [6550E]	1
	56316	Seal, Org, .070 X 12.00ID Non-Std	2
	1022298	Gasket, Connector	1
	27964	Strap, Static Ground, Disposable	1
8 9 4	59960	Touch Panel Replacement Kit	1
	71568	Touch panel assembly	1
	56228	Tube, Plstc, 0.31D 0.25B 00.5L Blk	4
	27964	Strap, Static Ground, Disposable	1

**BILL OF MATERIALS FOR REPLACEMENT KITS FOR MODELS 6500 AND 6550**

<b>Ref.</b>	<b>TENNANT Part No.</b>	<b>Description</b>	<b>Qty.</b>
1	379659	Instrument Panel Replacement Kit	1
	379646	Instrument panel shroud	1
2 3 4	59971	Backlighting Lamp Replacement Kit	1
	59972	Lamp, 12vdc, Watt 0.08A 0.3cp [#73]	8
	59973	Lampholder	8
	27964	Strap, Static Ground, Disposable	1
5 6 7 4	379658	Circuit Board Replacement Kit	1
	379647	Circuit board assembly	1
	56316	Seal, Org, .070 X 12.00ID Non-Std	2
	1022298	Gasket, Connector	1
	27964	Strap, Static Ground, Disposable	1
8 9 4	59979	Touch Panel Replacement Kit	1
	71567	Panel Assy, Touch,[355]	1
	56228	Tube, Plstc, 0.31D 0.25B 00.5L Blk	7
	27964	Strap, Static Ground, Disposable	1
10 11 4	56346	Fault Lamp Replacement Kit	1
	56330	Lamp, 12vdc, Watt 0.04A 0.3cp [#85]	8
	59973	Lamp socket	8
	27964	Strap, Static Ground, Disposable	1

TENNANT COMPANY  
P. O. Box 1452  
Minneapolis, MN 55440-1452