

IRIS Telemetry Kit

Models: B5, B7, Speed Gleam 5, Speed Gleam 7



This kit includes the necessary parts to install IRIS telemetry technology on a standard model.

INSTALLATION INSTRUCTIONS:

Installation Time: 1 Hour

NOTICE - The IRIS Telemetry Kit **MUST** be activated to complete the installation. After kit is installed **CALL** Technical Support to activate as described on page 5.

Tools Required: Phillips screwdriver, flat screwdriver, 7mm wrench, 13mm wrench, heat gun, 1/8" drill bit, and power drill.

KIT CONTENTS:

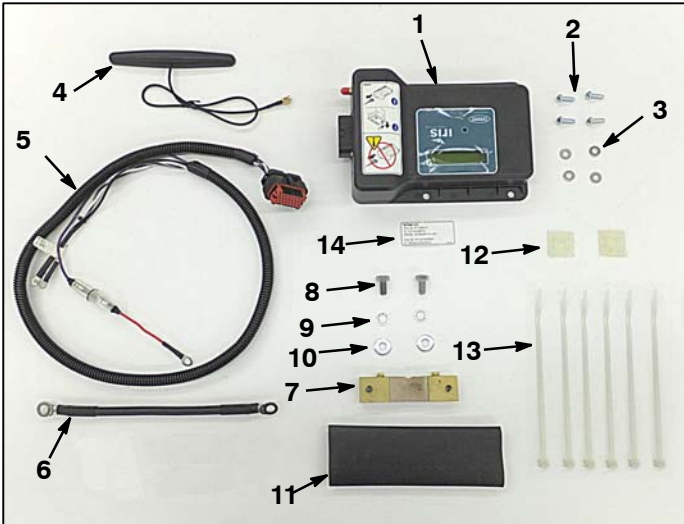

Ref	Part No.	Description	Qty.
1	1069467	Module, IRIS, Telem [USA, 3G] (Kit 9015256)	1
1	1070541	Module, IRIS, Telem [INTL, 3G] (Kit 9015257)	1
2	1043573	Screw, #10- 14 x 0.675, SPL	4
3	01683	Washer, Flat, 10, SS	4
4	1070659	Antenna, Telem, 70 in [GPRS]	1
5	1070495	Harness, Ele [Telem]	1
6	63740	Cable, 06GA 09.0L BLK .31RING/.31RING	1
7	1217304	Shunt [Empro, 250Amp/50mv, Metric]	1
8	15675	Screw, Hex, M8 x 1.25 x 16, SS	2
9	01685	Washer, Flat, 0.38b 0.88d, 08, SS	2
10	43952	Washer, Lock, Internal, 0.31,SS	2
11	1217818	Sleeve, Heat shrink, 1.50ID, 07.10	1
12	55248	Mount, Cable-tie	2
13	49266	Tie, Cable, Nyl, 7.3L, .19W, 1.8 Max. D	6
14	1069580	Label, Mach, Telem, FCC [USA/INTL]	1

1. Park the machine on a level surface, turn off the machine, remove key and set parking brake, if equipped.
2. Open the battery compartment hood and disconnect the red battery cable connector from the battery pack (FIG. 1).

FOR SAFETY: Always disconnect battery cables from machine before working on electrical components.

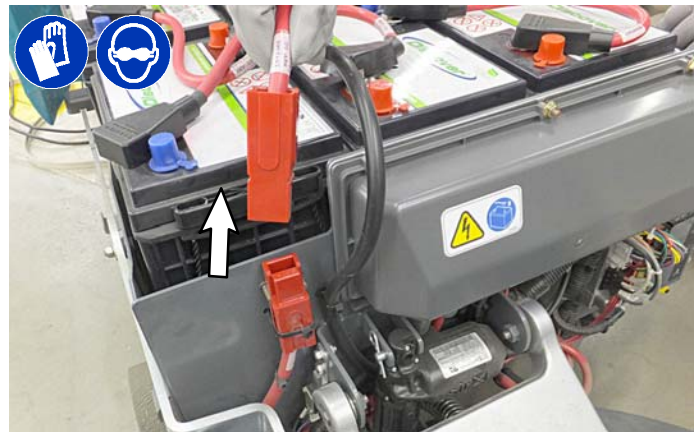

FIG. 1

3. Disconnect the hood lift arm from machine frame and carefully lower hood completely to floor (FIG. 2). Use a flat screwdriver to remove retainer clip from arm to disconnect arm as shown below.

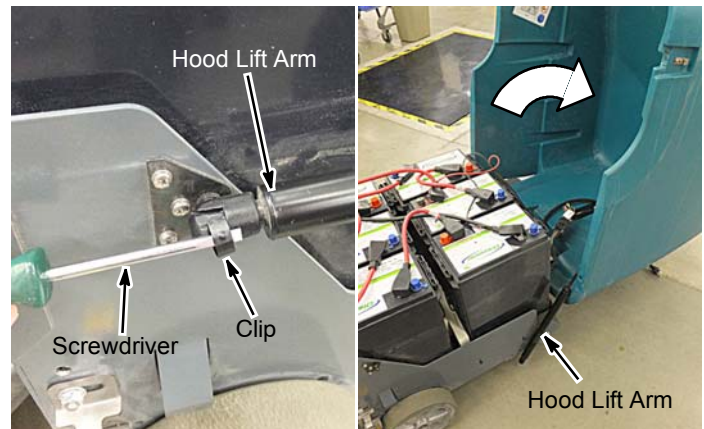

FIG. 2

4. Disconnect the machine's negative battery cable from battery as shown (FIG. 3). Remove rubber boot from cable.



FIG. 3

5. Re-install the rubber boot on the short battery cable. Then connect the short battery cable to the open negative battery terminal as shown (FIG. 4).



FIG. 4

6. IMPORTANT: To prevent possible damage to IRIS system during kit install, remove the in-line fuse from the IRIS harness (FIG. 5).

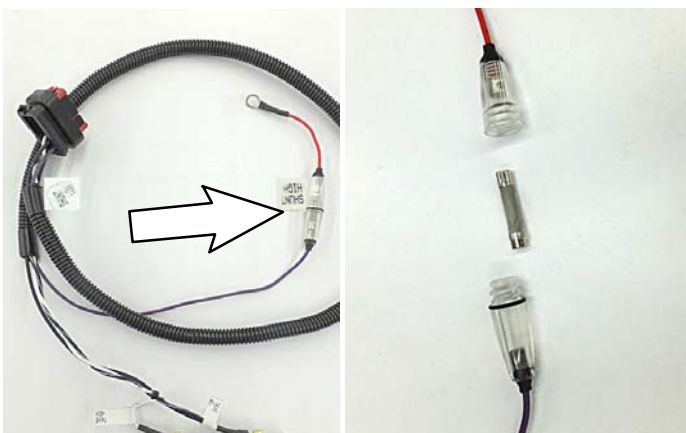

FIG. 5

7. Slide the heat shrink sleeve over the short battery cable as shown (FIG. 6).

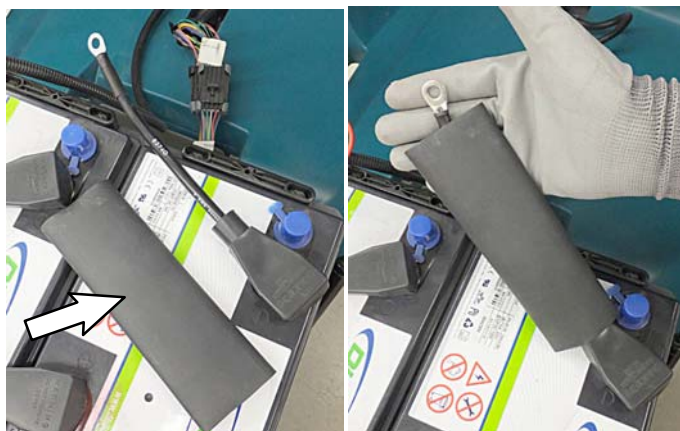

FIG. 6

8. Connect the white and black wires from IRIS harness to the shunt as shown (FIG. 7).

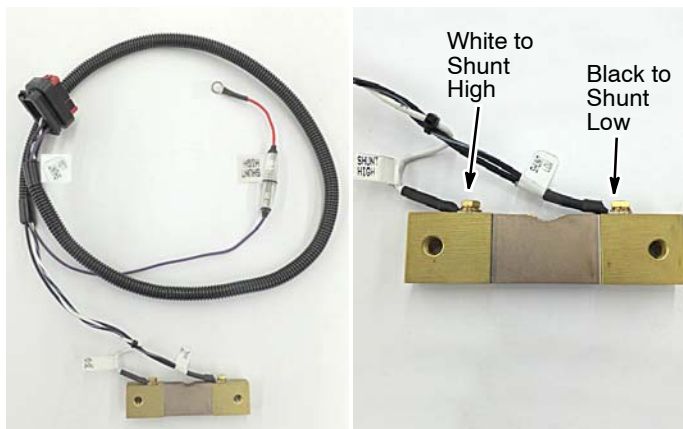

FIG. 7

9. Connect the short battery cable and the machine's negative battery cable to the shunt assembly as shown (FIG. 8). Use two M8x1.25 screws, flat washers and internal lock washers.

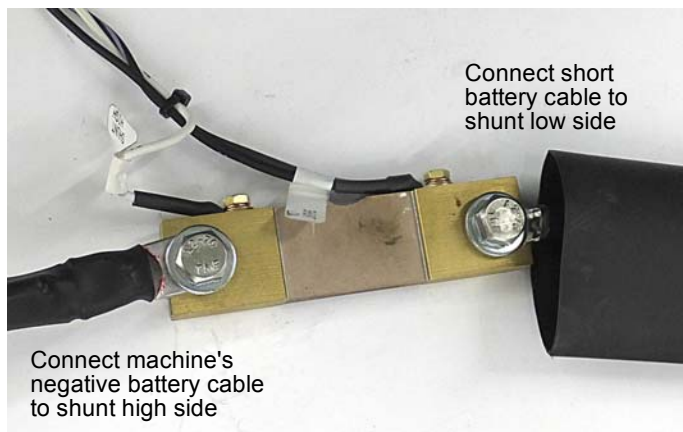

FIG. 8

10. Slide the heat shrink sleeve over the shunt assembly and apply heat to sleeve (FIG. 9). If heat gun is not available, cable-tie sleeve as shown.



FIG. 9

11. Secure the shunt assembly to the battery handle with two cable-ties as shown (FIG. 10).



FIG. 10

12. Remove the additional bar-code label located on the backside of the IRIS module and save. The 20 digit number printed on the label will be needed to activate the IRIS system (FIG. 11). Do not misplace label.



FIG. 11

13. Align the IRIS module with the four embossed circles on hood and mark the screw hole locations with a pen (FIG. 12).

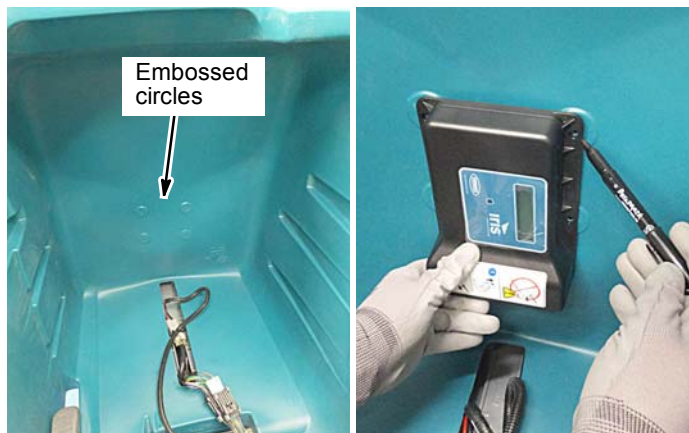

FIG. 12

14. Carefully drill four 1/8 inch holes into the hood and attach the IRIS module using four #10 self-tapping screws and flat washers (FIG. 13).



FIG. 13

15. Connect the IRIS harness and the antenna cable to the IRIS module (FIG. 14). Clean surface with isopropyl alcohol and adhere the antenna to the hood as shown.



FIG. 14

16. Clean surface with isopropyl alcohol and adhere two cable-tie mounts to hood as shown. Secure IRIS harness with cable-ties (FIG. 15).

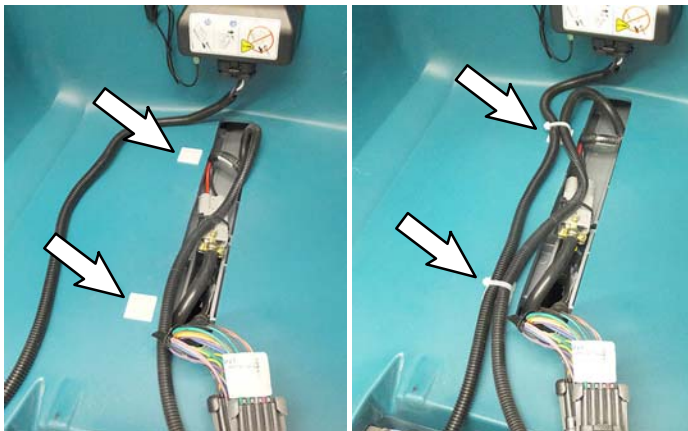

FIG. 15

17. Connect the in-line fuse wire from the IRIS harness to the positive battery terminal (FIG. 16).



FIG. 16

18. Re-install fuse IRIS harness (FIG. 17).



FIG. 17

19. Reattach the hood lift arm to machine frame and reconnect the red battery cable connector to the battery pack (FIG. 18).

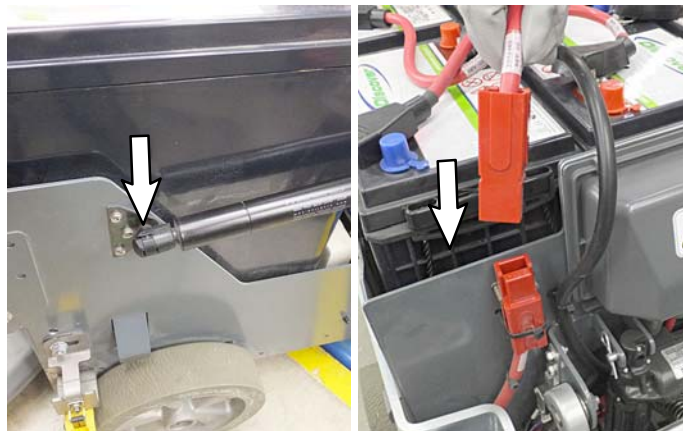

FIG. 18

20. Adhere the FCC label to the machine as shown (FIG. 19).

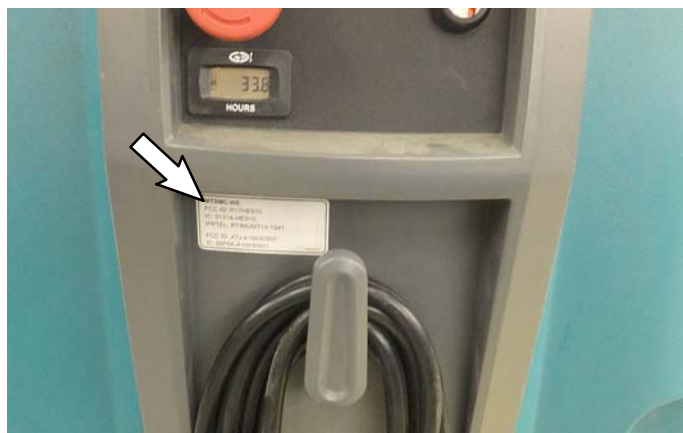

FIG. 19

21. Activate the IRIS telemetry system (See ACTIVATE THE IRIS TELEMETRY SYSTEM).

NOTE: The IRIS telemetry system must be activated to complete this installation. The system will not function until it is activated.

ACTIVATE THE IRIS TELEMETRY SYSTEM

NOTE: *The IRIS telemetry system must be activated to complete this installation. The system will not function until it is activated.*

For assistance to activate the IRIS telemetry system, call your customer service location:

Before calling, be sure to have the machine serial number and the 20 digit bar-code number available for activation (Figure 1).

USA Customer Service Location: Call Technical Support between hours 7:00 am and 5 pm CST, Monday through Friday.

Australia Customer Service Location: Call CCC between hours 8:00 am and 5 pm AEST, Monday through Friday. Ask to be routed to the IRIS expert for assistance.

Canada, Europe, Middle East, Africa Customer Service Location: Call local IRIS expert between hours 8:00 am and 5 pm, Monday through Friday.

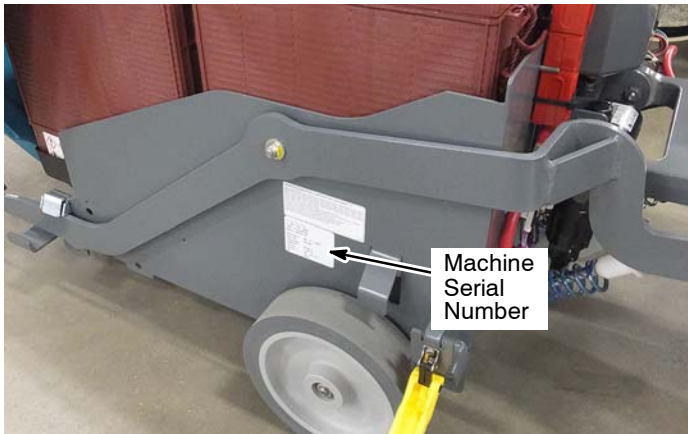

20 digit Bar-Code Number



Fig. 1