



Brush Motor Replacement Kit

7080, 7100, T15, EZ-Rider/HP



NOTICE: Imperial brush motors (p/n 390849, 1056103, 223358 and 223051) have been discontinued and replaced by this Amer motor kit. Install replacement motor kit as illustrated below at right. If the new Amer motor is used in conjunction with an early Imperial .50hp or .80hp motor, washer spacers are required as noted below.

7080, 7100, T15, EZ-Rider/HP Disk Models

Discontinued Motors

p/n 390849
(Imperial .50 HP Motor)

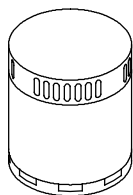

p/n 223358
p/n 223051
(Imperial .80 HP Motor)

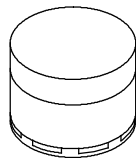

p/n 1056103
(Imperial 1.0 HP Motor)

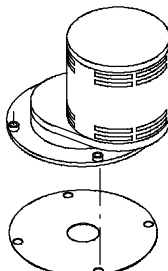
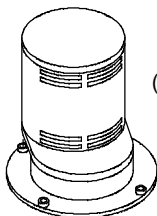

Dispose

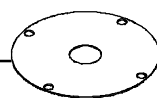

Dispose



Motor Replacement Kit (p/n 9006323)

NOTE: The shaft length on the new Amer motor is approximately a .25 in / 6.4 mm longer than some early Imperial motors. Add three washer spacers to the Amer motor if machine is also equipped with the .50HP or .80HP Imperial motor.

Use the longer .38- 16 x 1.00 screws (Item 7).

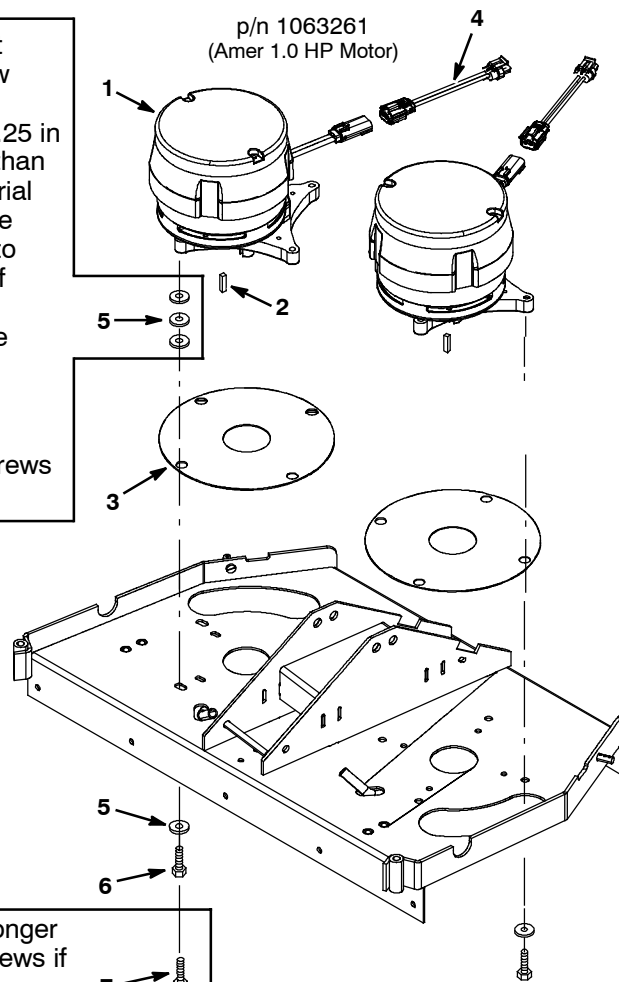

NOTE: Use the longer .38- 16 x 1.00 screws if washer spacers were required as noted above.

Kit Contents

REF	PART #	DESCRIPTION	QTY.
1	1063261	MOTOR, ELE 36VDC 300RPM 1.00HP GEAR	1
	1066573	CARBON BRUSH REPLACEMENT KIT, (Set of 4) For Motor 1063261 - Not included w/ kit.	1
2	00928	KEY, SQ, 0.25X0.25, 1.00L	1
3	1054264	GASKET, .06, 2.00ID 9.25OD, 4/8.4BC	1
4	1066734	HARNESS, ADAPTER, MOTOR	1
5	01686	WASHER, FLAT, 0.44B 1.00D .08, SS	16
6	02994	SCREW, HEX, .38- 16 X 0.75, SS	4
7	69225	SCREW, HEX, .38- 16 X 1.00, SS (Required when washer spacers are used as noted above)	4

Please keep this sheet with your owner's manual for future reference.