



ANTI-VIBRATION KIT

NOTE: This kit is intended for machines manufactured prior to 10/27/99.

INSTALLATION INSTRUCTIONS:

(Installation Time: 60 min.)

1. Remove scrubhead from machine per operations manual.
2. Remove (2) nuts #33 (fig. 1).
3. Remove brackets #23 & #48 (fig. 1). Brackets are tied to wire harness and will hang loose.
4. Before removing bracket #24, use a marker or scribe to mark its location on the solution tank wall. Mark both sides of the bracket. These marks will be used to assure proper alignment of the new bracket (fig. 1).
5. Remove and discard bracket assembly #24/#32 by removing (6) screws #31 (fig. 1).
6. Mount new bracket #24 to tank. Be sure to line up with the marks made on the side of the tank from the previous bracket (fig. 2).
7. Reinstall brackets #23 & #48 (fig 2).
8. Install new bracket #32 and related hardware (fig. 2).
9. Reinstall (2) nuts #33 (fig 2).
10. Reinstall scrubhead to machine.

TOOLS REQUIRED: 13mm, 9/16" Socket Wrench,
1/4" Allen Wrench.

#609212 KIT CONTENTS

P/N	Description	Qty.
608197	Bracket, Roller Scrub	1
608198	Roller, Linkage Scrub	1
45960	Screw, 3/8-16 Shldr	1
607920	Spring, .72 OD x .096	2
607568	Washer, .50 x 1.5	2
140046	Washer, 1.00x.392x.09	1
140515	Nut, 3/8-16 NYLCK SS	1
608199	Bracket, Track Roller	1

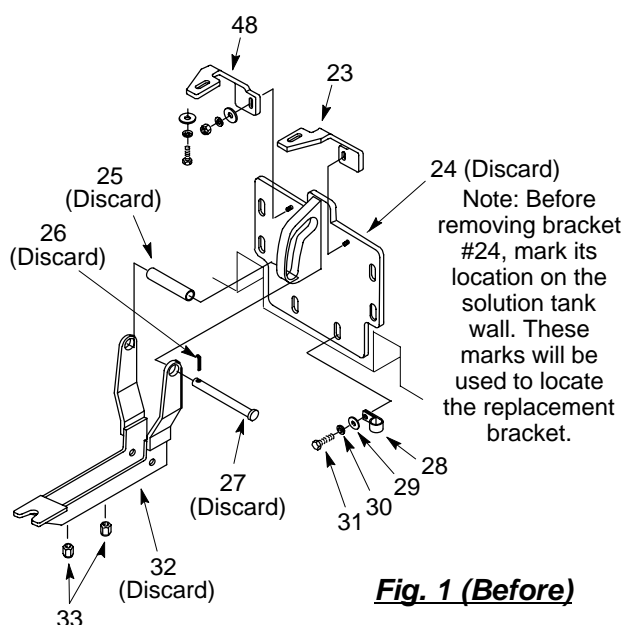
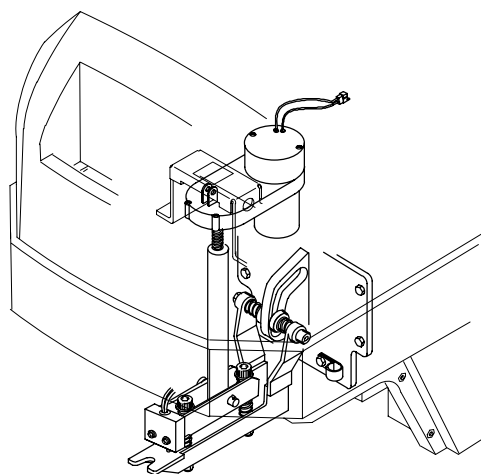

Fig. 1 (Before)



**Assembled
View (After)**

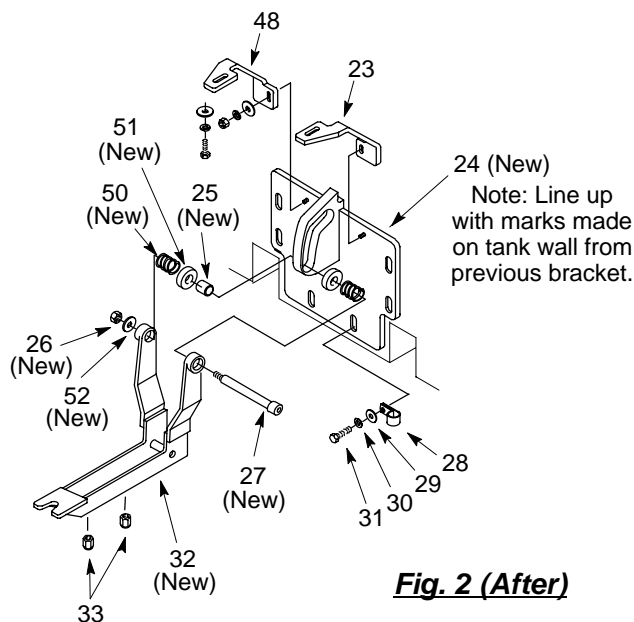

Fig. 2 (After)