



INSTRUCTION BULLETIN

No. 340859
Machine: 7300
Published: 04-2007
Rev. 00

NOTE: DO NOT DISCARD the Parts List from the Instruction Bulletin. Place the Parts List in the appropriate place in the machine manual for future reference. Retaining the Parts List will make it easier to reorder individual parts and will save the cost of ordering an entire kit.

NOTE: Numbers in parenthesis () are reference numbers for parts listed in Bill of Materials.

Installation instructions for **kit number 9003499**

SYNOPSIS:

This kit contains the parts needed to install/replace the circuit board on 7300 sweepers.
Please follow step-by-step instructions.

SPECIAL TOOLS / CONSIDERATIONS:

(Estimated time to complete: 1 hour)

PREPARATION:

1. Park the machine on a clean level surface, turn off the machine, and engage the parking brake.

FOR SAFETY: Before leaving or servicing machine, stop on level surface, turn off machine, and engage the parking brake.

2. To access the first diagnostic menu, simultaneously turn the key switch on while holding down the TENNANT Logo button (Refer to Fig. 1 for location of logo button on instrument panel). Hold the button for 5 seconds before releasing it. Use the logo button to scroll through diagnostic menus. **Scroll through each menu and record each programmable machine mode.**

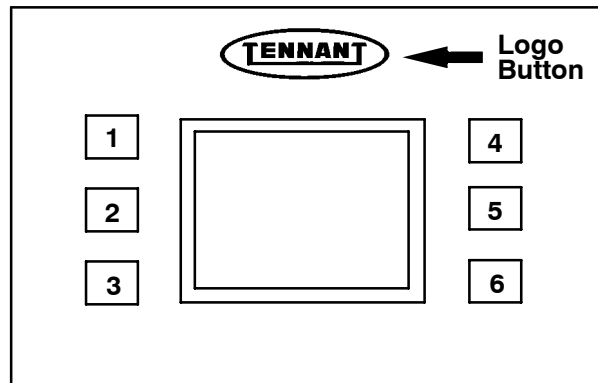

FIG. 1

*NOTE: If a light is on adjacent to the selectable mode, that mode is active. The programmable modes are: ENABLE LEFT SIDE BRUSH, ENABLE EDGE SCRUB, ENABLE MAINT., LANGUAGE, ENABLE SWEEP, RESTRICT PRESSURE, SCRUB SIDE BRUSH, GEL-BATTERY, REST. DET., and ENABLE LOW SOL. **All settings must be reprogrammed after the new new circuit board (1) is installed.***

3. Record the machine hours. The hour meter will clear to zero if the software is an earlier revision.

NOTE: If the machine has software revision KSC 021904, the hour meter will not be accurate if the machine has more than 100 hours. Call Tech Services for instructions how to clear the hour meter to zero. Refer to Fig. 1 for locations of switches 1 through 6 on instrument panel.

4. Turn the key switch off and remove the key.

FOR SAFETY: Before leaving or servicing machine, remove the key.

5. Disconnect the battery cables from the batteries.



WARNING: Always disconnect battery cables from machine before working on electrical components.

INSTALLATION:

1. Remove the circuit board panel from the machine. Set the panel and hardware aside. Open the black plastic case containing the main control board. Refer to Fig. 2 and Fig. 3.

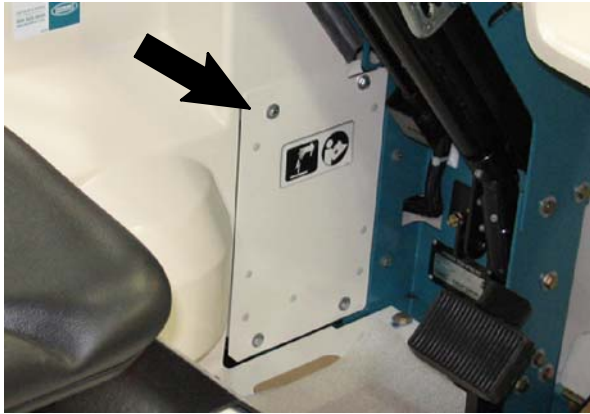

FIG. 2

2. Wrap the wrist band of the ground strap (2) around wrist and connect the other end of the ground strap to the frame of the machine.

NOTE: The ground strap (2) is used to prevent static electricity from damaging the circuit board. Failure to use the strap correctly can result in damage to electronic devices and assemblies. Keep the ground strap attached to wrist and ground through Step 6.

3. Disconnect the wire harnesses and ribbon cable from the control board assembly. Remove the circuit board assembly and black plastic enclosure from the machine. Set the enclosure and all mounting hardware aside.

4. Be sure the tape molds around the ribbon cable on the cover side and the ribbon cable seals tight against the foam seal for a waterproof fit. Use a bead of silicone sealer around the ribbon cable if needed.
5. Install the new circuit board (1) into the machine in the reverse order of which the old circuit board was removed and reconnect the ribbon cable to the circuit board.
6. Reconnect the battery cables to the batteries.
7. Simultaneously turn the key switch on while holding down the TENNANT Logo button to access the first diagnostic menu. If the language is scrambled, press the logo button three additional times to access diagnostic menu #4. Press the upper left button. The language will reset to English.
8. If the machine is equipped with GEL batteries, access diagnostic menu #6 and select the GEL-BAT option to reinitiate the battery gauge. Deactivate this option if the machine is not equipped with GEL batteries.
9. Access each of the diagnostic menus and turn on or off all the software selectable modes recorded earlier in this procedure. Reset the machine clock.
10. Start and operate the machine to ensure everything functions properly.

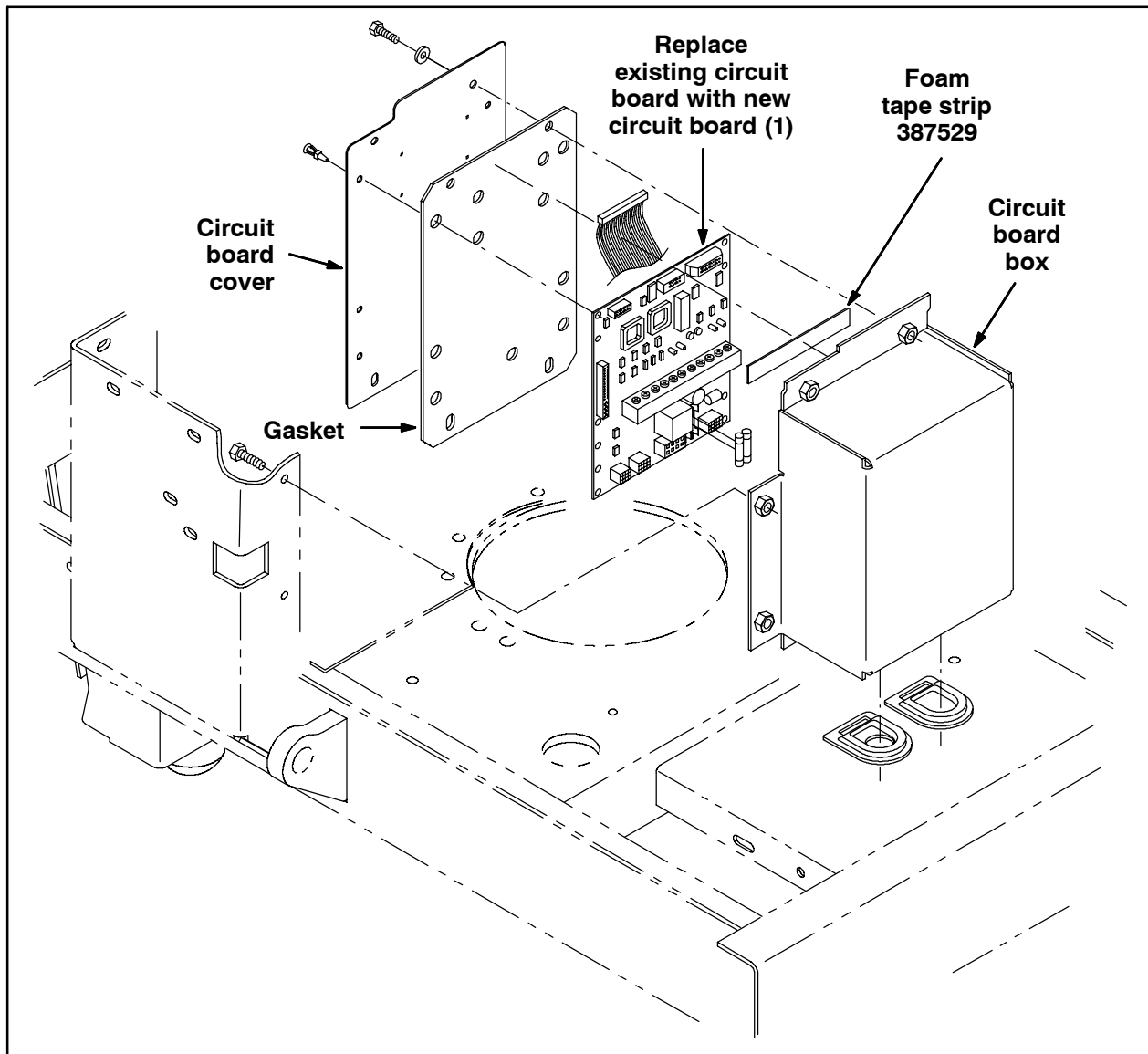

FIG. 3

Bill of Materials for Circuitboard Kit, Replmt [7300]-9003499

Ref.	Tennant Part No.	Description	Qty.
▽	9003499	Circuitboard Kit, Replmt [7300]	1
▲	1 374204	Circuitboard Assy [7300/8300] Imp	1
▲	2 27964	Strap, Static Ground, Disposable	1

TENNANT COMPANY
P. O. Box 1452
Minneapolis, MN 55440-1452