



INSTRUCTION BULLETIN

No. 340821
Machine: 7400, 8410
Published: 05-2006
Rev. 00

NOTE: DO NOT DISCARD the Parts List from the Instruction Bulletin. Place the Parts List in the appropriate place in the machine manual for future reference. Retaining the Parts List will make it easier to reorder individual parts and will save the cost of ordering an entire kit.

NOTE: Numbers in parenthesis () are reference numbers for parts listed in Bill of Materials.

Installation instructions for **kit number 9002632**

SYNOPSIS:

This kit contains the parts needed to install the FaST update harness on 7400 machines (below serial number 8091) and 8410 machines (below serial number 14333).
Please follow step-by-step instructions.

SPECIAL TOOLS / CONSIDERATIONS: NONE

(Estimated time to complete: 1 hour)

PREPARATION: (7400 & 8410)

1. Park the machine on a clean level surface, engage the parking brake, shut off the machine, and remove the key.

FOR SAFETY: Before leaving or servicing machine, stop on level surface, turn off machine, and remove key.

2. Disconnect the negative battery cable from the battery.

 **WARNING: Always disconnect battery cables from machine before working on electrical components.**

INSTALLATION: 7400

NOTE: Discard the 35" extension cable included with this kit. This cable is only installed on 8400 machines.

1. Open the operator seat lift plate until the plate locks open.

2. Install the FaST water pump relay (2) onto the bracket. The relay will share a rivet with one of the existing relays. Refer to Fig. 1.

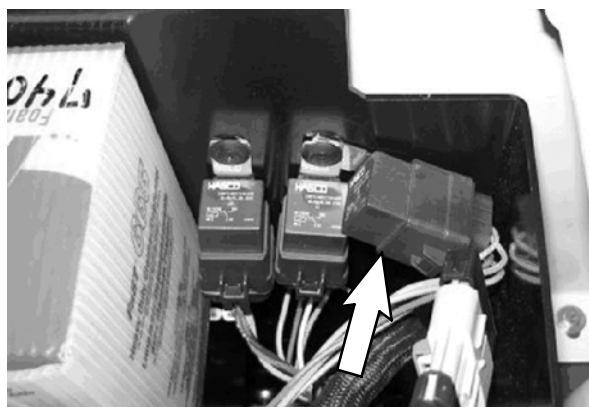

FIG. 1

3. Disconnect the existing FaST harness from the water pump.
4. Connect connector (B) of the FaST update harness (1) to the water pump and connector (A) of the FaST update harness to the FaST harness connector that was previously attached to the water pump. Refer to Fig. 8 and Fig. 9.
5. Connect connector (C) of the FaST update harness (1) to the relay (2) installed in Step 2. Refer to Fig. 1 and Fig. 8.

6. Connect connector (D) of the FaST update harness (1) to the unused recovery tank float connector 65A/GRY on the main wire harness. Refer to Fig. 7 and Fig. 8.
7. Connect connector (E) of the FaST update harness (1) to the unused auto fill connector on the main wire harness. Refer to Fig. 7 and Fig. 8.
8. Reconnect the negative battery cable to the battery and test the FaST system to ensure it operates properly. If FaST system still is not functioning properly, the low level valve will need to be replaced. Proceed to Step 9 and complete remaining instructions.
9. Disconnect the negative battery cable from the battery.
10. Disconnect the fittings from the existing low level valve. Refer to Fig. 2.

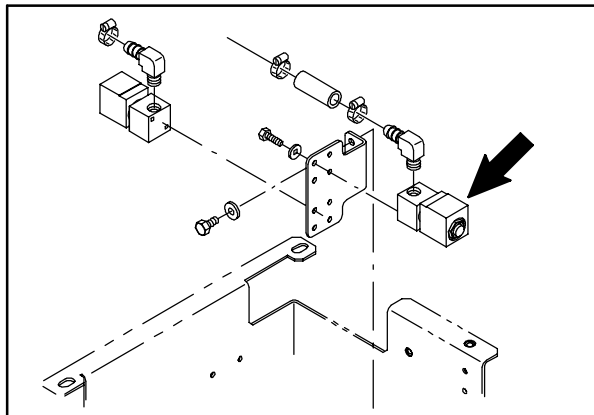

FIG. 2

11. Disconnect the low level valve wires and remove the low level valve from the bracket. Set hardware aside. Discard the low level valve.
12. Use set aside hardware to install the new low level valve (4) onto the machine. Reconnect all wires and fittings.
13. Reconnect the negative battery cable to the battery and test the FaST system to ensure it operates properly.

INSTALLATION: 8410

1. Open the operator seat lift plate until the plate locks open.
2. Remove the cover from the FaST assembly. Set the cover and hardware aside. Refer to Fig. 3.

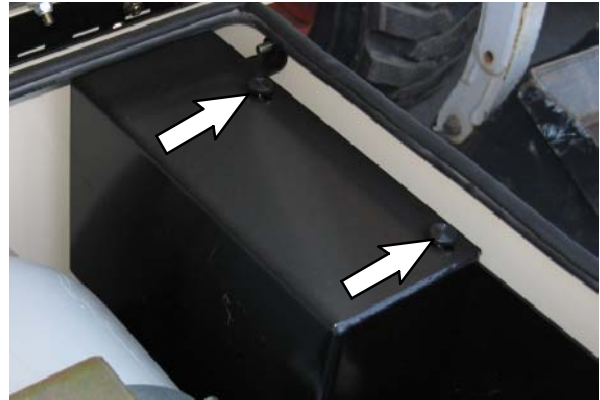

FIG. 3

3. Install the FaST water pump relay (2) onto the bracket. The relay will share a rivet with one of the existing relays. Refer to Fig. 4.

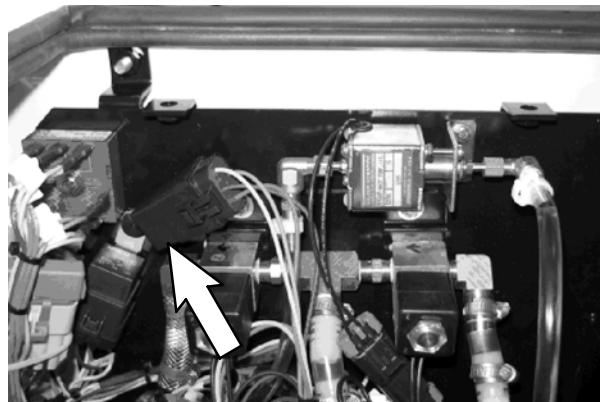

FIG. 4

4. Connect connector (G) of the 35" harness extension cable to connector (E) of the FaST update harness (1) and connect connectors (D) and (F) of the FaST update harness (1) together. Refer to Fig. 7 and Fig. 8.
5. Disconnect the existing FaST harness from the water pump.
6. Connect connector (B) of the FaST update harness (1) to the water pump and connector (A) of the FaST update harness to the FaST harness connector that was previously attached to the water pump. Refer to Fig. 8 and Fig. 9.

7. Connect connector (C) of the FaST update harness to the relay (2) installed in Step 2. Refer to Fig. 4 and Fig. 8.
8. Route the FaST extension jumper along the main wire harness, to the front of the engine compartment, and connect connector (H) of the FaST extension cable to unused auto fill valve (SV-24) connection on the main wire harness. Refer to Fig. 5, Fig. 7, and Fig. 8.



FIG. 5

9. Remove the large metal panel on the right side of the solution tanks from the machine to access the recovery tank float switch wires. Set the panel and hardware aside.
10. Use the jumper (3) to connect unused recovery tank float switch wires 11 GRN and 65 ORA together. Refer to Fig. 7.
11. Reconnect the negative battery cable to the battery and test the FaST system to ensure it operates properly. If FaST system still is not functioning properly, the low level valve will need to be replaced. Proceed to Step 9 and complete remaining instructions.

12. Disconnect the negative battery cable from the battery.
13. Disconnect the fittings from the existing low level valve. Refer to Fig. 6.

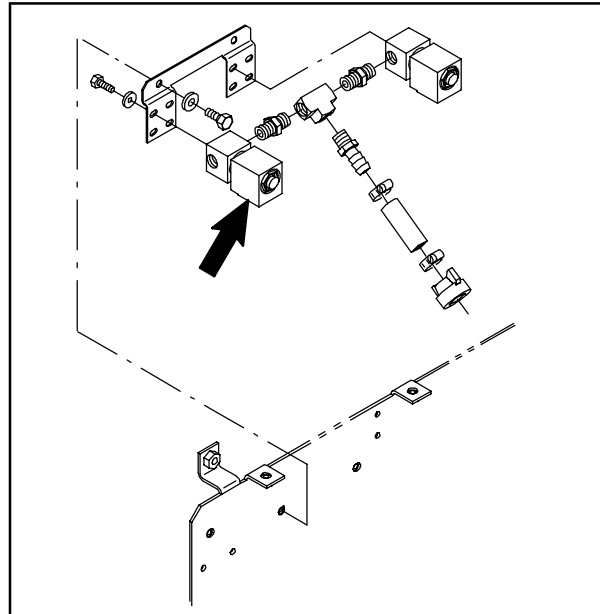

FIG. 6

14. Disconnect the low level valve wires and remove the low level valve from the bracket. Set hardware aside. Discard the low level valve. Refer to Fig. 6.
15. Use set aside hardware to install the new low level valve (4) onto the machine. Reconnect all wires and fittings. Refer to Fig. 6.
16. Reconnect the negative battery cable to the battery and test the FaST system to ensure it operates properly.

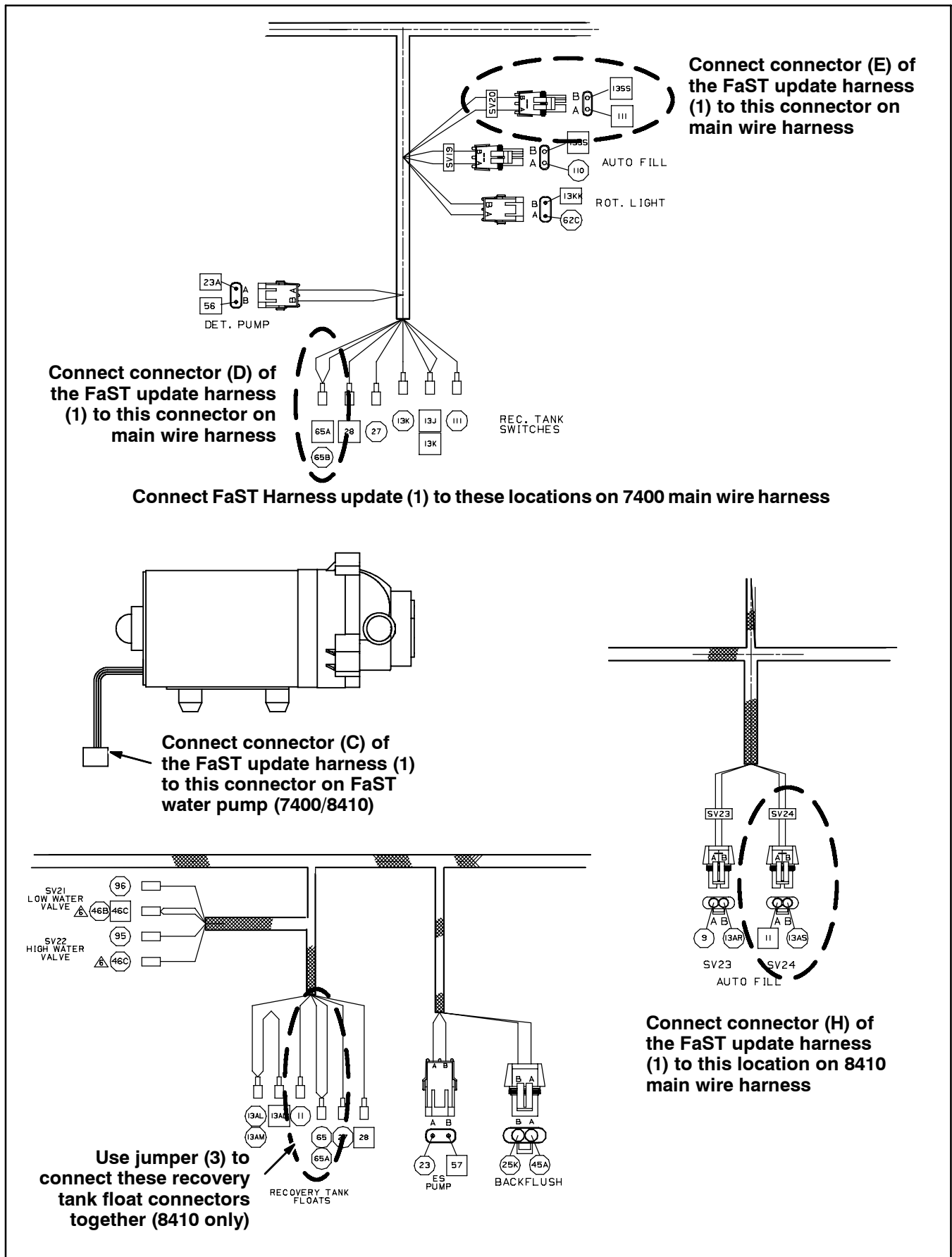

FIG. 7

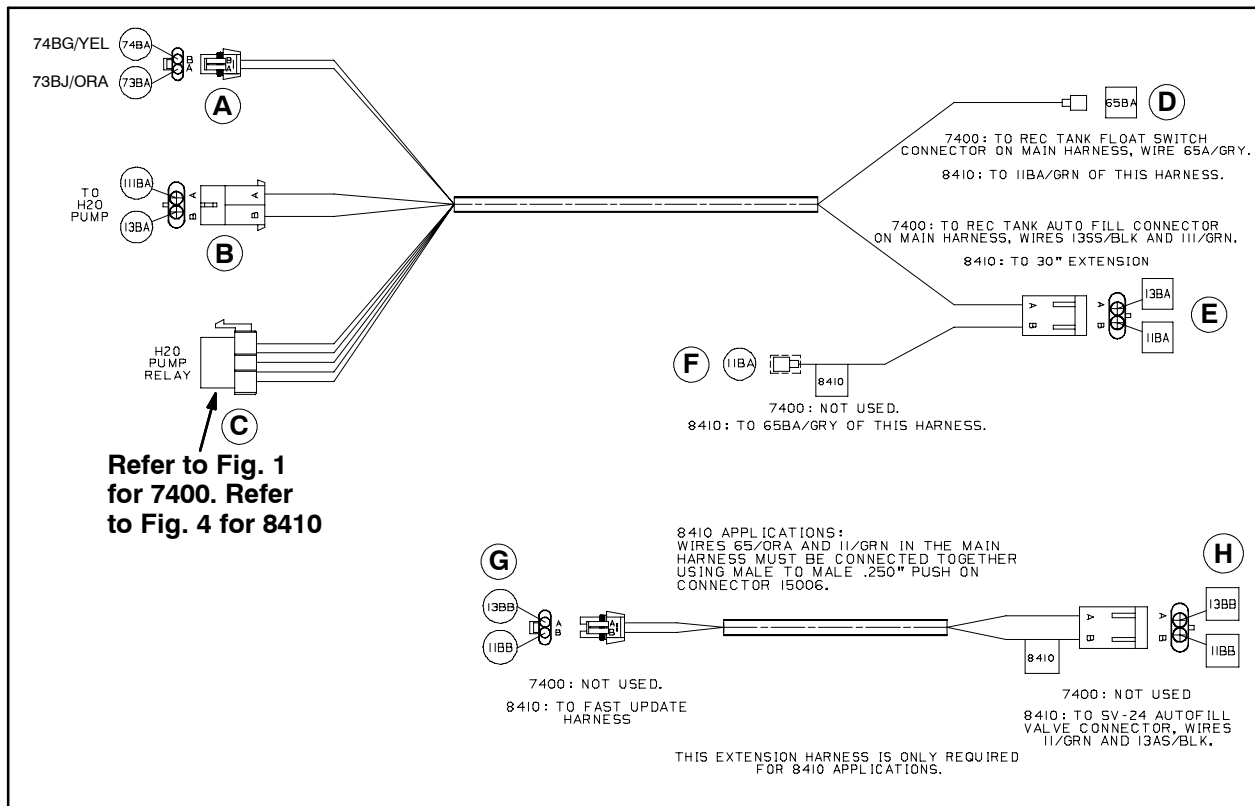

FIG. 8

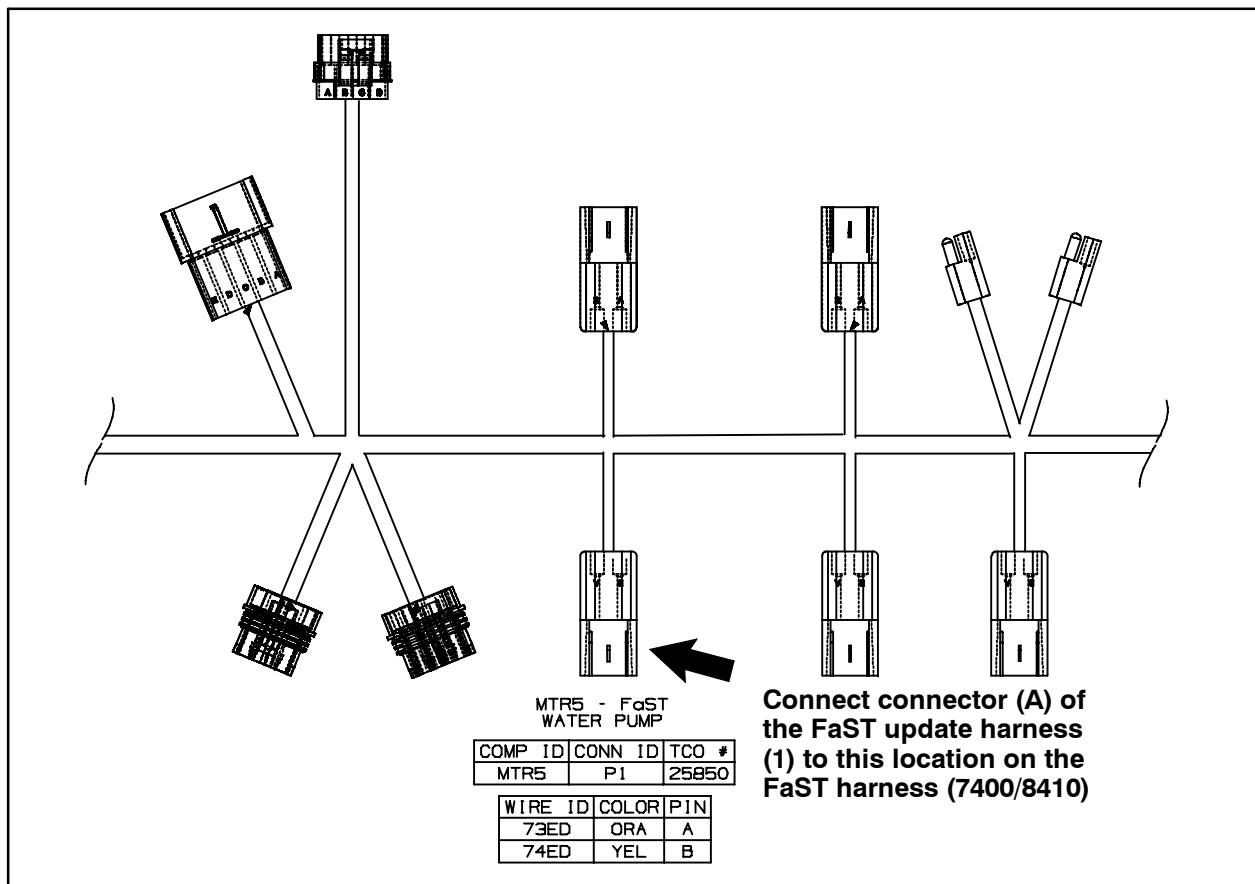

FIG. 9

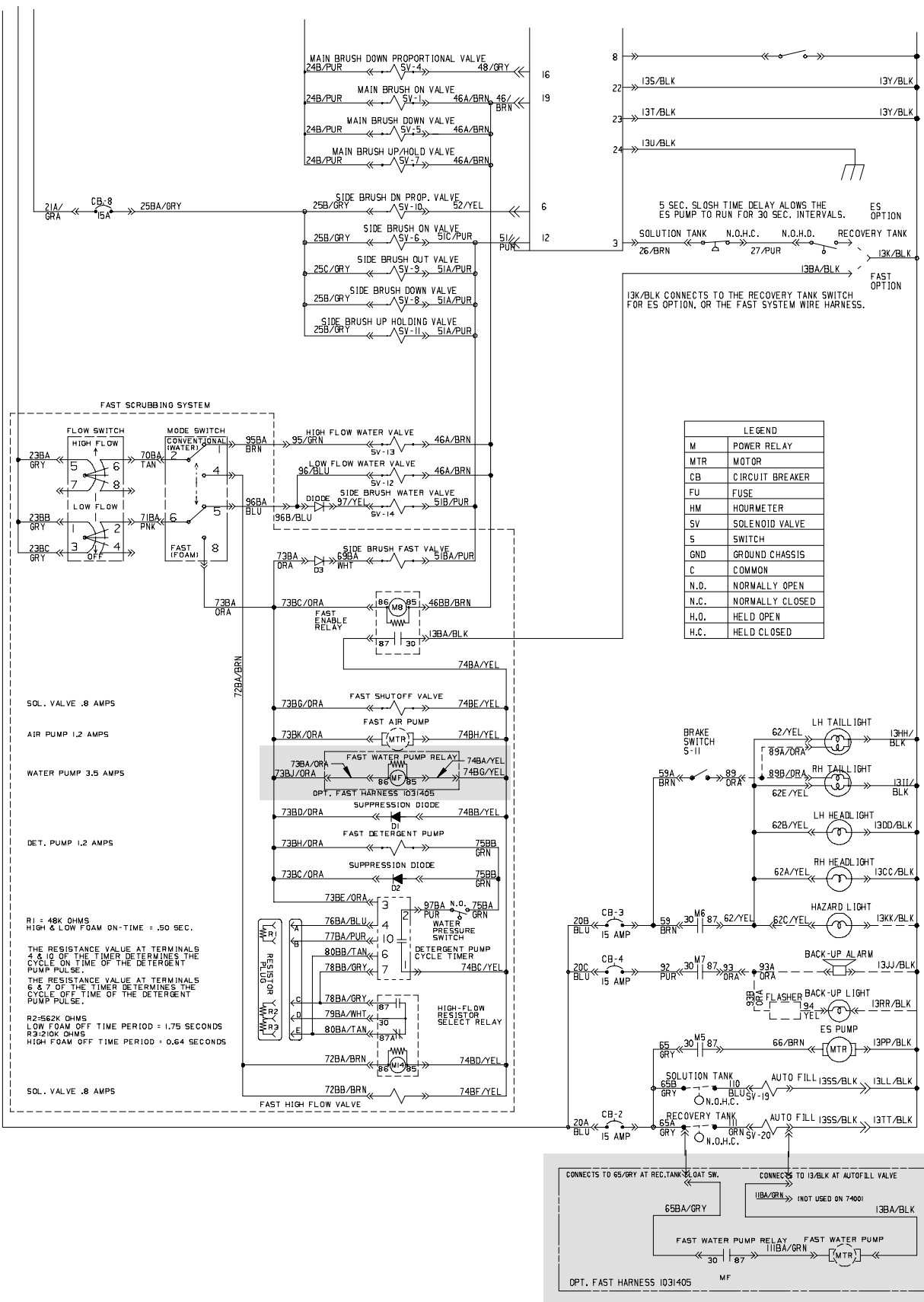

FIG. 10 - 7400 FaST System Schematic

Bill of Materials for Kit, Mod, FaST Voltage 7400/8410-9002632

	Ref.	Tennant Part No.	Description	Qty.
▽		9002632	Kit, Mod, FaST Voltage 7400/8410	1
▲	1	1031405	Harness [7400/8410 FaST Update]	1
▲	2	56186	Relay, 12VDC, 40A, SPDT N/O	1
▲	3	15006	Terminal, Butt, Mal, .25 22-10GA [Faston]	1
▲	4	1018098	Valve, Water, 12VDC, 6.0MM, 0.4PF	1

TENNANT COMPANY
P. O. Box 1452
Minneapolis, MN 55440-1452