



# INSTRUCTION BULLETIN

No. 340546  
Machine: EZ Rider HP  
7080  
Published: 1-2006  
Rev. 01

**NOTE: DO NOT DISCARD the Parts List from the Instruction Bulletin. Place the Parts List in the appropriate place in the machine manual for future reference. Retaining the Parts List will make it easier to reorder individual parts and will save the cost of ordering an entire kit.**

*NOTE: Numbers in parenthesis ( ) are reference numbers for parts listed in Bill of Materials.*

Installation instructions for **kit number 393042, 393044, 393048, and 393049**

## SYNOPSIS:

This kit contains the parts needed to install an alarm kit on EZ Rider HP and 7080 machines.  
Please follow step-by-step instructions.

## SPECIAL TOOLS / CONSIDERATIONS: NONE

(Estimated time to complete: 1 hour)

## PREPARATION:

1. Park the machine on a clean level surface, turn off the machine, set the parking brake, and remove the key.

**FOR SAFETY: Before leaving or servicing machine, stop on level surface, turn off machine, and remove key.**

2. Disconnect the battery cables from the batteries.



**WARNING: Always disconnect battery cables from machine before working on electrical components.**

## INSTALLATION: Backup Alarm Kit

1. Open the rear tank cover. Remove the rear cover from the hinge. Set the mounting hardware aside. Refer to Fig. 1.



**FIG. 1**

2. Place the tank cover upside down on a clean work surface with the hinge mounting locations on the far side of the tank cover. Refer to Fig. 8.
3. Drill a 11 mm (7/16") hole in the center of the left side indent, all the way through the tank cover. Refer to Fig. 8.

4. Drill a 4 mm (5/32") hole on the inside of the hinge mounting lip. Refer to Fig. 8.
5. Place the tank cover top side up on the work surface, with the hinge mounting locations on the far side.
6. Use the hole locations shown in Fig 8 and the mounting bracket as a template, mark and drill four 12.7 mm (1/2") holes in the top of the tank cover. **DRILL THE HOLES THROUGH THE TOP LAYER OF THE TANK COVER ONLY.** Refer to Fig. 8.
7. Mount the reworked tank cover back on the tank cover hinge with the set aside mounting hardware.
8. Route the main wire harness through the cable clamp (12). Secure the cable clamp to the new hole in the hinge mounting lip with pan screw (12). Refer to Fig. 2 and Fig. 9.

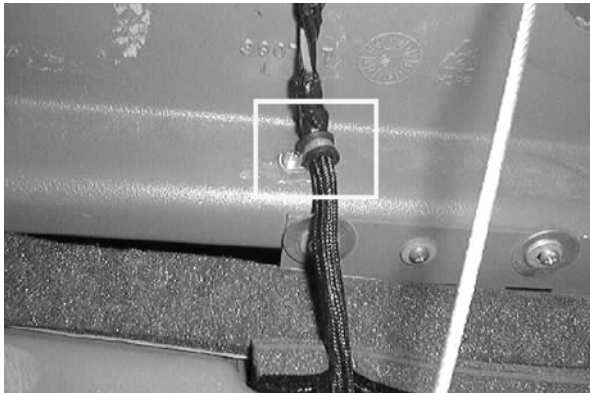

**FIG. 2**

9. Route the main wire harness up through the (7/16") hole in the tank cover. Refer to Fig. 3.

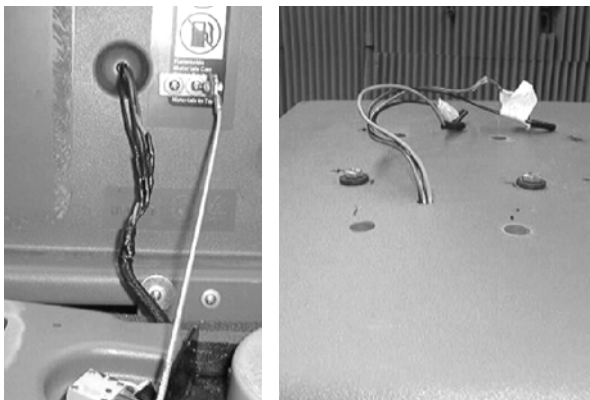

**FIG. 3**

10. Mount the alarm to the bracket using the hex screw (7), washer (8) and lock nut (9) in the right side mounting location. Refer to Fig. 4 and Fig. 9.



**FIG. 4**

11. Place the alarm assembly in mounting position on top of the tank cover. Route the main harness through the cable clamp (5). Connect the main harness to the backup alarm harness. Refer to Fig. 9 and Fig. 18.
12. Secure the cable clamp (5) and the alarm (6) to the bracket (1) using the hex screw (7), washer (8) and lock nut (9). Band the excess wire harness with a plastic wire tie (10). Refer to Fig. 5 and Fig. 9.

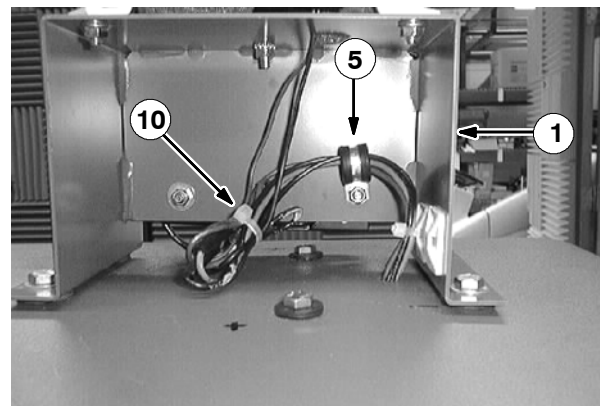

**FIG. 5**

13. Insert four isolator nuts (4) in the four holes drilled in the top of the tank cover. Mount the alarm bracket (1) to the tank cover with hex screws (2) and washers (3). Refer to Fig. 6 and Fig. 9.

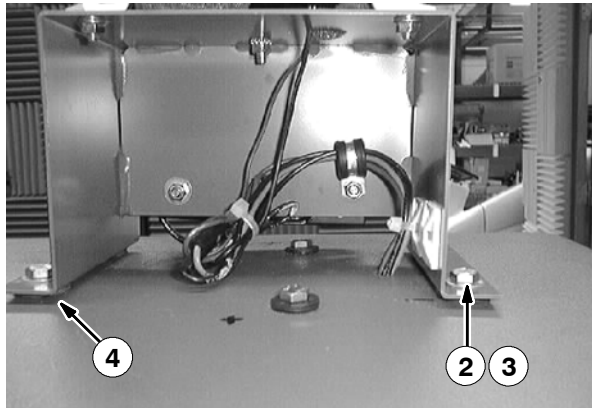
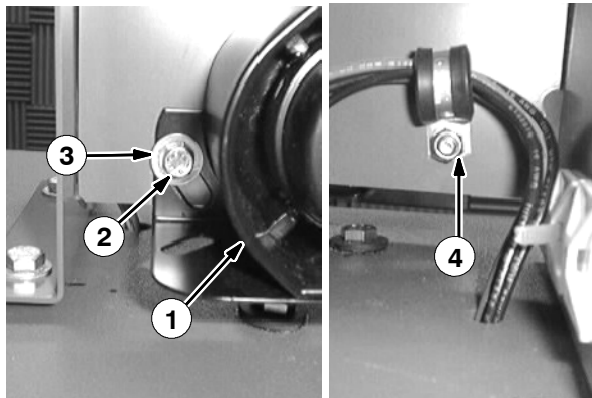

**FIG. 6**

14. Reconnect the battery cables to the batteries.
15. Start the machine and test the alarm.

**INSTALLATION: Backup Alarm Kit (without Bracket Installation)**

1. Mount the backup alarm (1) to the the mounting bracket with hex screws (2), washers (3) and lock nuts (4). Refer to Fig. 7 and Fig. 10.



**FIG. 7**

2. Reconnect the battery cables to the batteries.
3. Start the machine and test the alarm.

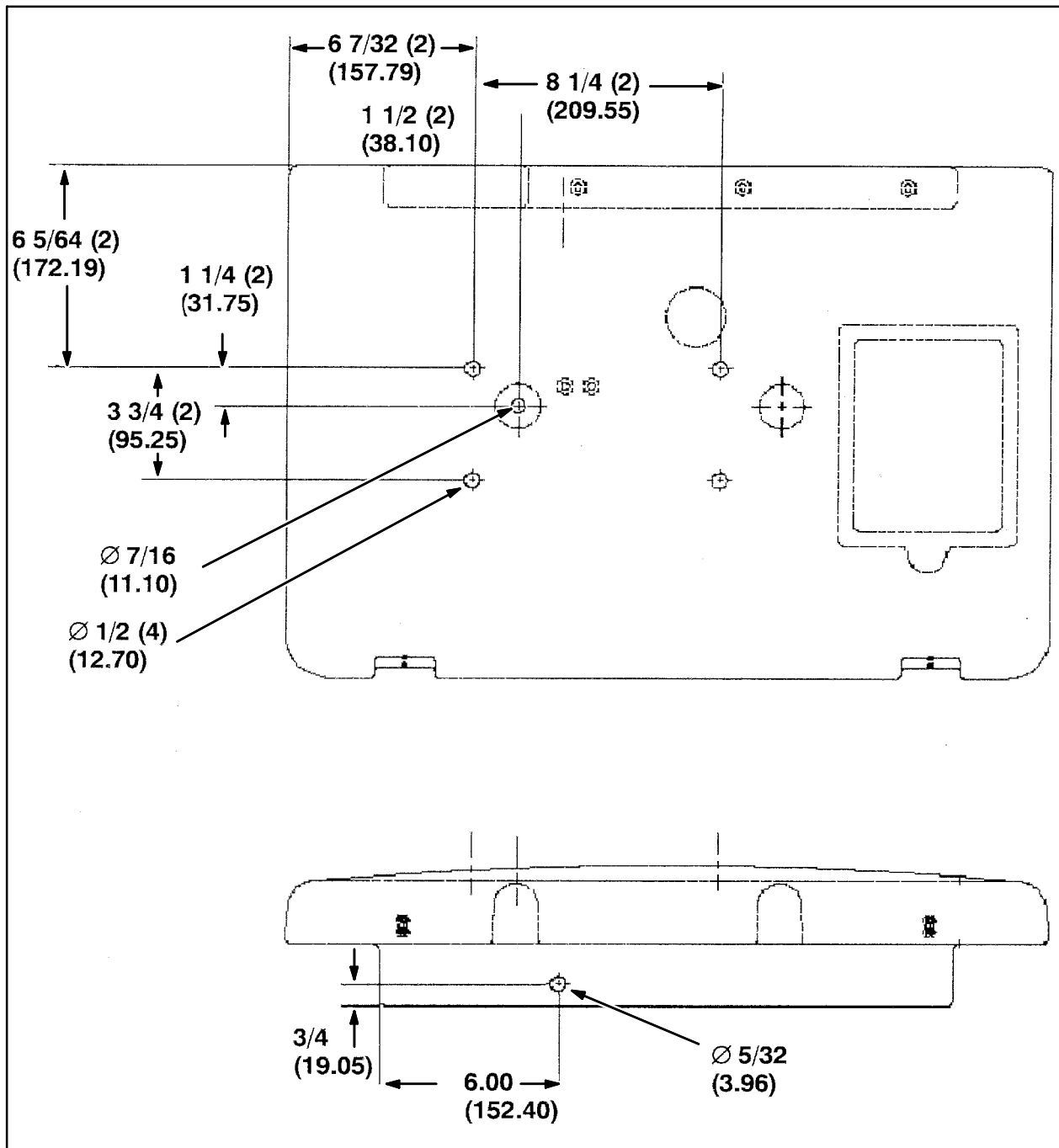

FIG. 8

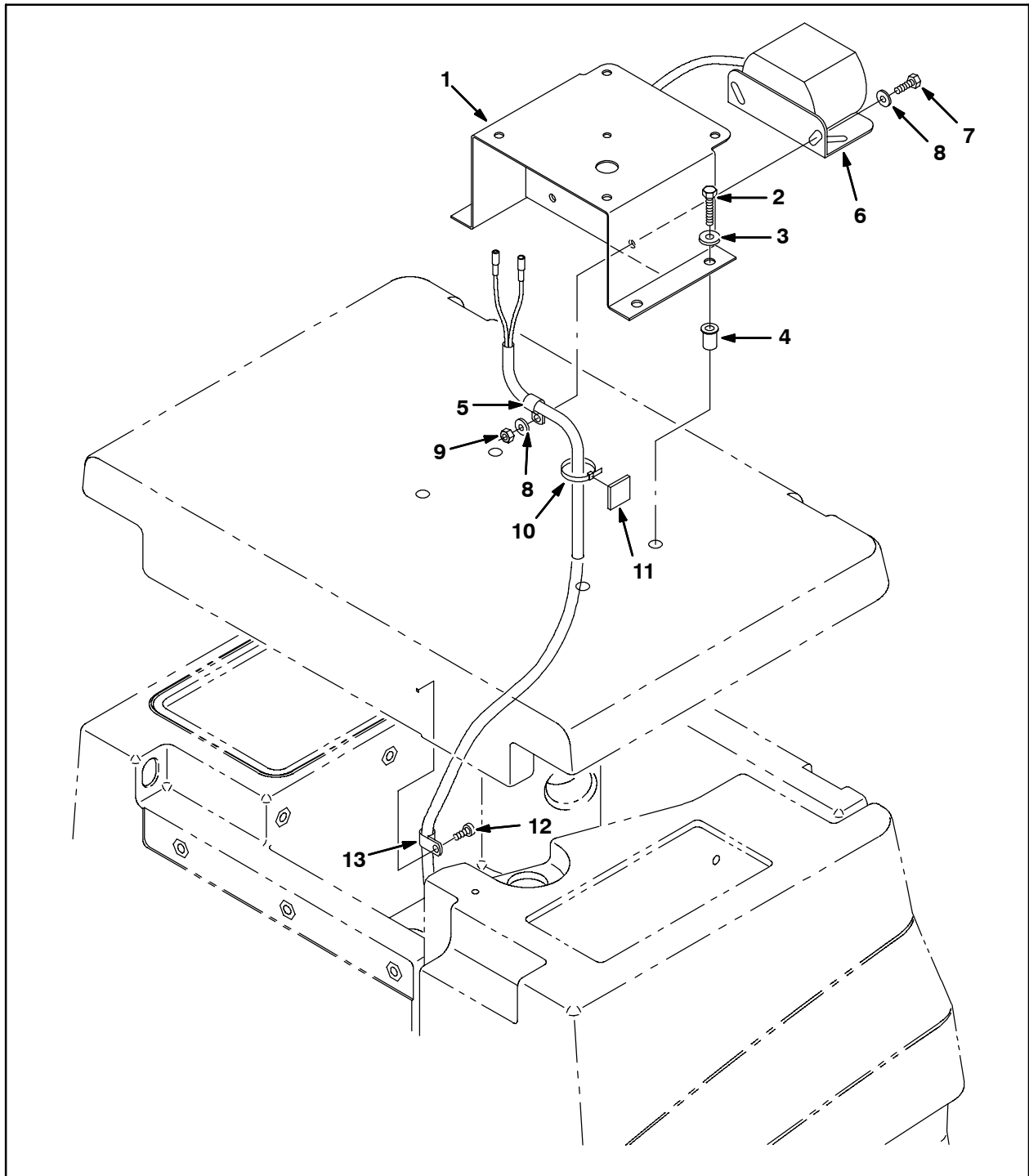
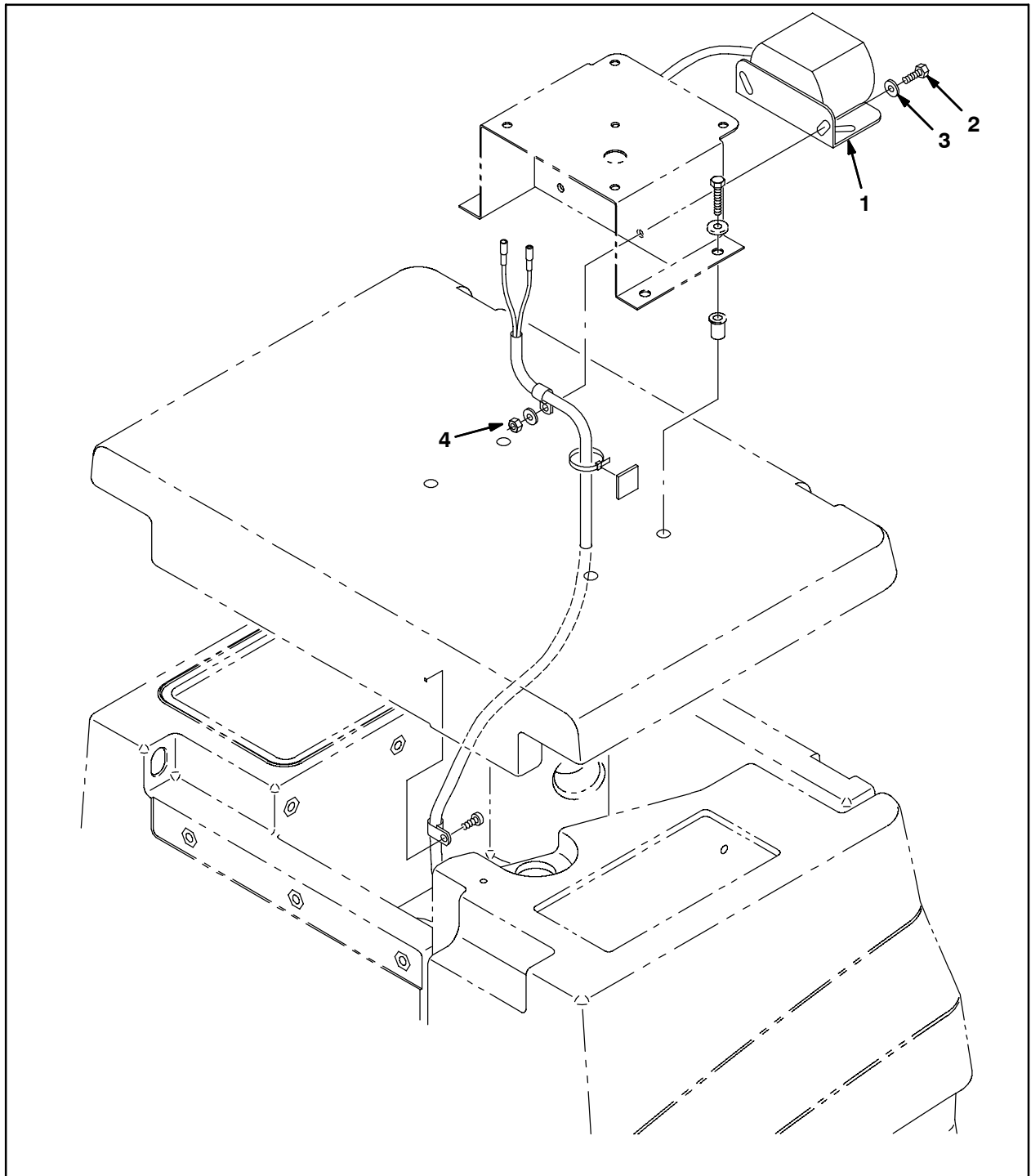

FIG. 9



**FIG. 10**

## INSTALLATION: Flash/Strobe Light Kits

1. Open the rear tank cover. Remove the rear cover from the hinge. Set the mounting hardware aside. Refer to Fig. 11.



FIG. 11

2. Place the tank cover upside down on a clean work surface with the hinge mounting locations on the far side of the tank cover. Refer to Fig. 8.
3. Drill a 11 mm (7/16") hole in the center of the left side indent, all the way through the tank cover. Refer to Fig. 8.
4. Drill a 4 mm (5/32") hole on the inside of the hinge mounting lip. Refer to Fig. 8.
5. Place the tank cover top side up on the work surface, with the hinge mounting locations on the far side.
6. Use the hole locations shown in Fig 8 and the mounting bracket as a template, mark and drill four 12.7 mm (1/2") holes in the top of the tank cover. DRILL THE HOLES THROUGH THE TOP LAYER OF THE TANK COVER ONLY. Refer to Fig. 8.
7. Reinstall the tank cover onto the tank cover hinge with the set aside mounting hardware.

8. Route the main wire harness through the cable clamp (12). Secure the cable clamp to the new hole in the hinge mounting lip with pan screw (12). Refer to Fig. 12 and Fig. 19.

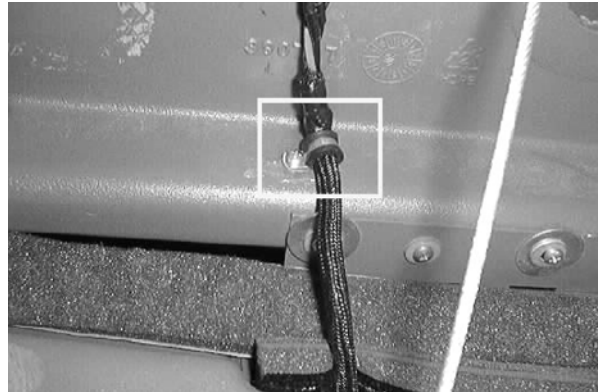

FIG. 12

9. Route the main wire harness up through the (7/16") hole in the tank cover. Refer to Fig. 13.

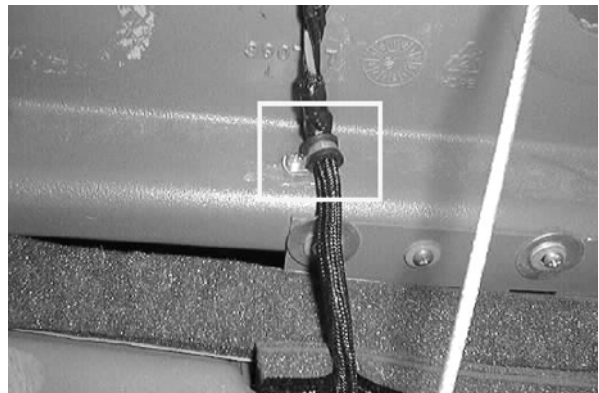

FIG. 13

10. Route the main wire harness up through the (7/16") hole in the tank cover. Refer to Fig. 14.

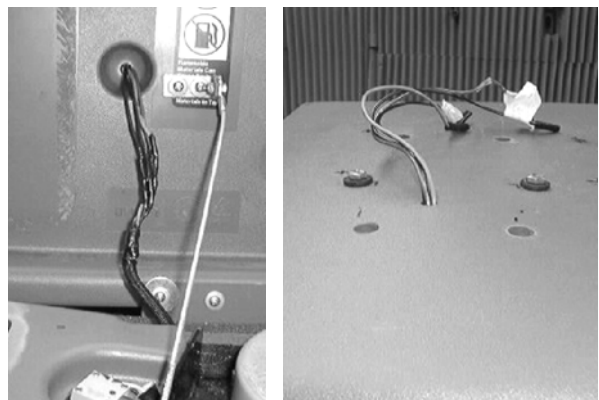
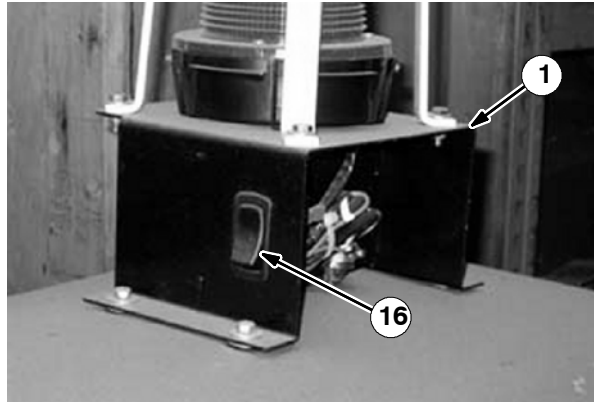

FIG. 14

11. Use hardware included with light (9) to mount the light to the bracket (1). Refer to Fig. 19.

12. Insert the switch (16) into the bracket (1).  
Refer to Fig. 15



**FIG. 15**

13. Place the bracket (1) onto the tank cover.  
Route the main harness through the cable clamp (5) and connect the main harness to the light harness and switch (16). Refer to Fig. 16 and Fig. 18.

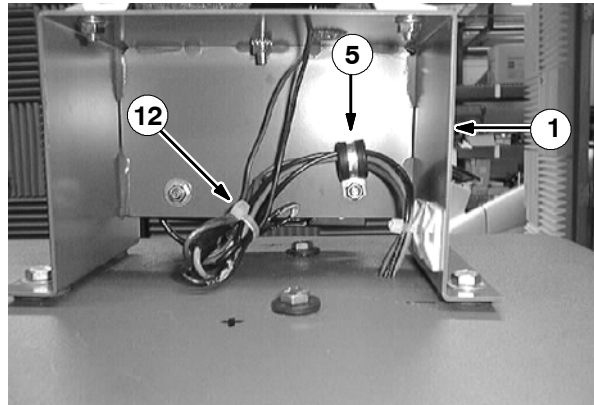

**FIG. 16**

14. Secure the cable clamp (5) to the bracket (1) using the hex screw (6), washer (7), and lock nut (8). Band the excess wire harness with a wire tie (12). Refer to Fig. 16 and Fig. 19.

15. Insert four isolator nuts (4) in the four holes drilled in the top of the tank cover. Mount the alarm bracket (1) to the tank cover with hex screws (2) and washers (3). Refer to Fig. 17 and Fig. 19.

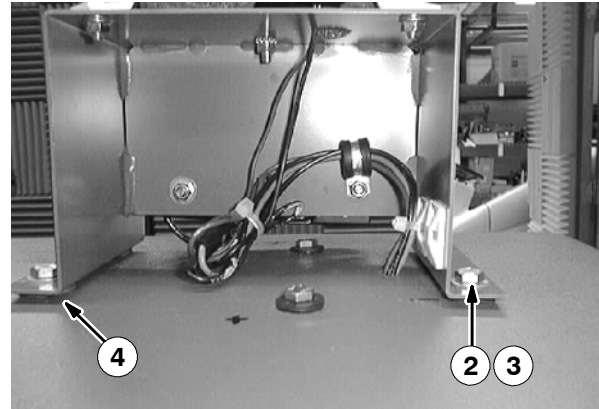
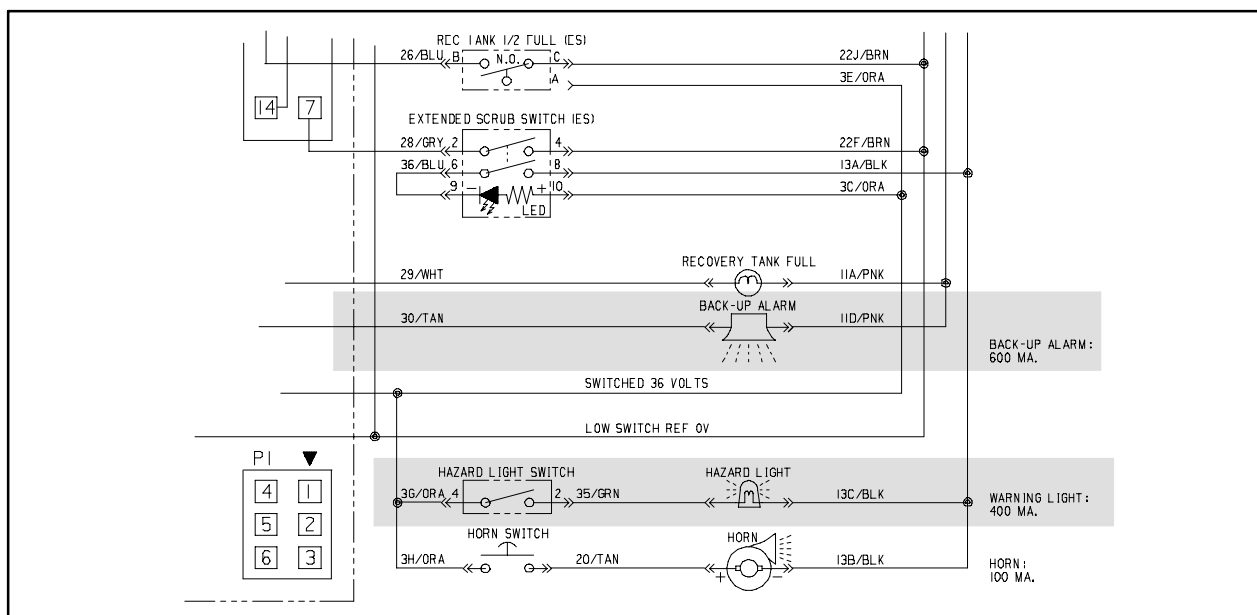

**FIG. 17**

16. Use four hex screws (6), eight flat washers (7), and four hex nuts (8) to install the light guard (11) onto the bracket (1). Refer to Fig. 19.

17. Reconnect the battery cables to the batteries.

18. Start the machine and test the alarm.



**FIG. 18**



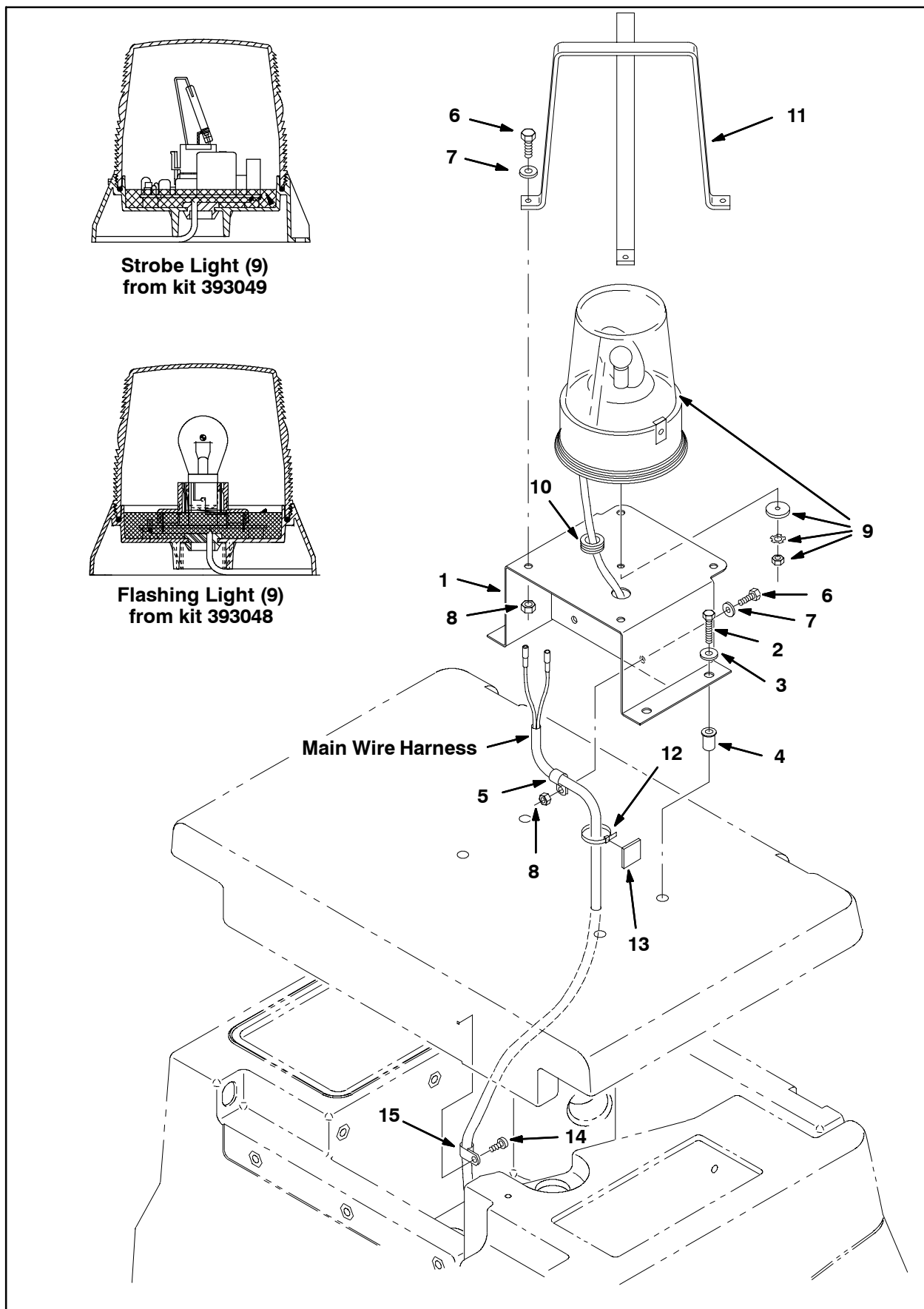

**Bill of Materials for Alarm Kit, Backup, W/Bracket, CI-393042**

Ref.	Tennant Part No.	Description	Qty.
▽	393042	Alarm Kit, Backup, W/Bracket, CI	1
▲	1 392962	Bracket Wldt, Light / Alarm	1
▲	2 16951	Screw, Hex, .25-20 X 1.25, Sems	4
▲	3 32491	Washer, Flat, 0.31 Std	4
▲	4 397644	Nut, Isolator, .25-20 Wall .187-.343	4
▲	5 26395-1	Clamp, Cable, Stl, 0.56D X 0.38W, 1H	1
▲	6 369349	Alarm, Assy, Backup, 12-48VDC 82-102DBA	1
▲	7 06943	Screw, Hex, M6 X 1.0 X 20, 8.8	1
▲	8 32483	Washer, Flat, 0.25 SAE	2
▲	9 08708	Nut, Hex, Lock, M6 X 1.0, NL	1
▲	10 49263	Tie, Cable, Nyl, 11.4L .19W 3.0 Max D	2
▲	11 55248	Mount, Cable Tie	1
▲	12 360973	Screw, Pan, #12-16 X 0.50, F/Plstc	1
▲	13 26395-2	Clamp, Cable, Stl, 0.38D X 0.38W, 1H	1

**Bill of Materials for Alarm Kit, Backup, W/O Bracket, CI-393044**

Ref.	Tennant Part No.	Description	Qty.
▽	393044	Alarm Kit, Backup, W/O Bracket, CI	1
▲	1 369349	Alarm, Assy, Backup, 12-48VDC 82-102DBA	1
▲	2 06943	Screw, Hex, M6 X 1.0 X 20, 8.8	1
▲	3 32483	Washer, Flat, 0.25 SAE	2
▲	4 08708	Nut, Hex, Lock, M6 X 1.0, NL	1

**Bill of Materials for Kit, CI, Light, Flsh [EZHP/7080]-393048**

**Bill of Materials for Kit, CI, Light, Flsh [EZHP/7080]-393049**

Ref.	Tennant Part No.	Description	Qty.
▽	393048	Kit, CI, Light, Flsh [EZHP/7080]	1
▲	1 392962	Bracket Wldt, Light / Alarm	1
▲	2 16951	Screw, Hex, .25-20 X 1.25, Sems	4
▲	3 32491	Washer, Flat, 0.31 Std	4
▲	4 397644	Nut, Isolator, .25-20 Wall .187-.343	4
▲	5 26395-1	Clamp, Cable, Stl, 0.56D X 0.38W, 1H	1
▲	6 06943	Screw, Hex, M6 X 1.0 X 20, 8.8	5
▲	7 32483	Washer, Flat, 0.25 SAE	10
▲	8 08708	Nut, Hex, Lock, M6 X 1.0, NL	5
▲	9 1017248	Light, Flsh, Amb, 12-48 VDC-Kit 393048 Only	1
▲	9 1017250	Lamp, Strobe, Amb, 12-80 VDC-Kit 393049 Only	1
▲	10 10632-2	Grommet, Rbr, 0.62ID, F/0.9H, .12Matl	1
▲	11 45272	Guard Wldt, Light, Revl/Flsh	1
▲	12 49263	Tie, Cable, Nyl, 11.4L .19W 3.0 Max D	2
▲	13 55248	Mount, Cable Tie	1
▲	14 360973	Screw, Pan, #12-16 X 0.50, F/Plstc	1
▲	15 26395-2	Clamp, Cable, Stl, 0.38D X 0.38W, 1H	1
▲	16 397889	Switch, Rocker, 36VDC 05A DPST On/N/On	1

TENNANT COMPANY  
P. O. Box 1452  
Minneapolis, MN 55440-1452