



INSTRUCTION BULLETIN

No. 340540
Machine: 6500, 6550
Published: 7-02
Rev. 00

NOTE: DO NOT DISCARD the Parts List from the Instruction Bulletin. Place the Parts List in the appropriate place in your machine manual for future reference. Retaining the Parts List will make it easier to reorder individual parts and will save you the cost of ordering an entire kit.

NOTE: Numbers in parenthesis () are reference numbers for parts listed in Bill of Materials.

Installation instructions for rear door replacement **kit number 383264**

DESCRIPTION:

This kit contains the parts needed to replace the left hand rear door on the model 6500/6550 sweepers.

Please follow step-by-step instructions.

SPECIAL TOOLS / CONSIDERATIONS: NONE

(Estimated time to complete: 1 hour)

PREPARATION:

(Refer to FIG. 1)

1. Park machine on a clean, level surface. Turn off the machine.

FOR SAFETY: Before leaving or servicing machine, stop on level surface and set parking brake. Then turn off machine and remove key.

INSTALLATION:

(Refer to FIG. 1)

1. Locate and open the rear door on the left hand side of the machine.
2. Remove the hydraulic cooler assembly from the rear door, and set out of the way. Set the mounting hardware aside.
3. Remove the door latch 59695 from the latch mounting bracket 70252. Set the door latch and mounting hardware aside.
4. Disconnect and remove the rear door from the machine. Set the mounting hardware aside.
5. Loosely mount the set aside door latch 59695 to the new latch bracket (2) with the set aside hardware.
6. Mount the new latch bracket (2) to the new grill door (1) with M8 hex screws (3) and washers (4).
7. Mount the new grill door (1) to the machine with set aside mounting hardware. Check for an even gap along the bottom of the door, and check that it closes easily. Torque the mounting hardware to 70–80 Nm (50–60 ft lbs).
8. Mount the hydraulic cooler assembly on the new rear door (1) with the set aside hardware.
9. Check the new door latch for proper operation.

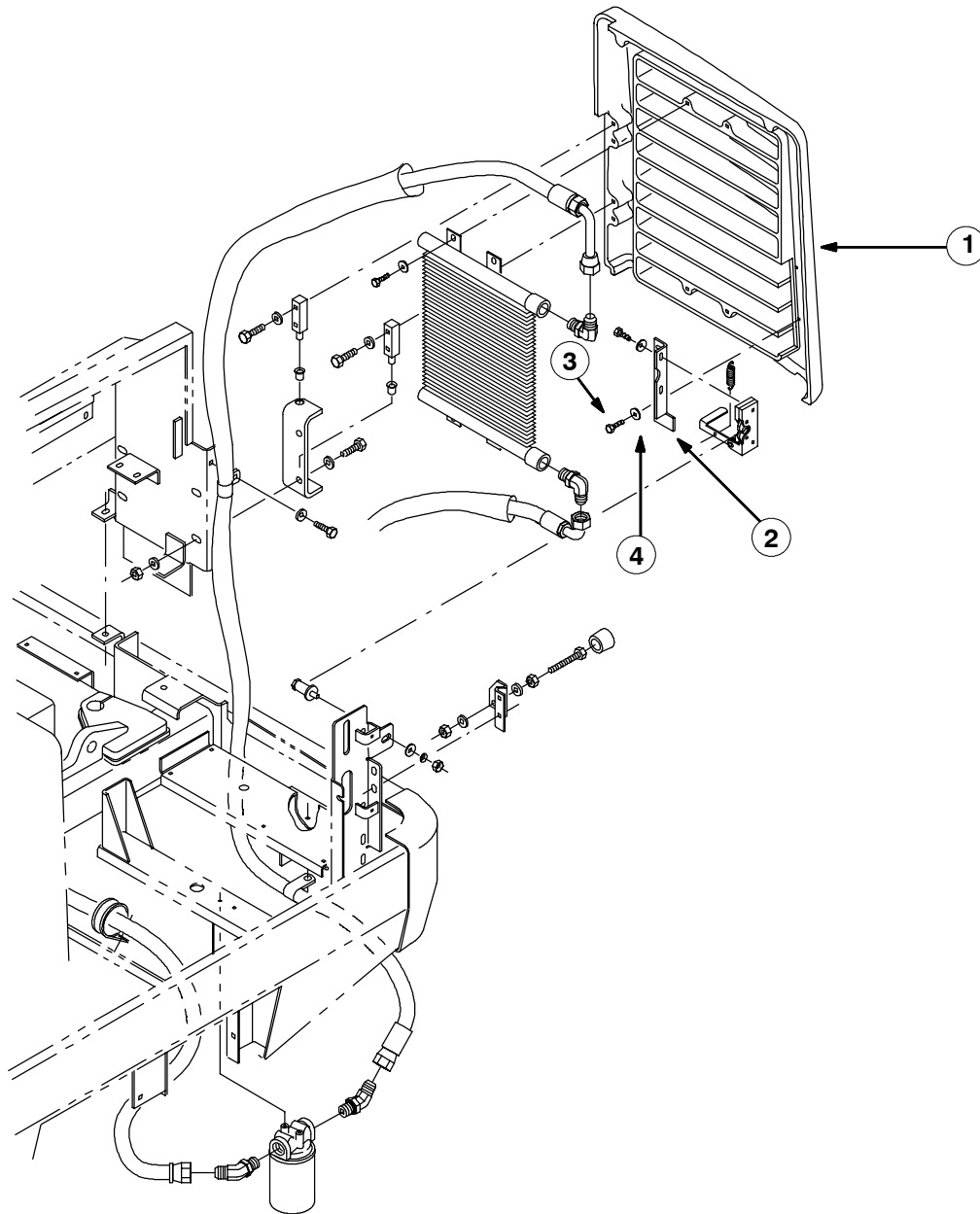

FIG. 1 - Rear LH Grille Door Installation

BILL OF MATERIALS FOR REAR LEFT HAND DOOR KIT 383264

Ref.	TENNANT Part No.	Description	Qty.
1	379565	Grill, door, LH	1
2	70252	Bracket, latch, grill, LPG	1
3	16931	Screw, hex, M08 X 1.25 X 20, 8.8	2
4	32491	Washer, flat, 0.31 std	2

TENNANT COMPANY
P. O. Box 1452
Minneapolis, MN 55440-1452