



INSTRUCTION BULLETIN

No. 340530
Machine: 7200 SEPEX
Published: 06-2007
Rev. 01

NOTE: DO NOT DISCARD the Parts List from the Instruction Bulletin. Place the Parts List in the appropriate place in the machine manual for future reference. Retaining the Parts List will make it easier to reorder individual parts and will save the cost of ordering an entire kit.

NOTE: Numbers in parenthesis () are reference numbers for parts listed in Bill of Materials.

Installation instructions for **kit number 393057**

DESCRIPTION:

This kit contains the parts needed to replace the controller on the model 7200 scrubber.
Please follow step-by-step instructions.

SPECIAL TOOLS / CONSIDERATIONS: None

(Estimated time to complete: 1 hour)

PREPARATION:

(Refer to FIG. 1)

1. Park the machine on a clean level surface, turn off the machine, remove the key, and set the parking brake.

FOR SAFETY: Before leaving or servicing machine, stop on level surface, turn off machine, set parking brake, and remove key.

2. Lift the operator seat to access the batteries.
The support arm automatically engages when the seat is lifted all the way up.
3. Disconnect the battery cables from the batteries.



WARNING: Always disconnect battery cables from machine before working on electrical components.

4. Un-plug the battery connector from in front of the solution tank.
5. Lower the seat support.
6. Remove the two screws at the top of the control panel mount plate.
7. Pivot the mount plate down until it is resting against the seat support.
8. Put the grounding strap (2) on by placing the exposed adhesive side firmly around your wrist. Attach the copper foil end to an exposed electrical ground or unpainted hardware.

9. Locate the circuit board cover on the inside, front wall of the steering support, behind the control panel.
10. Remove the six nuts holding the circuit board cover on the frame.
11. Pull the circuit board cover back to access the circuit board.
12. Un-plug the two ribbon cables from the circuit board.
13. Un-plug the three wire connectors from the circuit board.
14. Pop the circuit board off the six plastic stand-offs. Remove the circuit board from the machine. Note the orientation of the circuit board.
15. Position the new circuit board on the six plastic stand-offs. Gently push the board down until the stand-off snaps in place.
16. Reconnect the three wire connectors and two ribbon cables to the new circuit board. See schematic in this section.
17. Position the circuit board cover back up to the inside, front wall of the steering support, behind the control panel.
18. Reinstall the six nuts on the circuit board cover. Hand tighten lightly.

19. Pivot the control panel back in position. Reinstall the two screws and tighten to 18-24 Nm (15-20 ft lb).
20. Lift the operator seat and reconnect the battery connector at the front of the solution tank.
21. Start the machine and initialize the new board (1).
22. Operate the machine and check for proper operation.

TO INITIALIZE NEW BOARD

1. Turn the key to the "ON" position.
2. Push and hold the brush "DOWN PRESSURE" button until desired down pressure setting is indicated.
3. Initialization is complete.

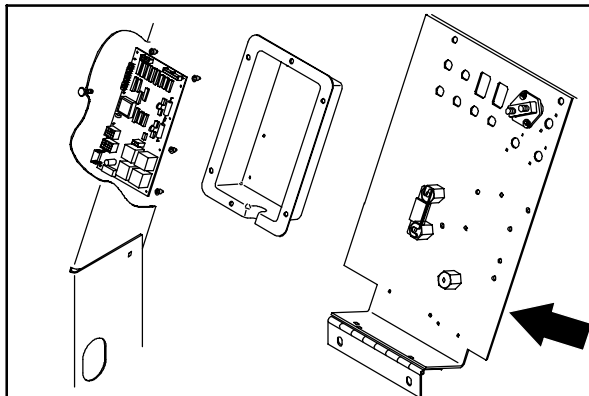
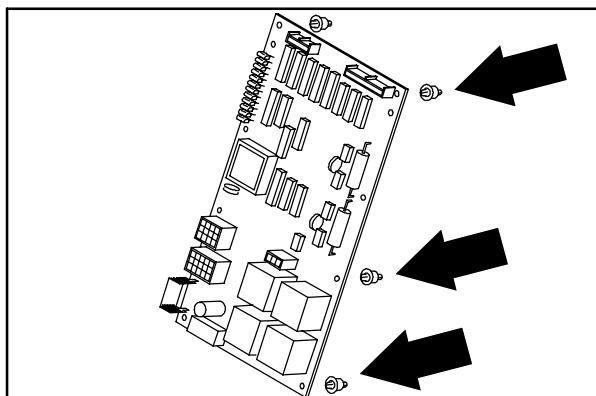
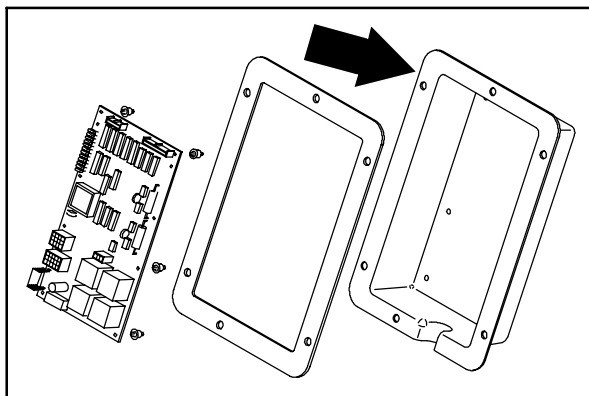
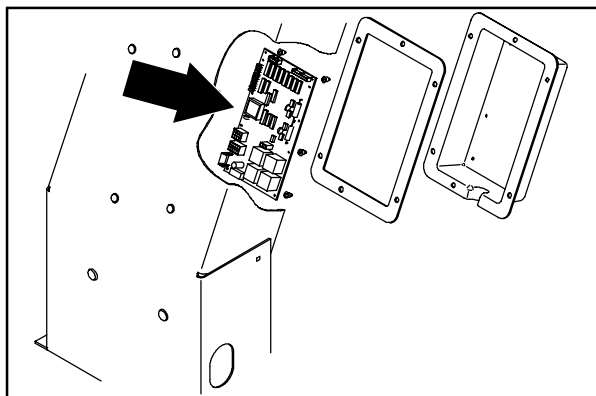

FIG. 1 - Control Board

BILL OF MATERIALS FOR CONTROLLER REPLACEMENT KIT 393057

Ref.	TENNANT Part No.	Description	Qty.
1	1015148	Circuitboard Assy [7200 SEPEX]	1
2	27964	Strap, Ground, Static, Disposable	1

TENNANT COMPANY
P. O. Box 1452
Minneapolis, MN 55440-1452