



# INSTRUCTION BULLETIN

No. 340507  
Machine: 6500  
Published: 10-01/00  
System: SCRUBBING

**NOTE: DO NOT DISCARD the Parts List from the Instruction Bulletin. Place the Parts List in the appropriate place in your machine manual for future reference. Retaining the Parts List will make it easier to reorder individual parts and will save you the cost of ordering an entire kit.**

*NOTE: Numbers in parenthesis ( ) are reference numbers for parts listed in Bill of Materials.*

Installation instructions for kit number 383225

## **SYNOPSIS / PROBLEM:**

This kit contains the parts needed to install pressure switch 34868 on the model 6500 sweeper/scrubber.

Please follow step-by-step instructions.

## **SPECIAL TOOLS / CONSIDERATIONS: NONE**

(Estimated time to complete: 1 hour)

## **PREPARATION:**

(Refer to FIG. 1 thru 6)

1. Turn the machine power on.
2. Raise the debris hopper, and engage the hopper support bar.



**WARNING: Raised hopper may fall. Engage hopper support bar.**



**WARNING: Lift arm pinch point. Stay clear of hopper lift arms.**

3. Turn the machine power off, and engage the parking brake.

**FOR SAFETY: Before leaving or servicing machine, stop on level surface and set parking brake. Then turn off machine and remove key.**

4. Disconnect battery cables from machine.



**WARNING: Always disconnect battery cables from machine before working on electrical components.**

## **NEW PRESSURE SWITCH INSTALLATION:**

(Refer to FIG. 1)

1. Open the top and side engine cover doors.
2. Check that the brass breather fitting (2) and rubber grommet (3) are installed in the new pressure switch (1). (Refer to FIG. 1)
3. Remove the cover off the pressure switch (1). Connect the new pressure switch (1) to the wire harness 38/PUR and 13H/BLK. (Refer to FIG. 3, 4 and 5)
4. Mount the new pressure switch (1) to the machine frame with two screws (7) and lock nuts (8). (Refer to FIG. 1 and 2)

5. Connect one end of the new vacuum hose (5) to the new pressure switch (1). Connect the other end of the new vacuum hose to the brass fitting in the debris hopper.  
(Refer to FIG. 1 and 2)

### NEW PANEL LIGHT INSTALLATION:

(Refer to FIG. 2 thru 6)

1. Remove and set aside the four plastic rivets holding the control panel to the machine frame. (Refer to FIG. 3)
2. Lift the face of the control panel high enough to access the indicator light panel, under the control panel. (Refer to FIG. 3)
3. Remove and set aside the two lock nuts and washers holding the indicator light panel to the bottom of the control panel. (Refer to FIG. 3)
4. Insert the clogged filter indicator light in the lower left hand corner of the indicator light panel. (Refer to FIG. 3)
5. Mount the indicator light panel to the bottom of the control panel with set aside washers and lock nuts. (Refer to FIG. 3)
6. Connect the new indicator light to the wire harness. (Refer to FIG. 4, 5 and 6)
7. Replace the control panel on the machine frame, and secure with four set aside plastic rivets. (Refer to FIG. 1 and 2)
8. Reconnect the battery cables to the machine.
9. Raise the debris hopper, disengage the hopper support bar and lower the debris hopper.



**WARNING: Lift arm pinch point. Stay clear of hopper lift arms.**

10. Close the side and top engine cover doors.

### BILL OF MATERIALS FOR PRESSURE SWITCH KIT, 383225

Ref.	TENNANT Part No.	Description	Qty.
1	34868	Switch, pressure, 12V	1
2	82739	Fitting, brs, breather, 02MP	1
3	10632-4	Grommet, rbr, 0.62ID, F/0.9H, 0.06matl	1
4	40607	Fitting, brs, str, PM02/BM03	2
5	379719	Hose, vacuum, 0.16ID 60.0L	1
6	361075	Light, panl, 14VDC	1
7	09206	Screw, M04 X 0.7 X 18	2
8	02850	Nut, lock, hex, M04	2

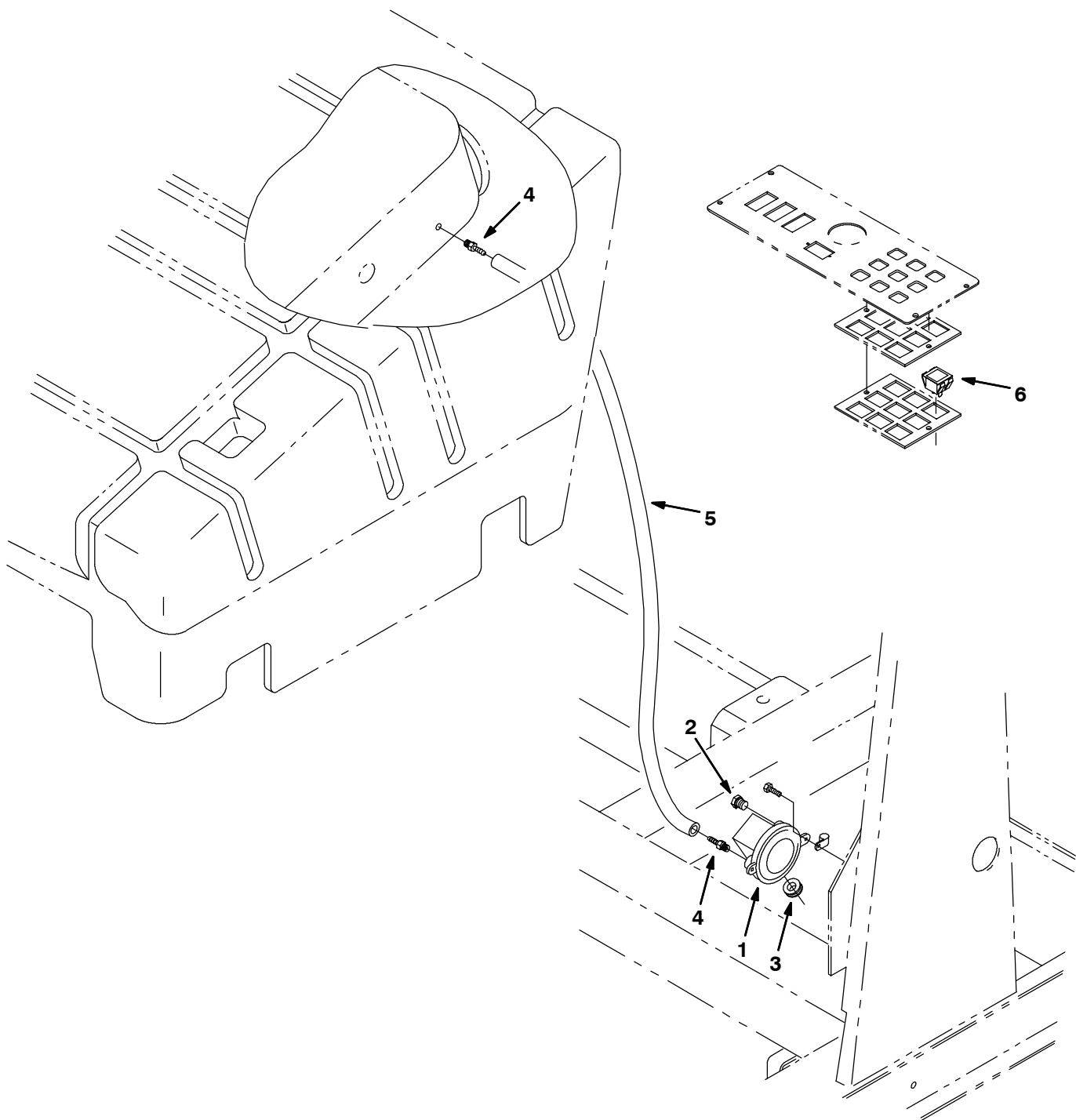

**FIG. 1 - FILTER SWITCH KIT, INSTALLATION**

**Mount the filter switch to the inside of the machine frame with screws and lock washers.**

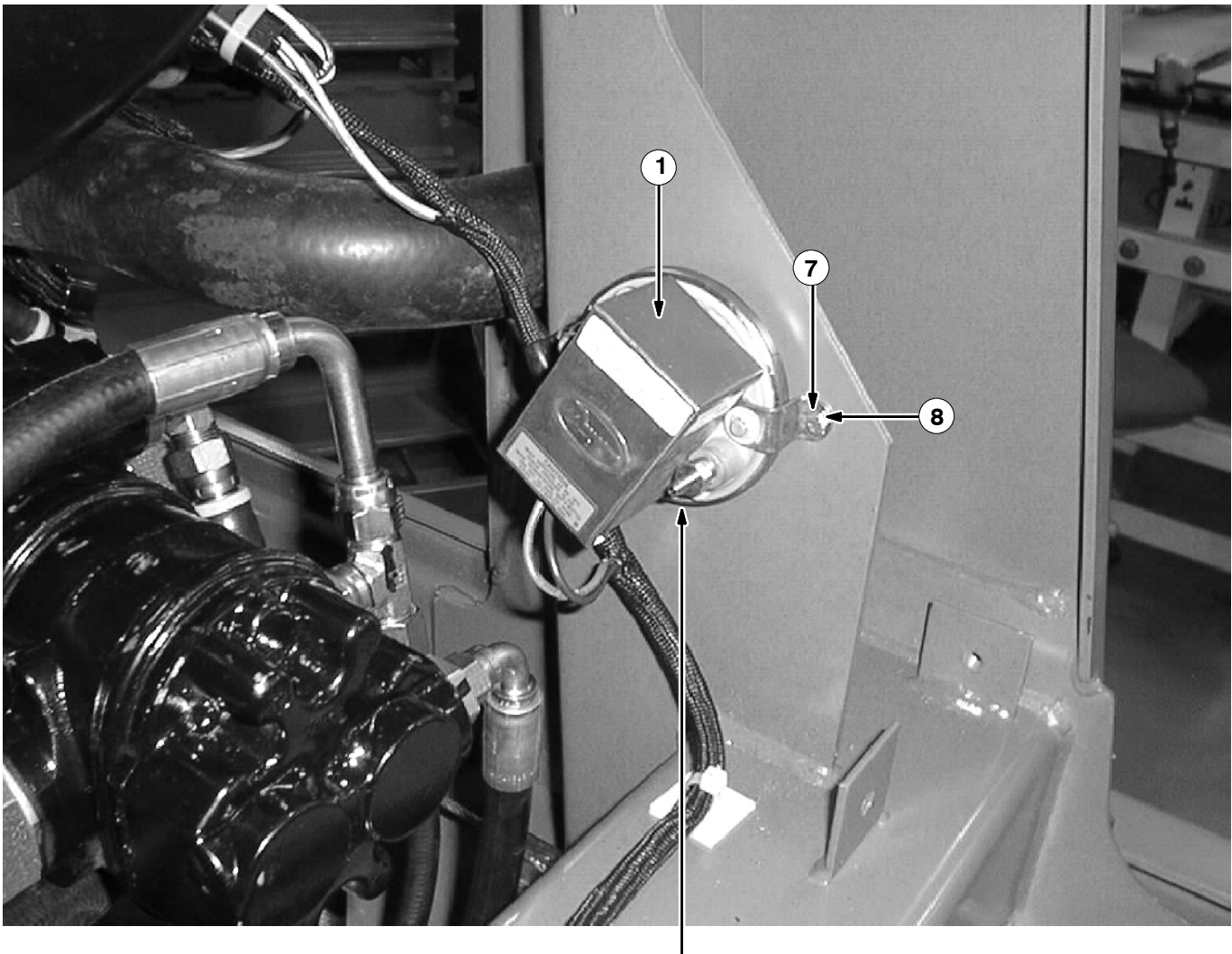

**Connect the vacuum hose from the debris hopper to the filter switch.**

**FIG. 2 - FILTER SWITCH KIT, INSTALLATION**

TENNANT COMPANY  
P. O. Box 1452  
Minneapolis, MN 55440-1452

**Install new indicator light in lower left  
hand corner of indicator light panel**

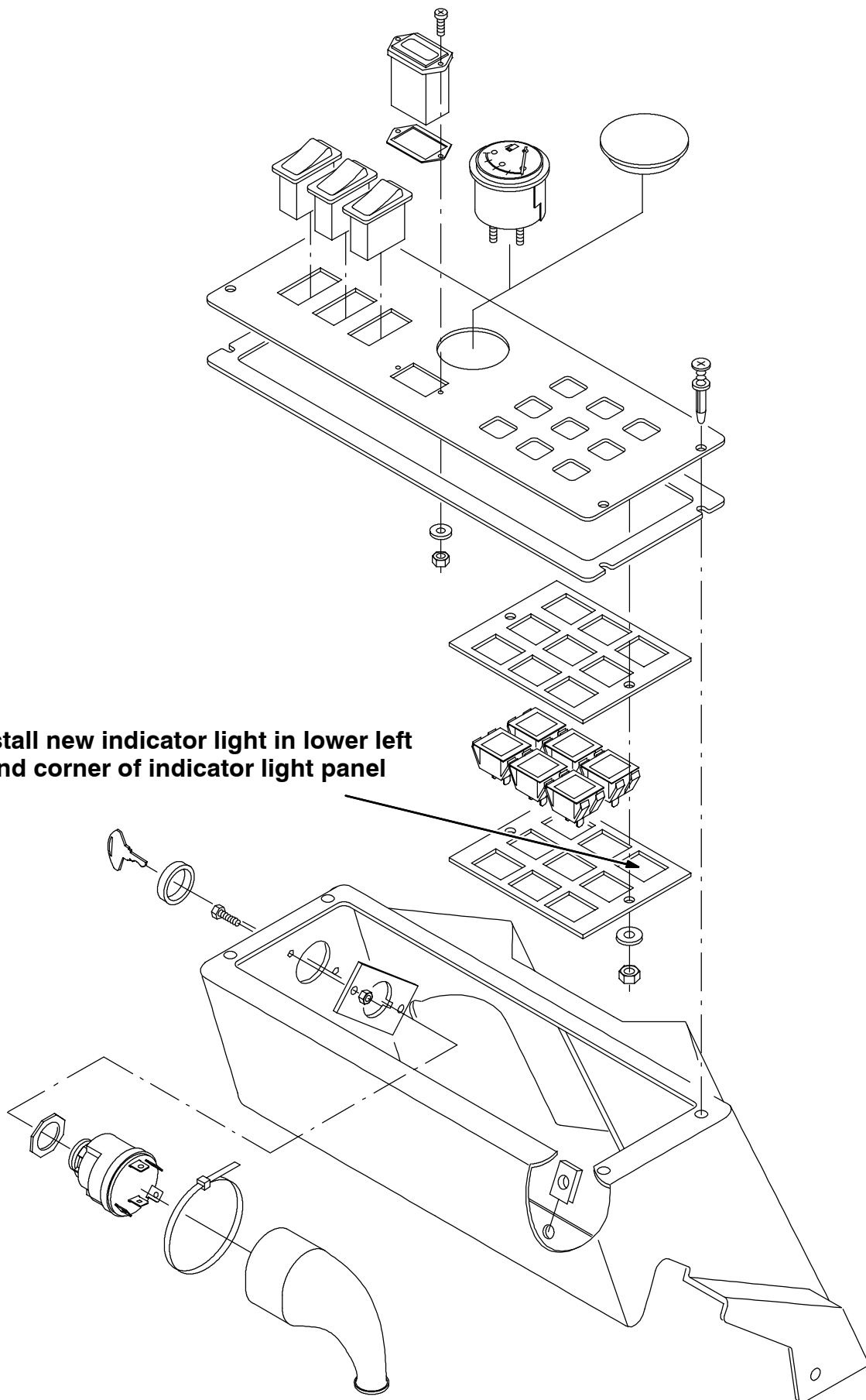

**FIG. 3 - FILTER SWITCH KIT, INSTALLATION**

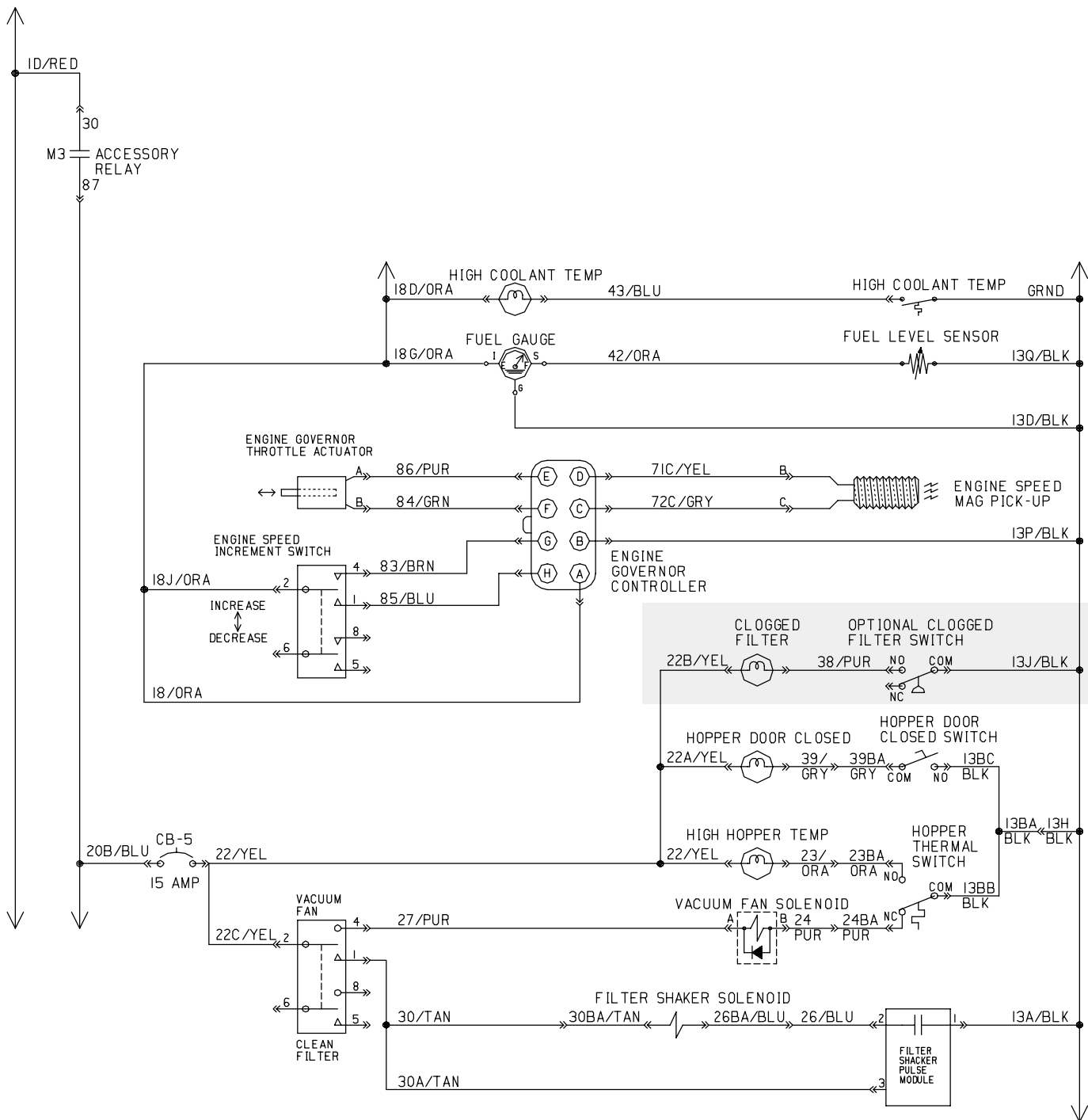
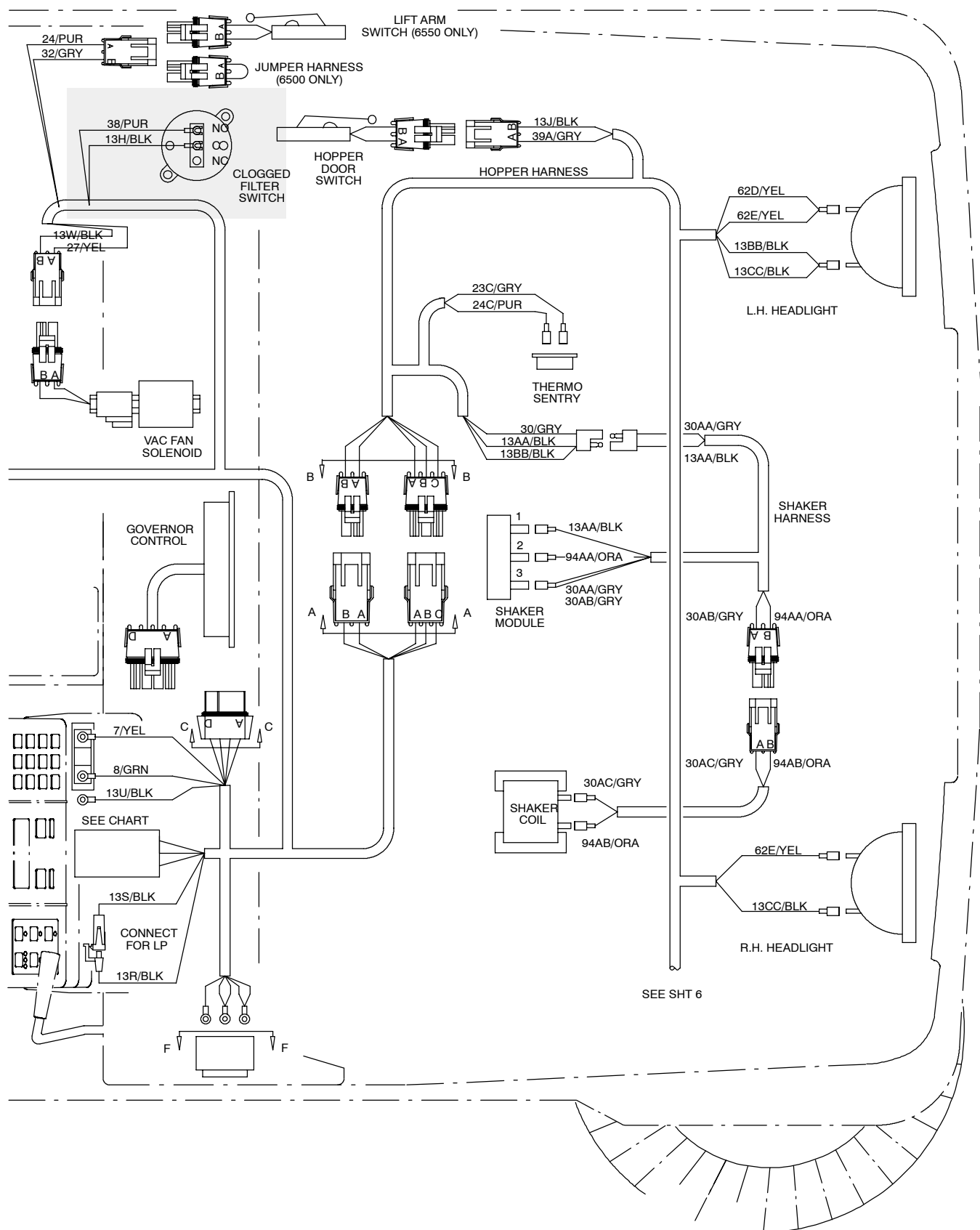

FIG. 4 - ELECTRICAL SCHEMATIC, 6500



**FIG. 5 - WIRE HARNESS GROUP, 6500**

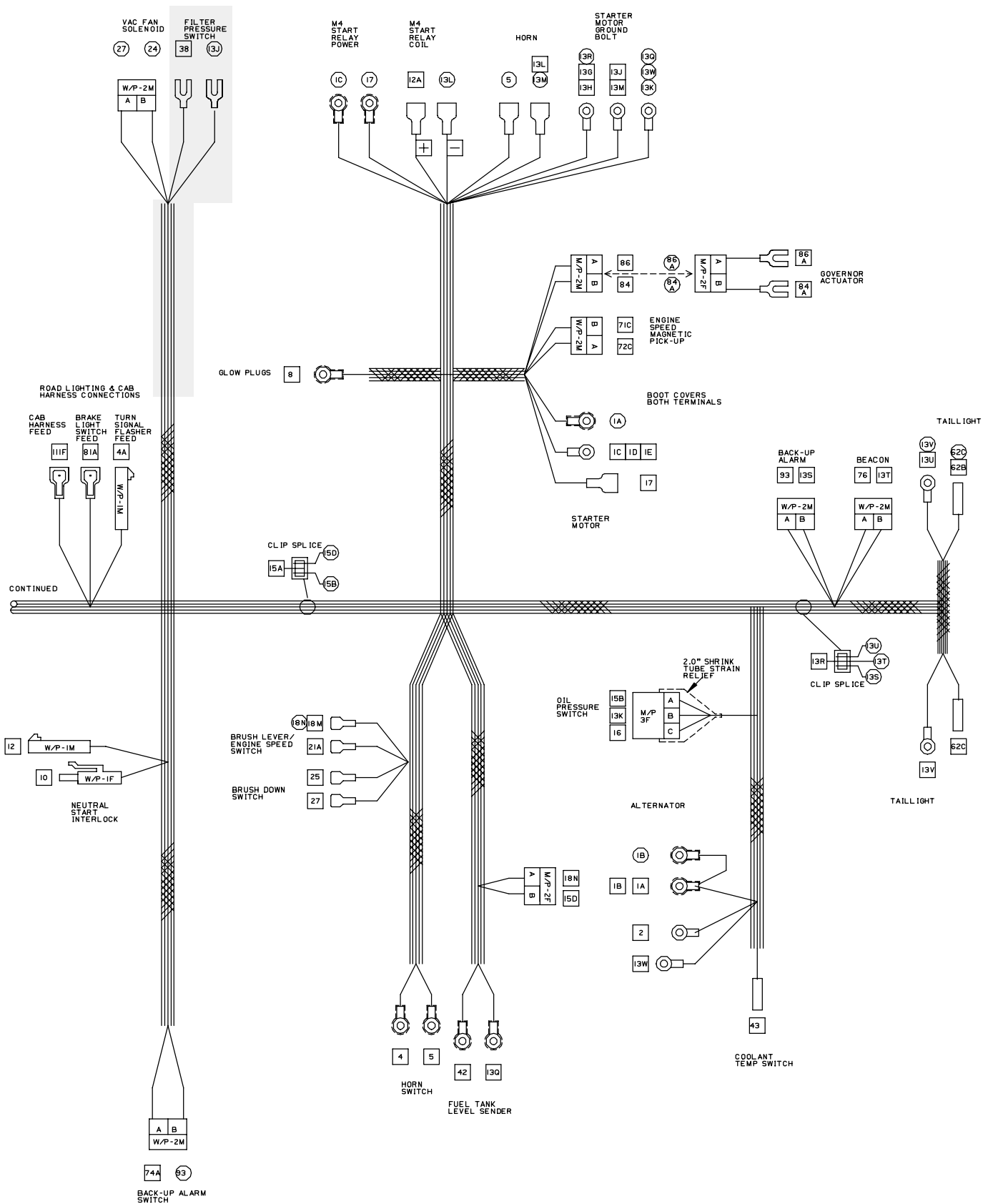

FIG. 6 - WIRE HARNESS GROUP, 6500