



INSTRUCTION BULLETIN

No. 340501
Machine: 830, 830-II
Published: 3-02
Rev. 00

NOTE: DO NOT DISCARD the Parts List from the Instruction Bulletin. Place the Parts List in the appropriate place in your machine manual for future reference. Retaining the Parts List will make it easier to reorder individual parts and will save you the cost of ordering an entire kit.

NOTE: Numbers in parenthesis () are reference numbers for parts listed in Bill of Materials.

Installation instructions for **kit number 770009**

SYNOPSIS / PROBLEM:

This kit contains the parts needed to install/replace the air conditioning belt kit on the model 830 and 830-II sweepers.

Please follow step-by-step instructions.

SPECIAL TOOLS / CONSIDERATIONS: NONE

(Estimated time to complete: 2 hours)

PREPARATION:

(Refer to FIG. 1)

FOR SAFETY: Before leaving or servicing machine, stop on level surface and set parking brake. Then turn off machine and remove key.

FOR SAFETY: The air conditioning system is charged. To avoid cracking the hose fittings and causing leaks in the system, use extreme care when moving the compressor.

INSTALLATION:

(Refer to FIG. 1)

1. Loosen the two M12 bolts that fasten the Compressor Mounting Bracket to the engine stand. Back out the tensioning bolt and remove the belt from the compressor. Discard the belt. (Refer to FIG. 1)
2. Loosen the Alternator bolts; loosen the pivot fastener and the adjustment link fastener. Release all the tension and remove the belt. Discard the belt and replace it with (5) [matched set of 2 belts] on the double pulleys. Change the position of the alternator to give the correct tension. Tighten the adjustment link fastener (torque to 33 ft lb) and then the pivot link fastener (torque to 16 ft lb). Check the tension on the tighter of the two belts. If a Burroughs gauge is used, the correct tension is 80 ft lb. If no gauge is available, press down the belt with the thumb at the center of the longest free length and check the deflection. With moderate thumb pressure (10 ft lb), the correct belt deflection is 3/8 in.

3. Mount the new pulley (2) to the engine double-belt drive pulley using four hex bolts (4) and blue locktite (10). Torque to 50 ft lb.

FOR SAFETY: The air conditioning system is charged. Use extreme care when moving the compressor to avoid cracking the hose fittings and causing leaks in the system.

4. Remove the Air Conditioning Compressor from the mounting bracket, using care to avoid cracking the hose connections. Suspend the compressor as needed. Discard the fasteners.
5. Remove the bracket from the engine stand. Discard the bracket and fasteners. Install the new bracket (1) with two hex bolts (6) and two conical washers (7). Do not torque yet, just finger tight. Thread the M8 hex nut (11) halfway onto the M8 X 60 hex bolt (12). This will be the tensioning bolt for the compressor. Insert the bolt and nut into the threaded hole in the tab at the back of the bracket.
6. Reinstall the compressor on the new mounting bracket with two hex screws (8) and two nylock nuts(9). Torque to 31 ft lb.
7. Install the belt (3) from the compressor pulley to the new engine drive pulley. Use the tensioning bolt on the compressor bracket to tension the belt (see step 2 for tensioning). Tighten the two M12 bolts (6). Torque to 54 ft lb.
8. Start the engine. Check for leaks to the air conditioning system. Check for cool air from the air conditioner.

NOTE: Belt tension must be checked again after the first 600 miles or 20 hours of operation.

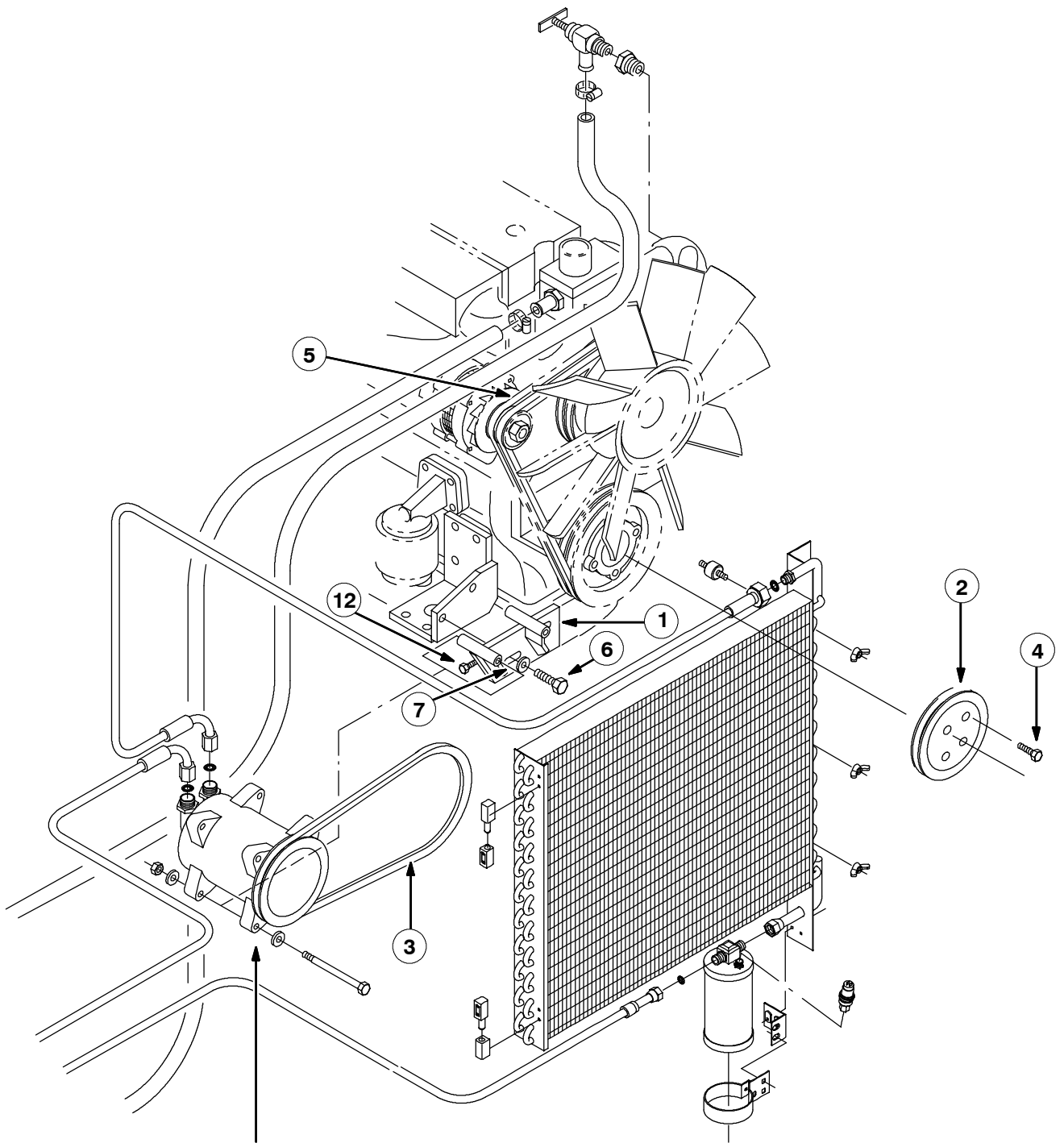

Air Conditioner Compressor

FIG. 1 - Air Conditioner Group

BILL OF MATERIALS FOR AIR CONDITIONING PULLEY/BELT KIT 770009.

Ref.	TENNANT Part No.	Description	Qty.
1	770006	Bracket Wldt, Compressor	1
2	769593	Pulley, V-belt	1
3	764209	Belt	1
4	39663	Screw, Hex, .44-20 X 1.00, 5	4
5	766691	Belt, [matched set of 2]	1
6	41346	Screw, Hex, M12 X 1.75 X 30, 8.8	2
7	763043	Washer, Belleville, M12	2
8	763096	Screw, Hex, M10 X 1.5 X 130	2
9	41430	Nut, Hex, Lock, M10 X 1.5, NL	2
10	32676	Adhesive, Thread, [242blu .5ml]	1
11	39311	Nut, Hex, STD, M08 X 1.25	1
12	763090	Screw, Hex, M08 X 1.25 X 60, FL	1

TENNANT COMPANY
P. O. Box 1452
Minneapolis, MN 55440-1452