



INSTRUCTION BULLETIN

No. 340455
Machine: 830-II
Published: 10-2007
Rev: 01

NOTE: DO NOT DISCARD the Parts List from the Instruction Bulletin. Place the Parts List in the appropriate place in the machine manual for future reference. Retaining the Parts List will make it easier to reorder individual parts and will save the cost of ordering an entire kit.

NOTE: Numbers in parenthesis () are reference numbers for parts listed in Bill of Materials.

Installation instructions for kit number 769006

SYNOPSIS:

This kit contains the parts needed to replace the gear pump on the 830-II sweeper.
Please follow step-by-step instructions.

SPECIAL TOOLS / CONSIDERATIONS:

(Estimated time to complete: 2 hours)

When assembling/disassembling hydraulic components:

1. Thoroughly clean outside of hydraulic components **before** disconnecting hydraulic hoses or fittings to prevent contaminants from entering system.
2. Cap disconnected hoses and open ports to prevent contaminants from entering system.
3. Flush hoses and fittings with air, solvent, or hydraulic fluid to prevent contaminants from entering system.
4. Mark hydraulic hoses with locations of where they are attached. Markings make it easier to reconnect hoses to proper locations.
5. Discard all hydraulic fluid drained from the system. Use only new approved hydraulic fluid to replenish hydraulic reservoir. Hydraulic fluid is potentially dangerous to the environment. Obey all federal, state, and local laws/regulations governing the disposal of environmentally hazardous materials when disposing hydraulic fluid.

PREPARATION: (Refer to FIG. 1 for locations of all parts removed/installed in this Instruction Bulletin)

1. Park the machine on a clean level surface, turn off the machine, remove the key, and set the parking brake.

FOR SAFETY: Before leaving or servicing machine, stop on level surface, turn off machine, and remove key.

2. Open the RH side panel. Drain the hydraulic tank below the level of the suction lines.

NOTE: Order TENNANT part # 760098 (plug and cap kit) before attempting any hydraulic component repairs.

3. Remove the hydraulic hoses attached to the accessory pump.
4. Remove the two hex screws and washers holding the accessory pump to the piston pump.
5. Pull the accessory pump straight out of the piston pump.
6. Note orientation of the hydraulic fittings on the accessory pump and remove the fittings from the pump.
7. Install the fittings removed in the previous step onto the new accessory pump (1). Be sure to orient the fittings the same as they were on the removed accessory pump.

INSTALLATION:

NOTE: The intermediate plate between the accessory pump (1) and the piston pump must be pulled out so the o-ring behind it can be replaced.

1. Remove the o-ring located directly behind the intermediate plate from inside the piston pump.
2. Apply a light coat of grease to new o-rings (2) and (3). Grease helps hold the o-rings in place when the new accessory pump (1) is installed onto the piston pump.
3. Insert o-ring (2) into the piston pump, where the old o-ring was previously located.
4. Insert o-ring (3) into the notch inside the intermediate plate.
5. Apply a light coat of grease onto the shaft of the accessory pump (1).
6. Apply a coat of Loctite blue 242 onto the threads of the saved hex screws.
7. Use saved hardware to install the accessory pump (1) into the back of the piston pump. Tighten to 90 - 117 Nm (65 - 85 ft lb).
8. Connect the hydraulic hoses to the accessory pump (1).
9. Refill the hydraulic system to the appropriate level.
10. Start the machine and check the hydraulic system for proper operation. Also, check around the hydraulic hoses/fittings and accessory pump (1) for leaks.
11. Close the RH side panel.

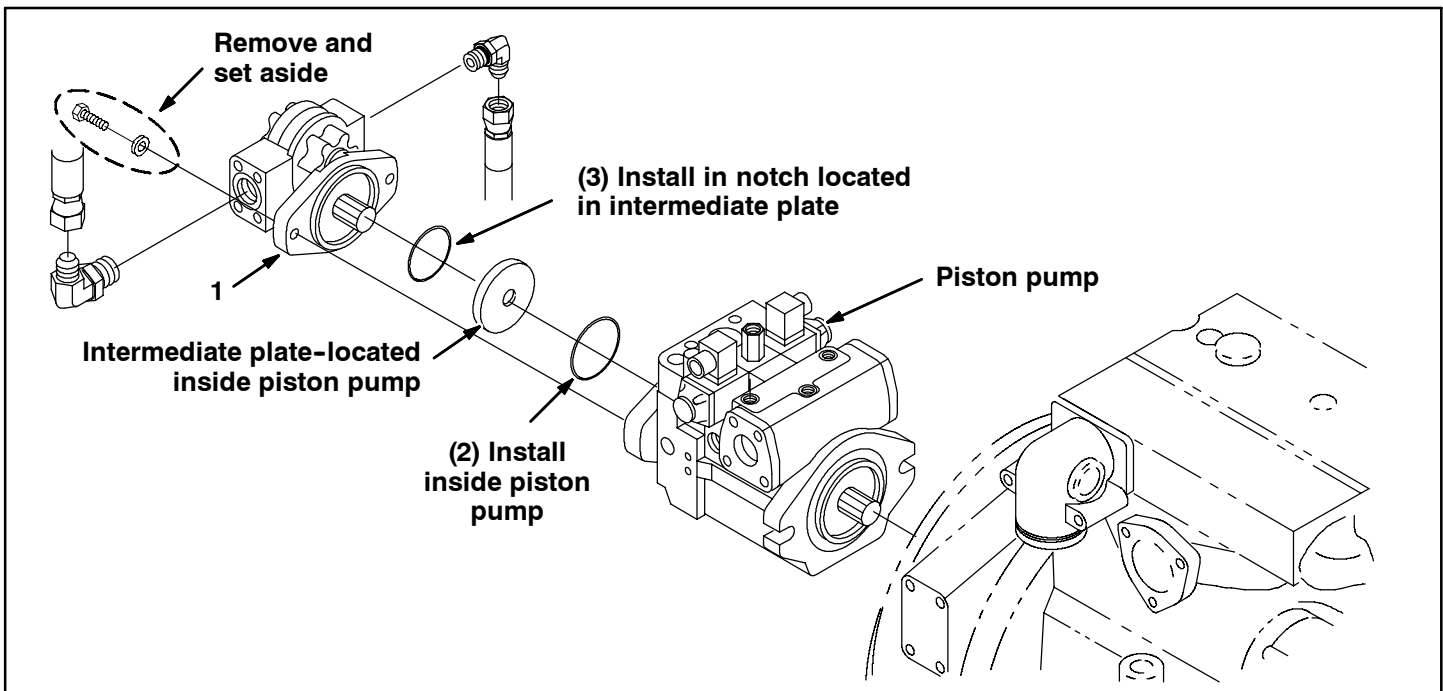

FIG. 1 - Hydraulic Pump Group

Bill of Materials for Pump Kit, Gear, Hyd, Replmt - 769006

Ref.	TENNANT Part No.	Description	Qty.
1	762024	Pump, Hyd	1
2	769004	Seal, Org, .103 X 3.00 ID	1
3	769005	Seal, Org, .103 X 4.00 ID	1

TENNANT COMPANY
P. O. Box 1452
Minneapolis, MN 55440-1452