



INSTRUCTION BULLETIN

No. 340375
Machine: 830
Published: 12-99/00
System: ENGINE

NOTE: DO NOT DISCARD the Parts List from the Instruction Bulletin. Place the Parts List in the appropriate place in your machine manual for future reference. Retaining the Parts List will make it easier to reorder individual parts and will save you the cost of ordering an entire kit.

NOTE: Numbers in parenthesis () are reference numbers for parts listed in Bill of Materials.

Installation instructions for kit number 764353

SYNOPSIS / PROBLEM:

This kit contains the parts needed to install a remote hydraulic filter mount kit on the model 830 sweeper.

Please follow step-by-step instructions.

SPECIAL TOOLS / CONSIDERATIONS: NONE

(Estimated time to complete: 2 hours)

HYDRAULIC PRINCIPLES:

1. Cleanliness is extremely important when working with hydraulic components. Work in a clean, dust-free area. Dirt or foreign material in hydraulic systems can impair operation and damage equipment.
2. Before disconnecting hydraulic hoses or fittings, thoroughly clean outside of hydraulic component to prevent dirt from entering system.
3. Mark hydraulic hoses and record locations for proper installation.
4. Cap disconnected hoses or open ports to keep dirt out of system.
5. Discard any hydraulic fluid drained from system. Use only new, approved hydraulic fluid to replenish hydraulic reservoir.
6. Flush hose and fittings at pressure port of hydraulic component with air, solvent or hydraulic fluid to help avoid contamination.

PREPARATION:

(Refer to FIG. 1 and 2)

1. Park the machine on a level surface and set the parking brake.

FOR SAFETY: Before leaving or servicing machine, stop on level surface and set parking brake. Then turn off machine and remove key.

2. Disconnect battery cables from machine.



WARNING: Always disconnect battery cables from machine before working on electrical components.

INSTALLATION:

(Refer to FIG. 1 and 2)

1. Close the valve to the suction filter.
2. Disconnect the hydraulic line leading from the filter to the propel pump.
3. Remove the filter assembly and adapter fitting.
4. Locate the engine oil filter and remove it from its mounting bracket. Set the mounting hardware aside. (Refer to FIG. 2)

NOTE: If hoses are disconnected from the oil filter before removal, mark hoses and filter to ensure proper connection when reinstalled.

5. Remove the oil filter mounting bracket from the machine. (Refer to FIG. 2)
6. Drill out the two smaller mounting holes in the floor plate to 11/32 (8.7 mm). (Refer to FIG. 1)
7. Position the new combination bracket (6) in place on the floor plate. (Refer to FIG. 2)
8. Mark the location of the larger floor plate mounting hole on the bracket and drill a 13/32 (10.3 mm) hole in the bracket. (Refer to FIG. 1)
9. Assemble the hydraulic filter head to the bracket (6) with four hex screws (12) and washers (3). Mount the filter head / bracket assembly to the frame of the machine with screws (4,5), washers (2,3) and lock nuts (1). (Refer to FIG. 1 and 2)
10. Mount the engine oil filter to the back side of the mounting bracket (6) with set aside hardware. (Refer to FIG. 2)

NOTE: If oil filter hoses need to be reconnected, check that marked hoses are aligned with proper filter inlet and outlet.

11. Install the hydraulic filter on the filter head.
12. Install the adapter (9) into the shut off valve. (Refer to FIG. 2)
13. Install 90° elbow hydraulic fitting (10) to the adapter. (Refer to FIG. 2)
14. Install 90° elbow hydraulic fitting (11) in the inlet of the hydraulic filter. (Refer to FIG. 2)
15. Connect the 90° elbow end of hydraulic hose (7) to the 90° elbow hydraulic fitting (11) in the inlet side of the hydraulic filter. (Refer to FIG. 2)
16. Connect the other end of hydraulic hose (7) to the 90° elbow and adapter (10,9) in the shut off valve. (Refer to FIG. 2)
17. Install the set aside adapter (8) in the filter outlet. (Refer to FIG. 2)
18. Connect the 90° elbow end of the second hydraulic hose (7) to adapter (8) in the filter outlet. (Refer to FIG. 2)
19. Connect the straight end of hydraulic hose (7) to the hydraulic pump. (Refer to FIG. 2)
20. Open the hydraulic valve at the tank.
21. Check the new hydraulic system for leaks.

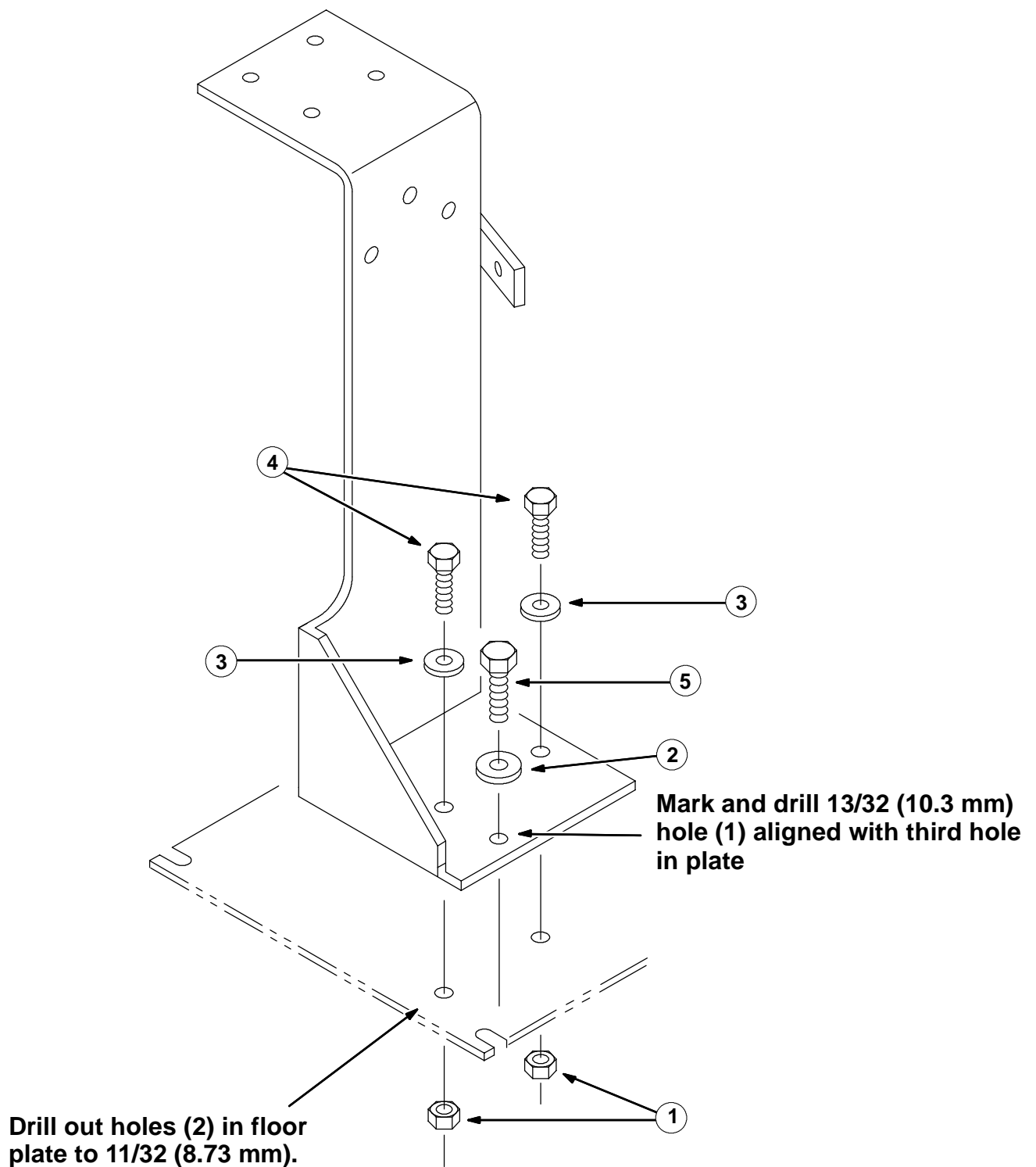
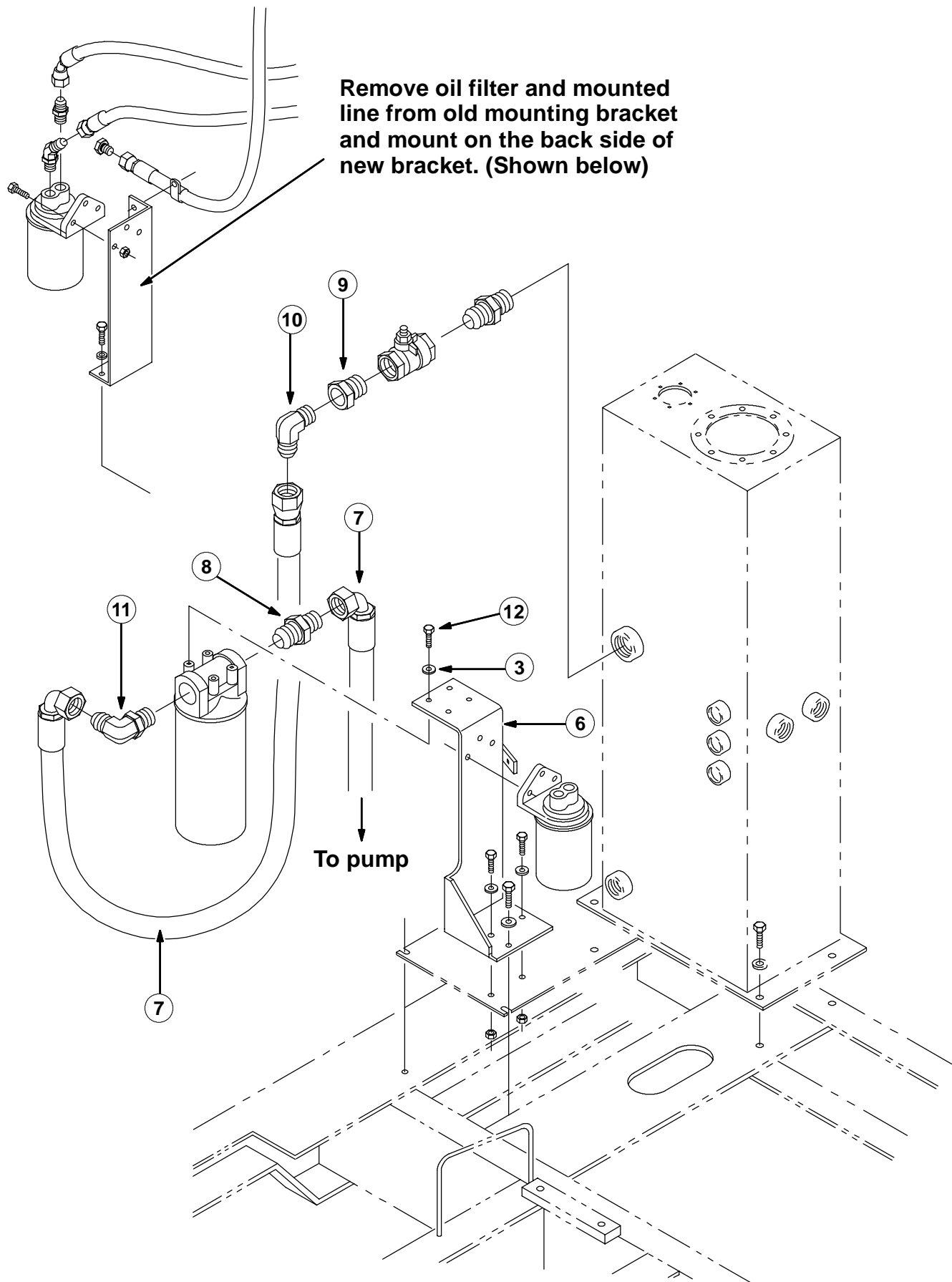

FIG. 1 - NEW MOUNTING BRACKET INSTALLATION



BILL OF MATERIALS FOR REMOTE HYD FILTER MOUNTING KIT 764353

Ref.	TENNANT Part No.	Description	Qty.
1	08709	Nut, Hex, Lock, M08-1.25, NL	2
2	32485	Washer, Flat, .38 SAE	1
3	32491	Washer, Flat, .31, Hard	6
4	39277	Screw, Hex, M08-1.25 X 25, 8.8	2
5	39284	Screw, Hex, M10-1.5 X 35, 8.8	1
6	762093	Bracket, Filter Mount	1
7	762306	Hose, Hydraulic	2
8	762483	Fitting, Hydraulic	1
9	764350	Fitting, Hydraulic, Straight	1
10	764351	Fitting, Hydraulic, E90	1
11	764352	Fitting, Hydraulic, E90	1
12	54397	Screw, Hex, 0.31-13 X 0.88, G5	4

TENNANT COMPANY
P. O. Box 1452
Minneapolis, MN 55440-1452