



INSTRUCTION BULLETIN

No. 340367
Machine: 7200
Published: 06-00/02
System: SCRUBBING

NOTE: DO NOT DISCARD the Parts List from the Instruction Bulletin. Place the Parts List in the appropriate place in your machine manual for future reference. Retaining the Parts List will make it easier to reorder individual parts and will save you the cost of ordering an entire kit.

NOTE: Numbers in parenthesis () are reference numbers for parts listed in Bill of Materials.

Installation instructions for kit number 369896

SYNOPSIS / PROBLEM:

This kit contains the parts needed to replace the solution tank level switch on the model 7200 scrubber.

Please follow step-by-step instructions.

SPECIAL TOOLS / CONSIDERATIONS: Metri-Pac wire test harness, voltmeter

(Estimated time to complete: .5 hour)

PREPARATION:

(Refer to FIG. 1 thru 15)

FOR SAFETY: Before leaving or servicing machine, stop on level surface and set parking brake. Then turn off machine and remove key.

1. Disconnect battery cables from machine.



WARNING: Always disconnect battery cables from machine before working on electrical components.

NOTE: TO CONFIRM PROPER PRESSURE SWITCH OPERATION BEFORE INSTALLATION, PERFORM THE FOLLOWING:

1. Remove the switch and mark the 4 in level from the bottom of the tube on the 8 in. tube/switch assembly.
2. Connect the switch to an ohmmeter with the metri-pac test wire harness (375023), or use clips to directly clamp on to the switch harness. The ohmmeter should read O.L. before switch is activated.
3. Slowly lower the switch into a 5 gallon bucket of water filled with roughly twelve inches of water. The switch should read below 1 ohm when activated at the 4 inch level of the tubes. The activation points at the 4 in levels can be fine tuned by turning the hex head (1.27 mm) adjustment screw on the top of the switch. Turning the screw clockwise decreases the set point, and turning the screw counterclockwise increases the set point.
4. Hold the tube at the 4 in level for 30 seconds. If there are no leaks in the tube/switch assembly, the ohm reading will hold steady. If a leak is present, or if the switch is malfunctioning, the ohm reading will show O.L. (open loop).

INSTALLATION:
(Refer to FIG. 1)

SOLUTION TANK PRESSURE SWITCH REPLACEMENT:

1. Open the solution tank cover.
2. Locate and remove the original float switch from the solution tank. (Refer to FIG. 1)
3. Install the (8 inch) tube/switch assembly in the solution tank opening. (Refer to FIG. 1)

NOTE: If the new tube/switch assembly will not easily fit into the opening after being lubricated with soap. Some trimming of the tank switch opening may be required.

4. Locate the grey and black wire harness (wire #'s 14/13Q), and plug the wire harness into the pressure switch harness, and attach the 0.25 in. OD X 0.16 in ID X 8 in long rubber vacuum hose on the pressure switch nipple. (Refer to FIG. 1)
5. The vacuum hose does not hook up to anything, it is open to atmospheric pressure. Orient the switch so that the harness and hose both clear everything. (Refer to FIG. 1)
6. Close the tank cover

BILL OF MATERIALS FOR ES LEVEL PRESSURE SWITCH KIT 369896

Ref.	TENNANT Part No.	Description	Qty.
1	385732	Switch assy, pressure, 4"	1
2	57578	Hose, vacuum	1
3	385744	Tube assy, 8"	1

TENNANT COMPANY
P. O. Box 1452
Minneapolis, MN 55440-1452

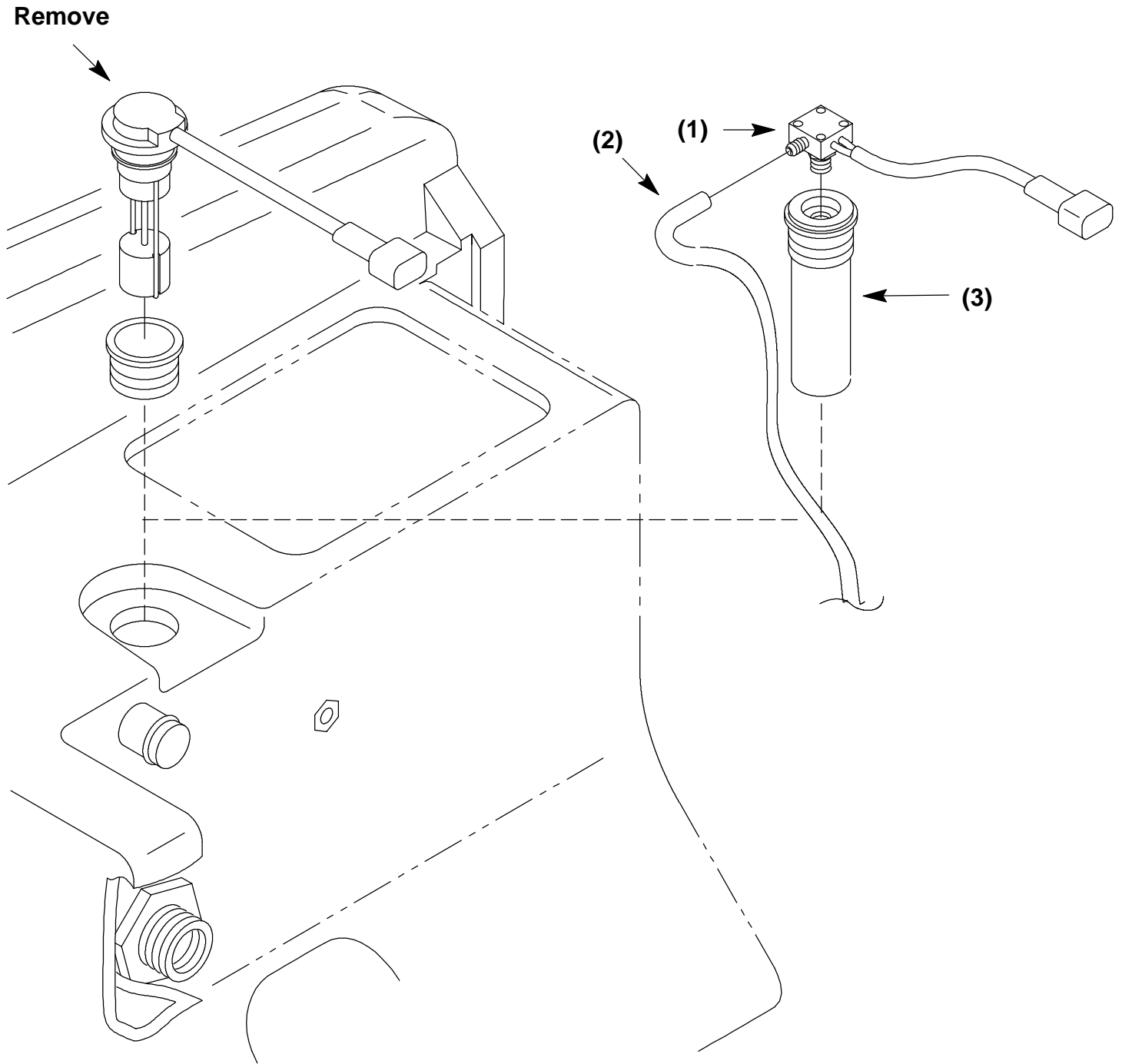

FIG. 1 - Tube/Switch assembly (1)