



# INSTRUCTION BULLETIN

No. 340356  
Machine: Litter Hawk™  
Published: 10-99/00  
System: ENGINE

**NOTE: DO NOT DISCARD the Parts List from the Instruction Bulletin. Place the Parts List in the appropriate place in your machine manual for future reference. Retaining the Parts List will make it easier to reorder individual parts and will save you the cost of ordering an entire kit.**

*NOTE: Numbers in parenthesis ( ) are reference numbers for parts listed in Bill of Materials.*

Installation instructions for kit number 382494

## **SYNOPSIS / PROBLEM:**

This kit contains the parts needed to replace the fuel solenoid on the model Litter Hawk™ sweeper/scrubber.

Please follow step-by-step instructions.

## **SPECIAL TOOLS / CONSIDERATIONS: NONE**

(Estimated time to complete: 1 hour)

## **PREPARATION:**

(Refer to FIG. 1 thru 6)

**FOR SAFETY: Before leaving or servicing machine, stop on level surface and set parking brake. Then turn off machine and remove key.**

1. Disconnect battery cables from machine.



**WARNING: Always disconnect battery cables from machine before working on electrical components.**

2. Lift the operator seat / engine cover to access the fuel solenoid.
3. Raise the hopper cover, and lock into place with the hopper prop rod.
4. Remove the right side shield assembly to access the solenoid module mounting location.

## **INSTALLATION:**

(Refer to FIG. 1 thru 6)

1. Unplug the old solenoid module from the wire harness.
2. Remove the old solenoid module from the machine. Set the mounting hardware aside.
3. Mount the new solenoid module (1) to the machine with the set aside hardware.  
(Refer to FIG. 1 and 2)
4. Plug the new solenoid module (1) to the wire harness. Replace the right side shield assembly. (Refer to FIG. 1 and 2)
5. Unplug the old solenoid (382312) from the machine.
6. Remove and discard the old solenoid from the machine.

7. Place the new solenoid (2) in mounting position, assuring that the pin is in the fuel linkage arm. (Refer to FIG. 5)
8. Loosely mount the new solenoid (2) to the machine with mounting hardware. (Refer to FIG. 4)
9. Slide the solenoid (2) towards the engine as far as possible to preload the spring and shaft against the fuel stop arm. (Refer to FIG. 4 and 5)
10. Tighten the two mounting bolts. (Refer to FIG. 4)
11. Plug the solenoid into the wire harness. (Refer to FIG. 5)
12. Connect the battery cables to the machine.

**RIGHT SIDE OF MACHINE**

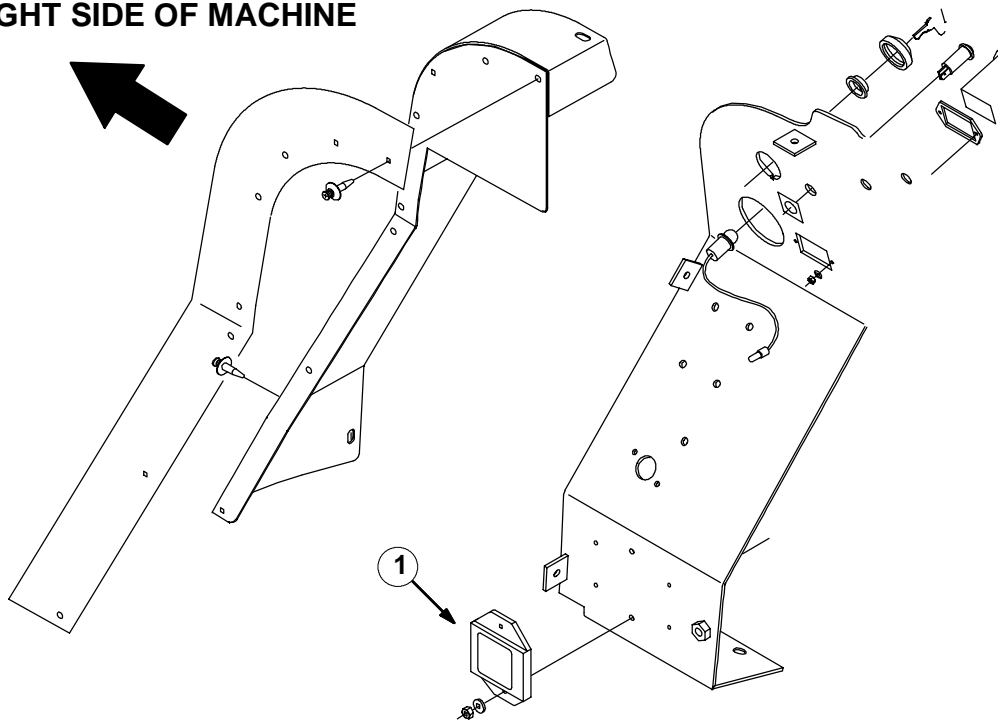

**FIG. 1 - FUEL SOLENOID MODULE INSTALLATION**

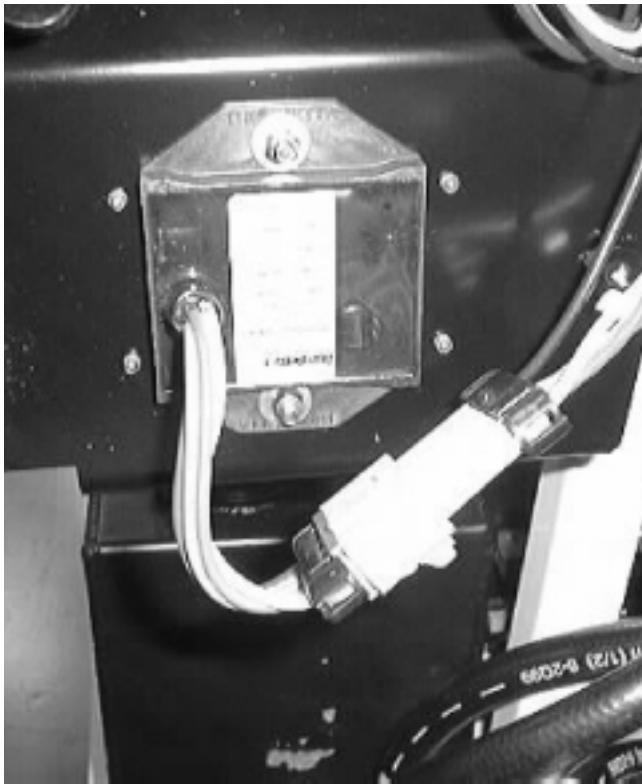

**FIG. 2 - FUEL SOLENOID MODULE  
INSTALLATION**

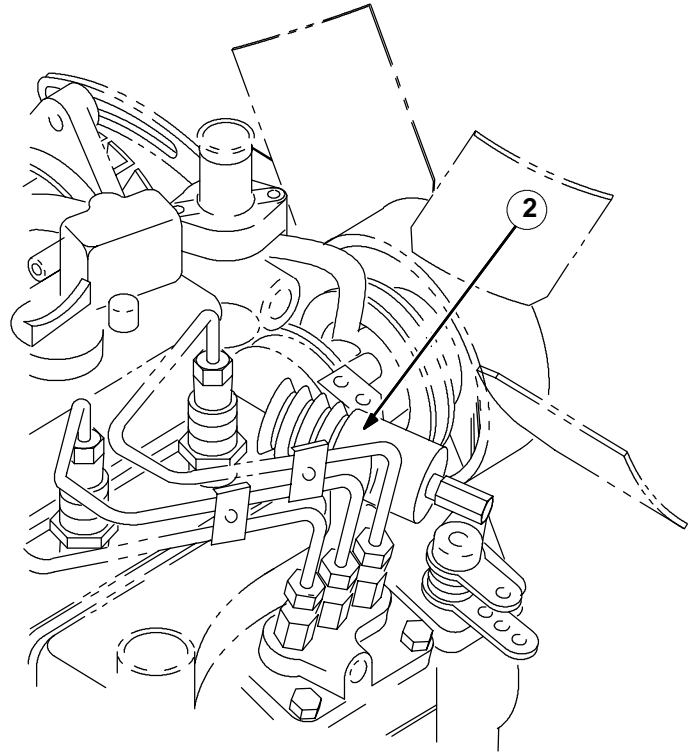

**FIG. 3 - FUEL SOLENOID INSTALLATION**

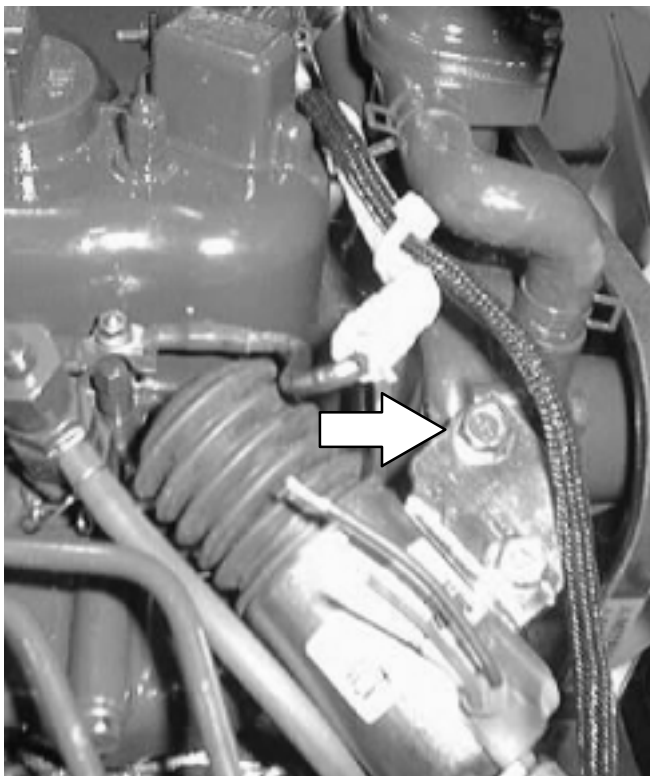

**FIG. 4 - SOLENOID WIRE CONNECTION**

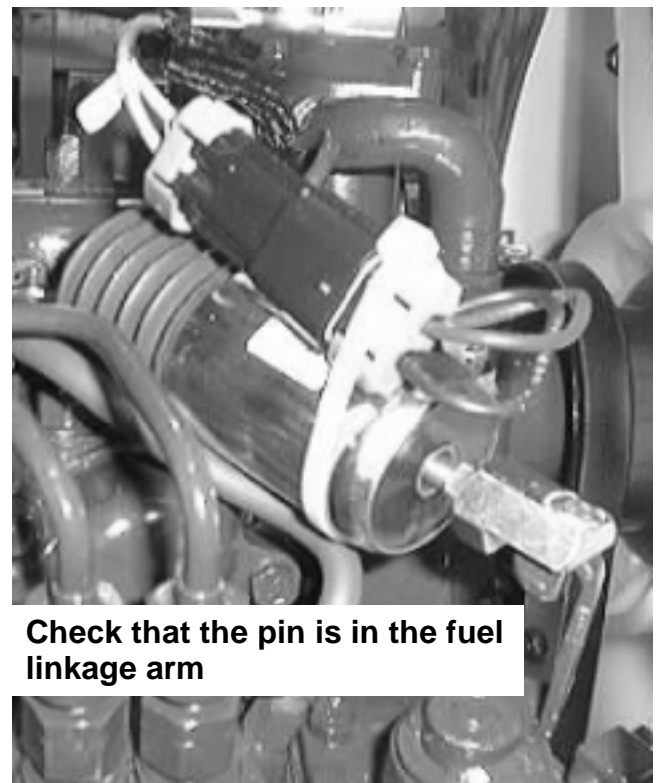

**FIG. 5 - SOLENOID PLUG CONNECTION**

