



# INSTRUCTION BULLETIN

No. 340353  
Machine: Litter Hawk™  
Published: 9-99/00  
System: ELECTRICAL

**NOTE: DO NOT DISCARD the Parts List from the Instruction Bulletin. Place the Parts List in the appropriate place in your machine manual for future reference. Retaining the Parts List will make it easier to reorder individual parts and will save you the cost of ordering an entire kit.**

*NOTE: Numbers in parenthesis ( ) are reference numbers for parts listed in Bill of Materials.*

Installation instructions for kit number 382765

## SYNOPSIS / PROBLEM:

This kit contains the parts needed to install a strobe lamp replacement kit on the model Litter Hawk™ sweeper

Please follow step-by-step instructions.

## SPECIAL TOOLS / CONSIDERATIONS: HAND DRILL, 3/8 (9.53 MM) DRILL BIT, AND SMALL FIBERGLASS CUTTING TOOL (SAW, DREMEL TOOL, FILE)

(Estimated time to complete: 1 hour)

## PREPARATION:

(Refer to FIG. 1 and 2)

**FOR SAFETY: Before leaving or servicing machine, stop on level surface and set parking brake. Then turn off machine and remove key.**

1. Disconnect battery cables from machine.



**WARNING: Always disconnect battery cables from machine before working on electrical components.**

## INSTALLATION:

(Refer to FIG. 1 and 2)

1. Open the hopper cover, and secure with the hopper prop rod.
2. Disconnect the old light wiring from the main wiring harness.
3. Remove the old light fixture, mounting plate, and mounting hardware from the hopper cover.
4. Using the dimensions given in figure 1, mark, cut and drill holes in the hopper cover for the new light fixture. (Refer to FIG. 1)

*NOTE: Carefully guide the new lamp wiring through the mounting bracket and the hopper cover before securing the mounting hardware.*

5. Mount the new lamp (1) and mounting bracket (2) to the machine with two flat screws (3), washers (5) and hex nuts (4). (Refer to FIG. 2)
6. Connect the jumper wire harness (6) to the main wire harness.
7. Connect the jumper wire harness (6) to the new light fixture (1).

8. Disengage the hopper prop rod and close the hopper cover.
9. Connect the battery cables back to the machine.
10. Check the new lamp for proper operation.

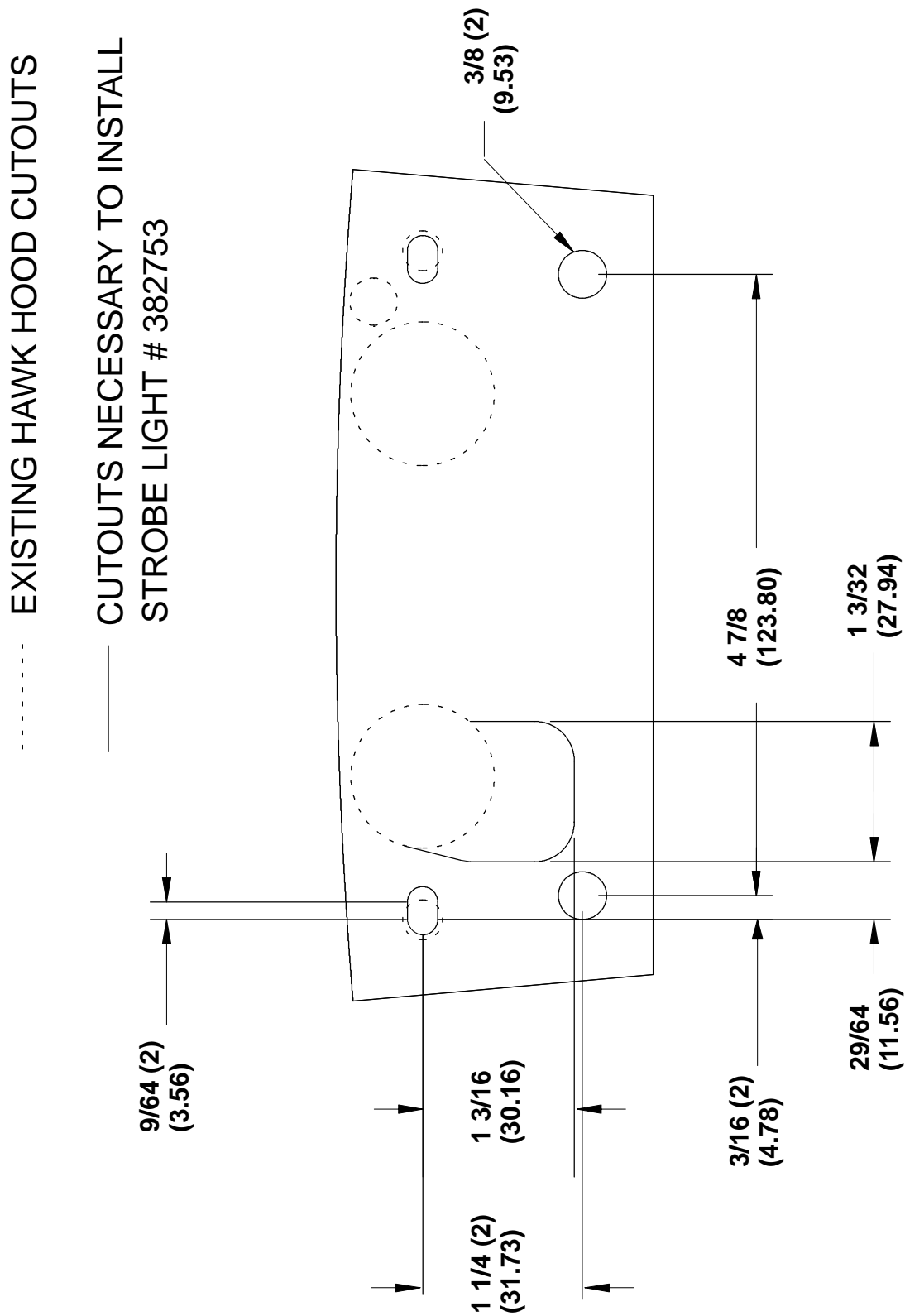
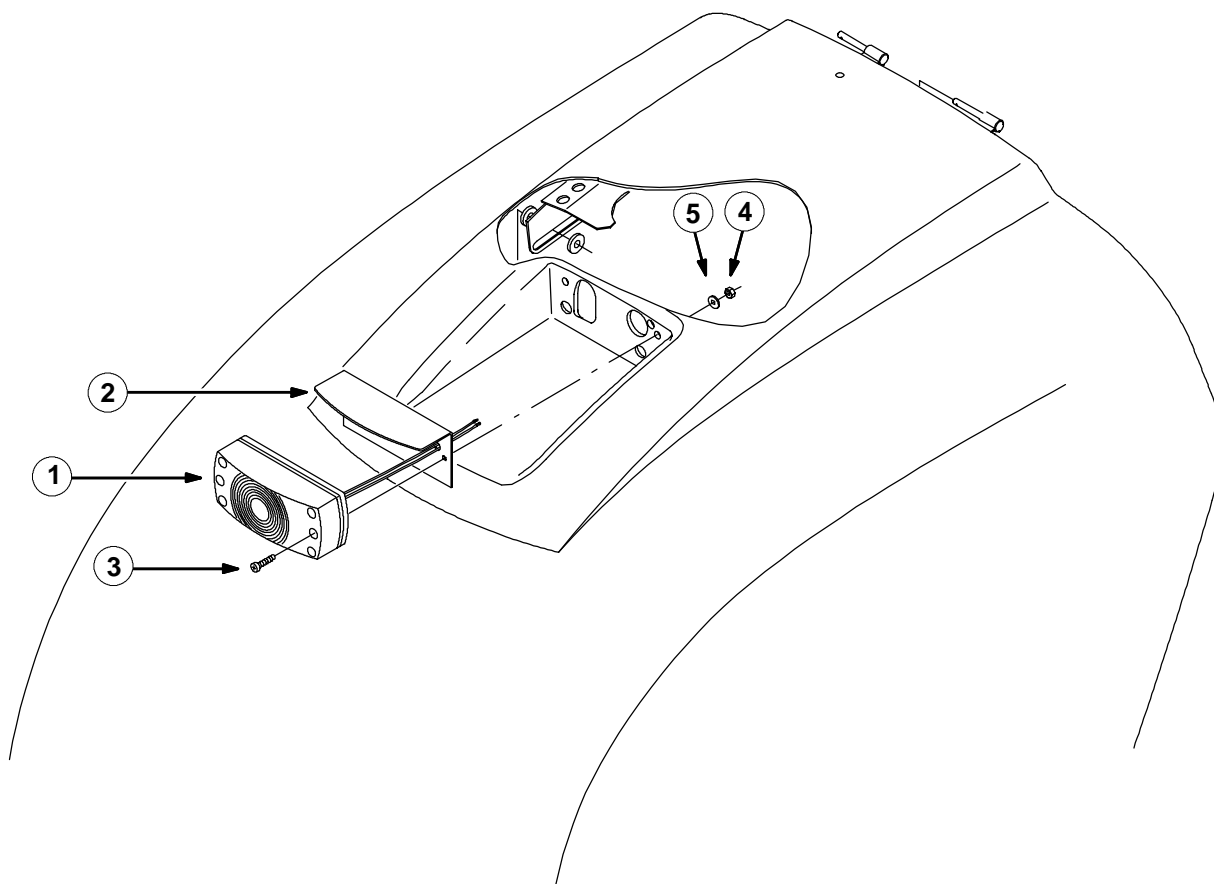

FIG. 1 - NECESSARY CUT OUT DIMENSIONS



**FIG. 2 - STROBE LIGHT INSTALLATION**

**BILL OF MATERIALS FOR STROBE LIGHT KIT 382765**

| Ref. | TENNANT<br>Part No. | Description                    | Qty. |
|------|---------------------|--------------------------------|------|
| 1    | 382753              | Lamp, Strobe, Amber            | 1    |
| 2    | 382695              | Bracket Wldt, Mounting, Strobe | 1    |
| 3    | 382754              | Scr, Flat, M04 X 0.7           | 2    |
| 4    | 02850               | Nut, Hex, Lock, M04-0.7, NL    | 2    |
| 5    | 19066               | Washer, Flat, #10              | 2    |
| 6    | 382773              | Harness, Jumper                | 1    |

TENNANT COMPANY  
P. O. Box 1452  
Minneapolis, MN 55440-1452