



INSTRUCTION BULLETIN

No. 340332
Machine: Litter Hawk t
Published: 10-99/01
System: SWEEPING

NOTE: DO NOT DISCARD the Parts List from the Instruction Bulletin. Place the Parts List in the appropriate place in your machine manual for future reference. Retaining the Parts List will make it easier to reorder individual parts and will save you the cost of ordering an entire kit.

NOTE: Numbers in parenthesis () are reference numbers for parts listed in Bill of Materials.

Installation instructions for kit number 382688

SYNOPSIS / PROBLEM:

This kit contains the parts needed to reroute the water hoses on the model Litter Hawk™ sweeper so the hoses do not interfere with the air diffuser screens beneath the filters when the brushes are down.

Please follow step-by-step instructions.

SPECIAL TOOLS / CONSIDERATIONS: Hand drill, .090 in. (2.38 mm) drill bit

(Estimated time to complete: 1 hour)

PREPARATION:

(Refer to FIG. 1, 2 and 3)

FOR SAFETY: Before leaving or servicing machine, stop on level surface and set parking brake. Then turn off machine and remove key.

1. Lift open the hopper cover.
2. Lower the vacuum head and remove the debris hopper.
3. Locate the vinyl hose "T" junction behind the brake cross shaft on the left side, next to the U bolt. (Refer to FIG. 1)

INSTALLATION:

(Refer to FIG. 1, 2 and 3)

NOTE: New hoses and clamps may not be necessary if steps 1 thru 4 can be accomplished with the existing hoses.

1. Tie the water hoses to the rectangular tube cross member with the cable ties.
(Refer to FIG. 3)
2. Route the hoses under the cross member on each side above the horizontal brush arm springs. (Refer to FIG. 2 and 3)
3. Tie the hoses to the rear half of the side brush arms with the cable ties. (Refer to FIG. 3)
4. If the hoses bend or kink, relocate the front hose clamps up inside the front bumper with a .090 drill. (Refer to FIG. 3)

5. If the old hoses cannot be rerouted properly without touching the diffuser screens below the filters, the old hoses will need to be replaced with sections of the new hose (1) cut to length as necessary.

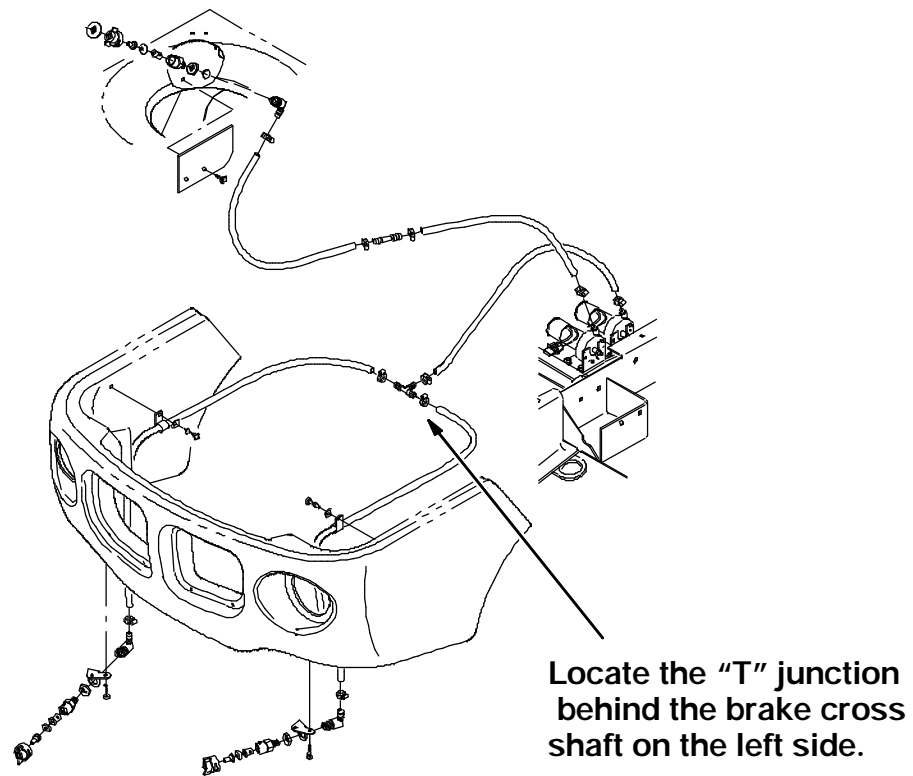

FIG. 1 - WATER LINE BREAKDOWN

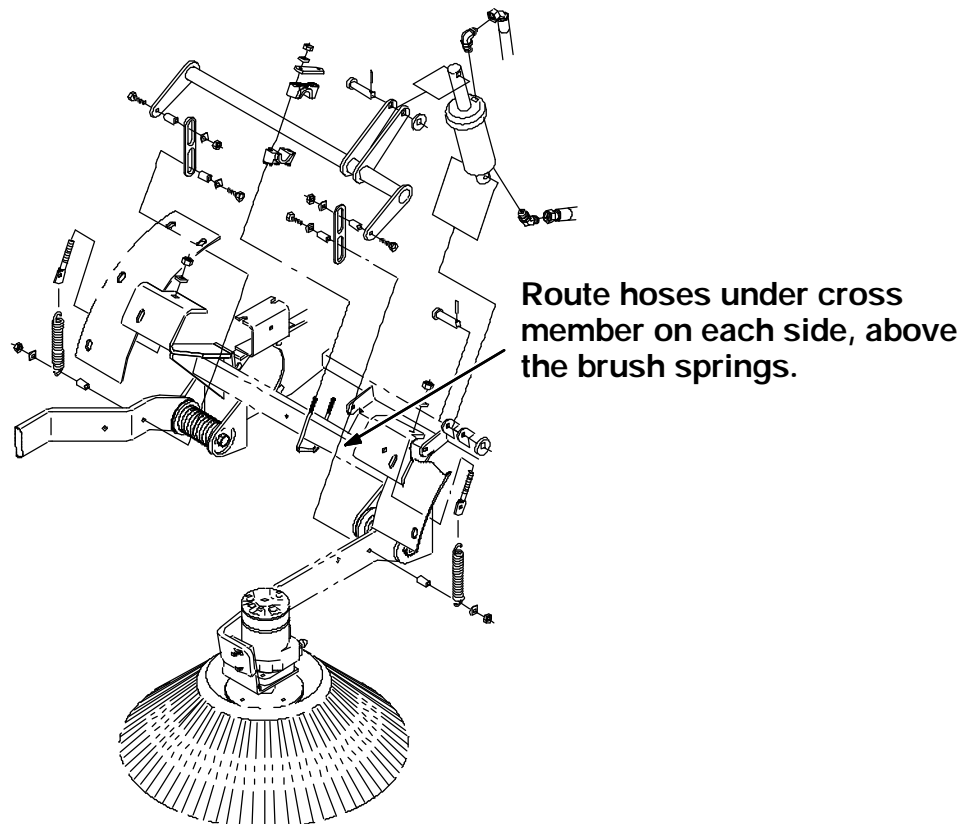
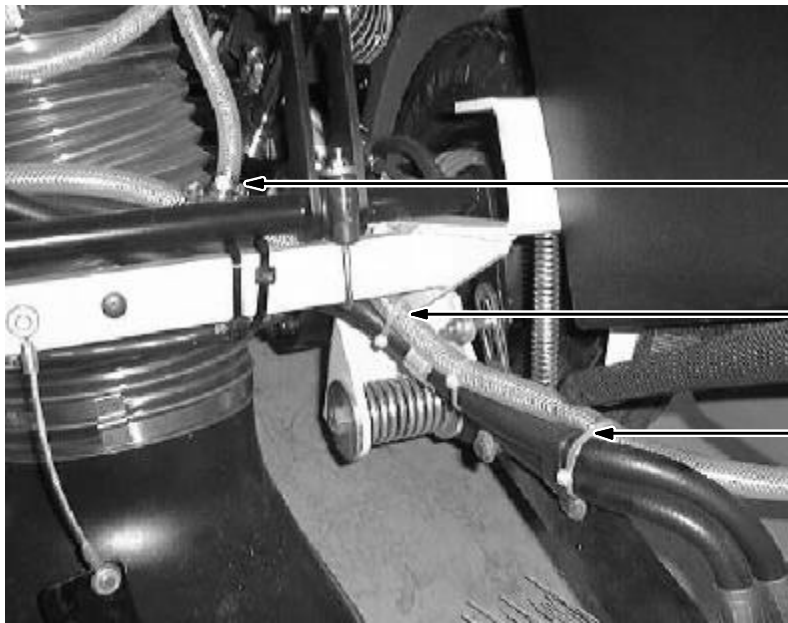

FIG. 2 - BRUSH ARM BREAKDOWN



Locate the "T" junction behind the brake cross shaft on the left side.

Route hoses under cross member on each side, above the brush springs.

Cable tie the hoses to the rear half of the side brush arms.

Relocate the front hose clamps if necessary with a .090 in drill to prevent hoses from kinking.

FIG. 3 - NEW HOSE ROUTING

BILL OF MATERIALS FOR VINYL HOSE KIT 382688

Ref.	TENNANT Part No.	Description	Qty.
1	382745	Hose, vinyl braid, .51 ID .73 OD 60. OL	2
2	44961	Tie, cable,	6
3	67767	Clamp	1
4	19066	Washer	1
5	360973	Screw	1

TENNANT COMPANY
P. O. Box 1452
Minneapolis, MN 55440-1452