



INSTRUCTION BULLETIN

No. 340311
Machine: Litter Hawk
Published: 6-99/00
System: SWEEPING

NOTE: DO NOT DISCARD the Parts List from the Instruction Bulletin. Place the Parts List in the appropriate place in your machine manual for future reference. Retaining the Parts List will make it easier to reorder individual parts and will save you the cost of ordering an entire kit.

NOTE: Numbers in parenthesis () are reference numbers for parts listed in Bill of Materials.

Installation instructions for kit number 382615

SYNOPSIS / PROBLEM:

This kit contains the parts needed to replace the slide washers on the Litter Hawk™. Please follow step-by-step instructions.

SPECIAL TOOLS / CONSIDERATIONS: NONE

(Estimated time to complete: 1 hour)

PREPARATION:

(Refer to FIG. 1)

FOR SAFETY: Before leaving or servicing machine, stop on level surface and set parking brake. Then turn off machine and remove key.

1. Disconnect battery cables from machine.



WARNING: Always disconnect battery cables from machine before working on electrical components.

INSTALLATION:

(Refer to FIG. 1)

1. Locate and loosen side brush arm pivot screw on left hand side of the machine.
2. Separate pivot screw from washer, jam nut and shoulder nut.
3. Remove the old slide washer, and replace it with the new slide washer.

NOTE: Some machines may have 2 thrust washers and one slide washer per side. When reassembling each pivot with new slide washer, only one thrust washer is required.

4. Reassemble pivot screw, washer and nuts.
5. Tighten pivot screw until the "U" bracket begins to compress.
6. Torque the jam nut to 18-23 kg (40-50 ft.-lbs).
7. Repeat steps 1 through 6 on right hand side of machine, mirrored assembly to the left.

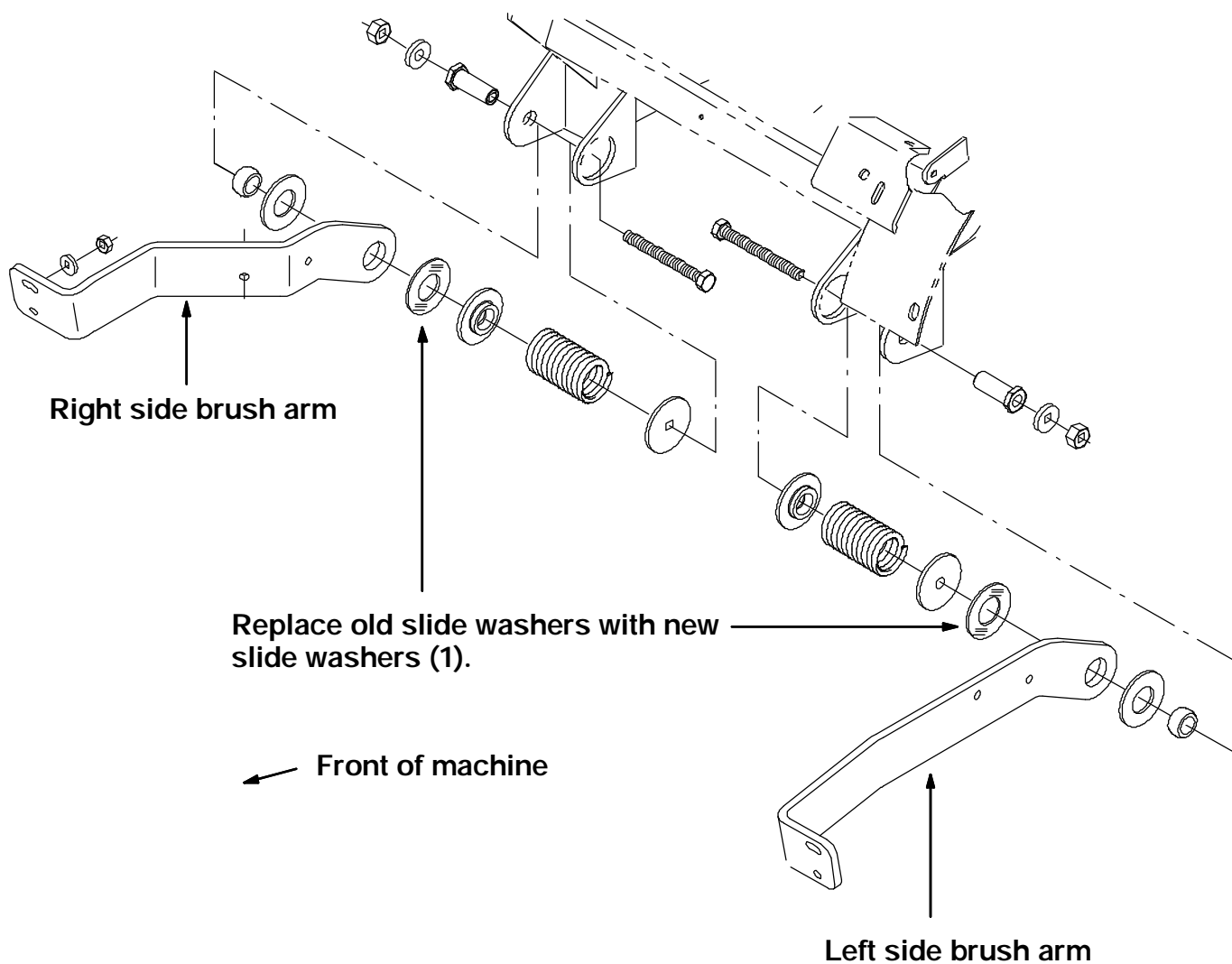

FIG. 1 - NEW SLIDE WASHER INSTALLATION

BILL OF MATERIALS FOR SIDE BRUSH PIVOT KIT 382615

Ref.	TENNANT Part No.	Description	Qty.
1	382616	Washer, slide	2

TENNANT COMPANY
P. O. Box 1452
Minneapolis, MN 55440-1452