



INSTRUCTION BULLETIN

No. 340180
Machine: 240EH, 540E,
242E and 242ESE
Published: 7-98/00
System: CHASSIS

NOTE: DO NOT DISCARD the Parts List from the Instruction Bulletin. Place the Parts List in the appropriate place in your machine manual for future reference. Retaining the Parts List will make it easier to reorder individual parts and will save you the cost of ordering an entire kit.

NOTE: Numbers in parenthesis () are reference numbers for parts listed in Bill of Materials.

Installation instructions for kit number 374630

SYNOPSIS / PROBLEM:

This kit contains the parts needed to replace the steering gear on the models 240EH, 540E, 242E and 242ESE sweeper/scrubbers.

Please follow step-by-step instructions.

SPECIAL TOOLS / CONSIDERATIONS: Torque Wrench

(Estimated time to complete: 3 hours)

PREPARATION:

(Refer to FIG. 1, 2 and 3)

FOR SAFETY: Before leaving or servicing machine, stop on level surface and set parking brake. Then turn off machine and remove key.

1. Shut off machine.
2. Locate old steering gear, and mounting assembly on machine.
3. Disconnect battery cables from machine.



WARNING: Always disconnect battery cables from machine before working on electrical components.

INSTALLATION:

(Refer to FIG. 1, 2 and 3)

1. Remove wiring harness from old steering gear. Remove and set aside the old steering gear assembly and mounting hardware from machine.
2. Mount the new bearing bracket (7) on the left side of the old bearing support, using two hex screws (8), flat washers (9) and flange nuts (10) as shown. Tighten with torque wrench to 36-47 ft. lbs. of torque. (Refer to FIG. 1)
3. Mount the new steering gear support plate (4) on the left side of the old plate, using two hex screws (5), and flange nuts (6) as shown. Tighten with a torque wrench to 65-85 ft. lbs. of torque. (Refer to FIG. 1)
4. Reassemble new steering gear assembly with new washer (11). Tighten to 129-168 lbs. of torque. (Refer to FIG. 2)

NOTE: Rotate existing bearing 180° before remounting between flanges.

5. Mount steering gear assembly loosely to new mounting brackets. Bolt bearing and flanges loosely to the left side of the new bearing bracket. (Refer to FIG. 1 and 2)
6. Remove back of the instrument panel.
7. Using one of the predrilled holes in the instrument panel as a pilot hole, drill one .938 dia. hole to install new horn button.
8. Remove wires from the old steering gear.
9. Add two male bullets to wires and route wires into instrument panel. Add one 1" grommet to bottom of instrument panel if required, and run wiring through it.
10. Mount and wire in new horn button. Reassemble back of control panel.
11. Place new horn label from label kit next to new horn button.
12. Tighten mounted gear mounting bolts (2) to 65-85lbs. of torque. (Refer to FIG. 1)
13. Tighten mounted bearing flanges to 16-21lbs. of torque. (Refer to FIG. 1 and 2)
14. Reconnect battery cables to machine. Start machine and check assembly for proper operation.

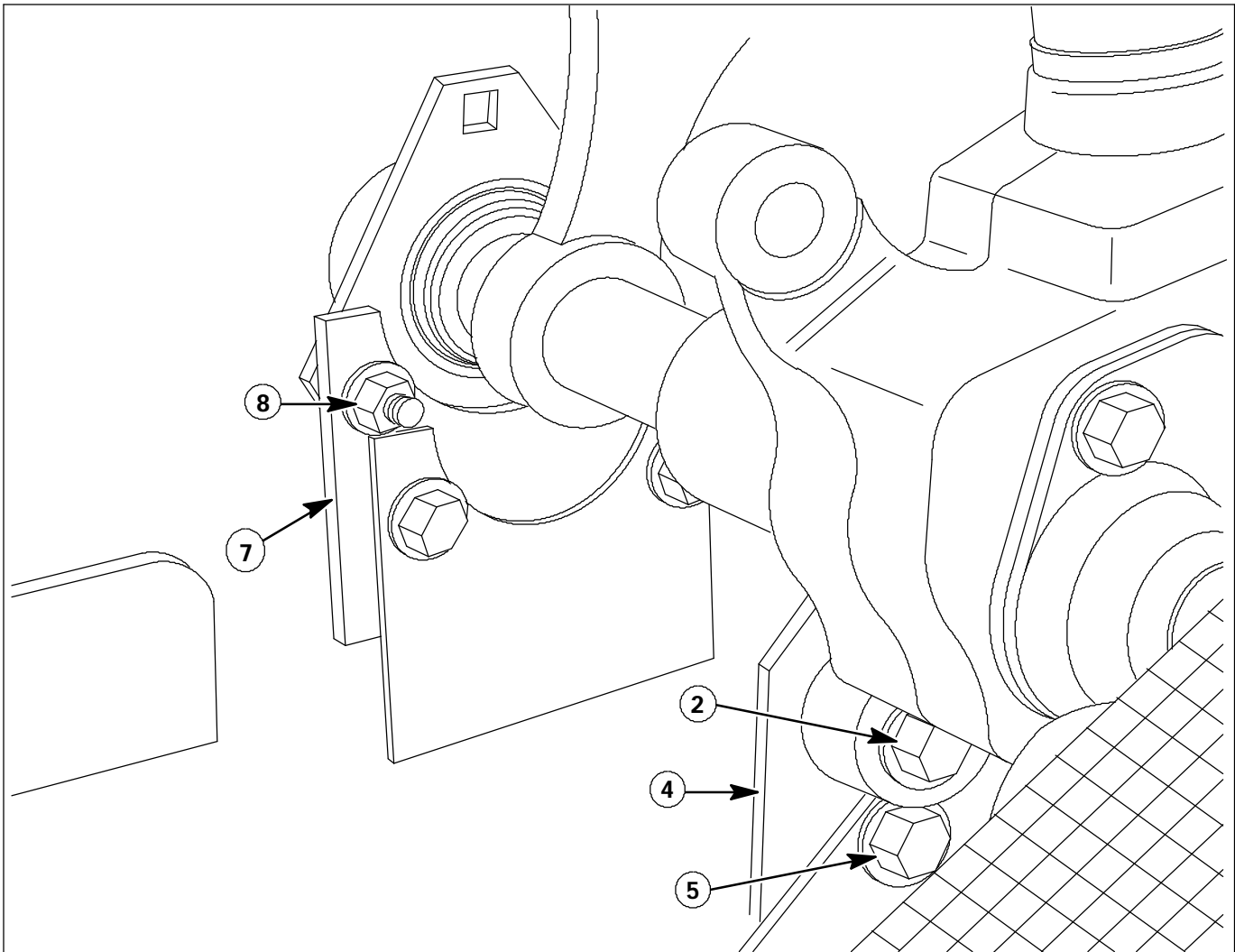

FIG. 1 Mounting New Bearing and Steering Gear Support Brackets

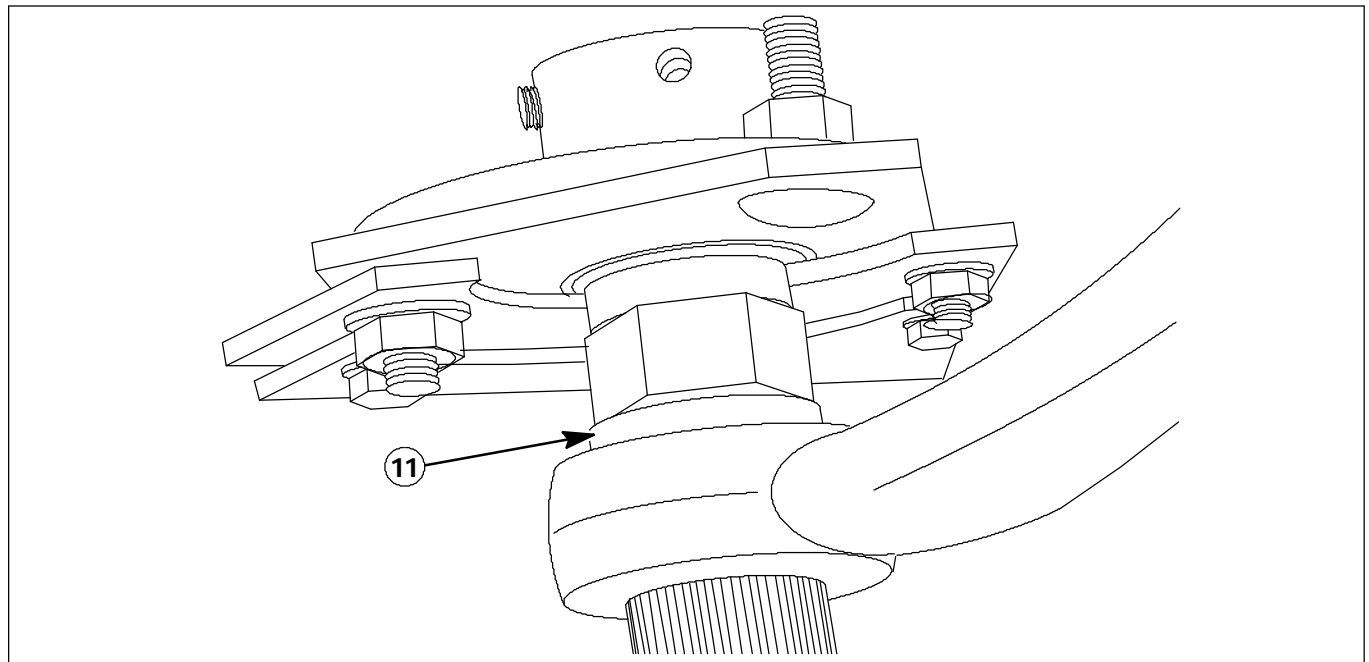

FIG. 2 Mounting Rotated Bearing and Existing Parts
BILL OF MATERIALS FOR STEERING GEAR REPLACEMENT KIT 374630

Ref.	TENNANT Part No.	Description	Qty.
1	374629	Steering Gear&Column, Invar	1
2	27982	Screw, Hex .50-13x1.75	2
3	27981	Nut, Hex Flange .50-13	2
4	374626	Plate, Steering Gear Support	1
5	39809	Screw, Hex .50-13x1.0	2
6	27981	Nut, Hex Flange .50-13	2
7	374627	Plate, Strg Gear Brg Support	1
8	36832	Screw, Hex .38-16x1.25	2
9	32492	Washer Flat .38 Hard	2
10	43865	Nut, Hex Flange .38-16	2
11	31705	Washer Flat .88 SAE	1
12	10632-8	Grommet, Rubber .75 ID	1
13	55272	Terminal, snaplg. 16m Ins. 14GA	2
14	44828	Switch, push button	1
15	71491	Label, set, operatnl.	1

TENNANT COMPANY
P. O. Box 1452
Minneapolis, MN 55440-1452