



INSTRUCTION BULLETIN

No. 340144
Machine: 8200/8210
Published: 4-98/00
System: OPTIONS

NOTE: DO NOT DISCARD the Parts List from the Instruction Bulletin. Place the Parts List in the appropriate place in your machine manual for future reference. Retaining the Parts List will make it easier to reorder individual parts and will save you the cost of ordering an entire kit.

NOTE: Numbers in parenthesis () are reference numbers for parts listed in Bill of Materials.

Installation instructions for kit number 365199

SYNOPSIS / PROBLEM:

This kit contains the parts needed to install a back-up alarm kit on the model 8200/8210 sweeper/scrubber. Please follow step-by-step instructions.

SPECIAL TOOLS / CONSIDERATIONS: None

(Estimated time to complete: 2 hours)

ASSEMBLE HORN AND LIGHT:

(Refer to FIG. 1, 2, and 4)

1. Install the grommet (2) in the large hole on top of the mount bracket (1). (Refer to FIG. 2)
2. Install the head light (7) in the left hole on top of the mount bracket (1). Use the hardware included with the light (4). (Refer to FIG. 2)
3. Install the horn (3) on top of the mount bracket (1) using two hex screws (4), two washers (5), and two nyloc nuts (6). (Refer to FIG. 2)
4. Use the hex screw (9) and nut (10) to install the flasher bracket (8) under the top lip of the back-up alarm mount bracket (1). Install the flasher (11) into the bracket (8). (Refer to FIG. 2)
5. Connect the power wire from the new harness (13) to one of the terminals of the flasher (11). (Refer to FIG. 2 and 4)
6. Connect the red wire from the horn (3) to the jumper wire coming off the terminal on the flasher (11). (Refer to FIG. 2 and 4)
7. Connect the wire from the headlight (7) to the open terminal on the flasher.
(Refer to FIG. 2 and 4)
8. Connect the ground wires from the light and horn to the black wire of the new harness (13).
(Refer to FIG. 2 and 4)
9. Use the dimensions in FIG. 1 to install the rubber seal (12) on the back of the mount bracket (1). (Refer to FIG. 1)
10. Install the shorter vinyl duct (14) on the vertical edge of the mount bracket (1). Open the vinyl duct up with a screw driver and install the new harness (13) into the channel.
(Refer to FIG. 2)

INSTALLATION:

(Refer to FIG. 2, 3, and 4)

FOR SAFETY: Before leaving or servicing machine, stop on level surface and set parking brake. Then turn off machine and remove key.



WARNING: Always disconnect battery cables from machine before working on electrical components.

1. Remove the two hex screws from the back of the seat mount plate. (Refer to FIG. 3)
2. Position the back-up alarm assembly behind the operators seat. (Refer to FIG. 2 and 3)
3. Line up the two mount holes in the back-up alarm assembly mount plate with the two holes in the seat mount plate. Reinstall the two hex screws and tighten. (Refer to FIG. 3)
4. Install the longer vinyl duct (15) onto the inside edge of the existing seat mount plate. Open the vinyl duct up with a screw driver and route the new harness (13) into the channel, over to the front of the solution tank, down the inside of the operators compartment, and then to the relay panel. (Refer to FIG. 3)
5. Locate relay number 4 and wire 31/BRN (with the open weatherpak connector). Plug the power wire of the new harness (13) into the connector of wire 31/BRN. (Refer to FIG. 4)
6. Connect the ground wire from the new harness (13) into the ground terminal of the machines horn. (Refer to FIG. 4)
7. Tie up the new harness so it does not come in contact with any hot or moving parts.
8. Start the machine and drive in reverse. Make sure the back-up alarm works properly.

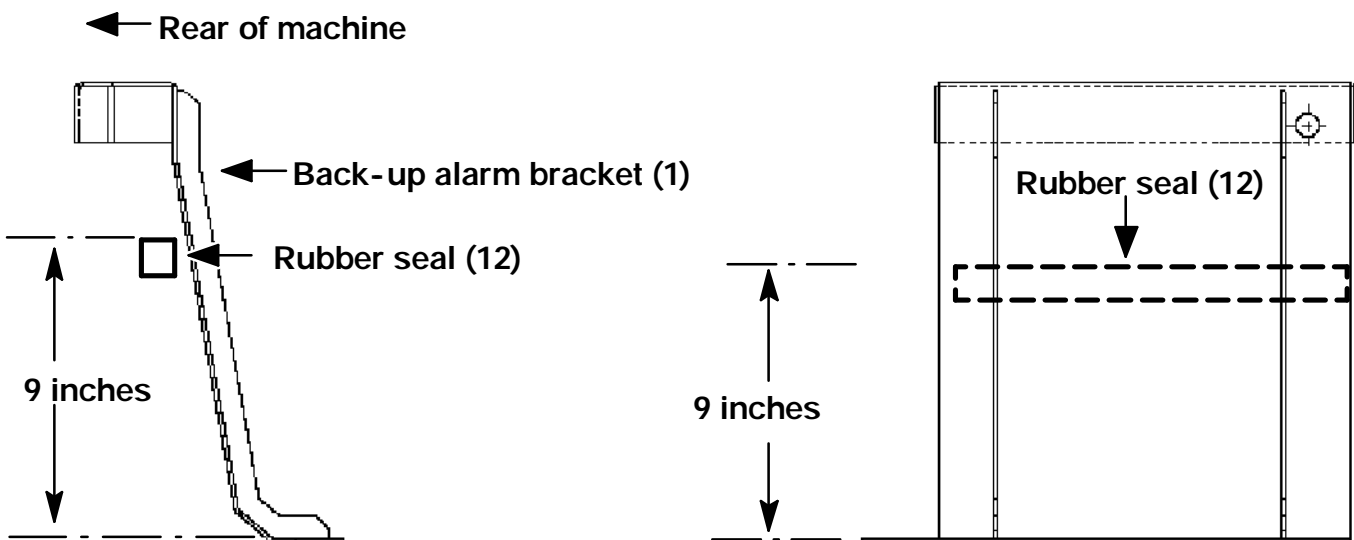

FIG. 1 - Back-up Alarm Mount Bracket (seal location)

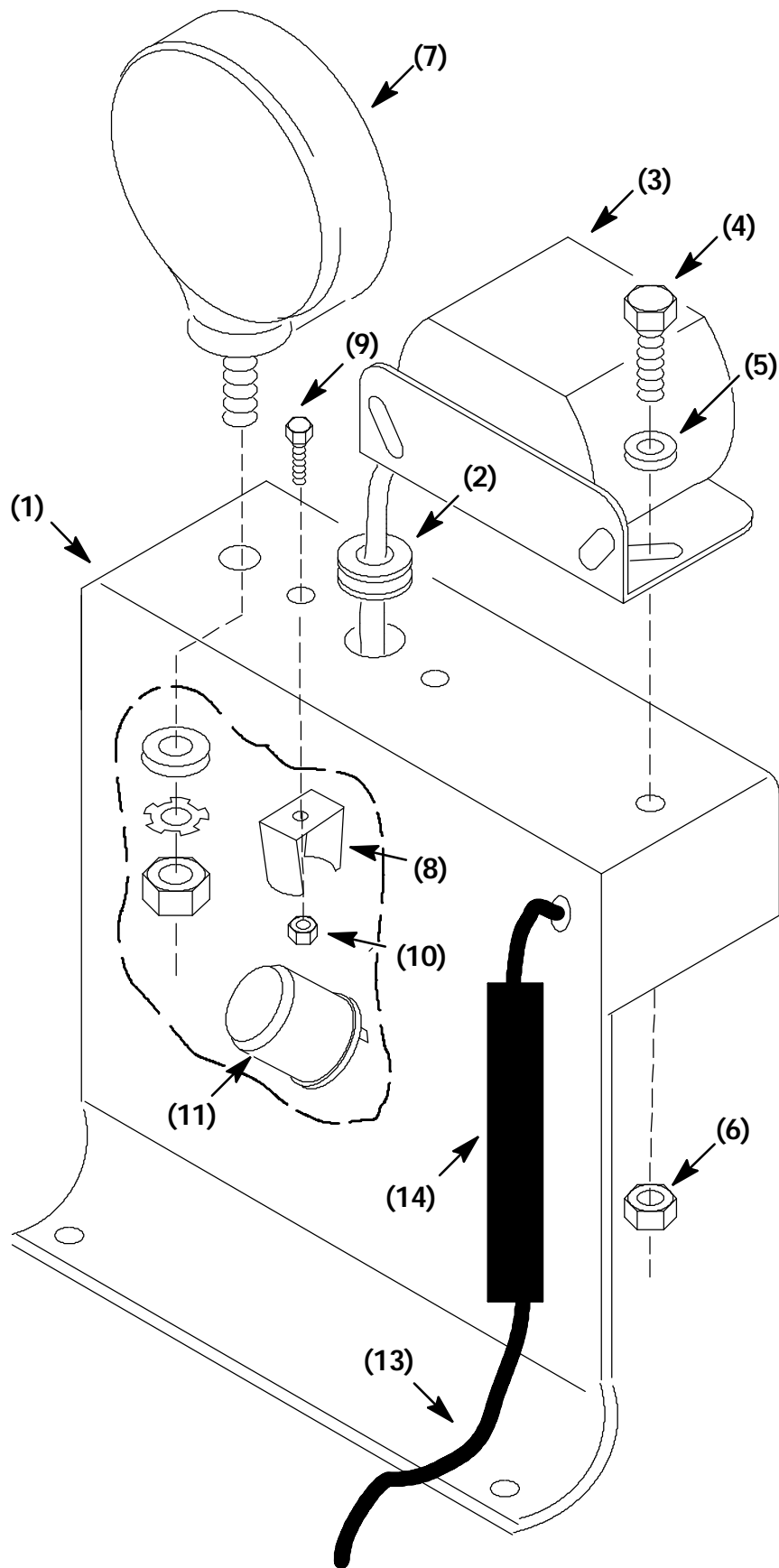

FIG. 2 - Back-up Alarm Assembly

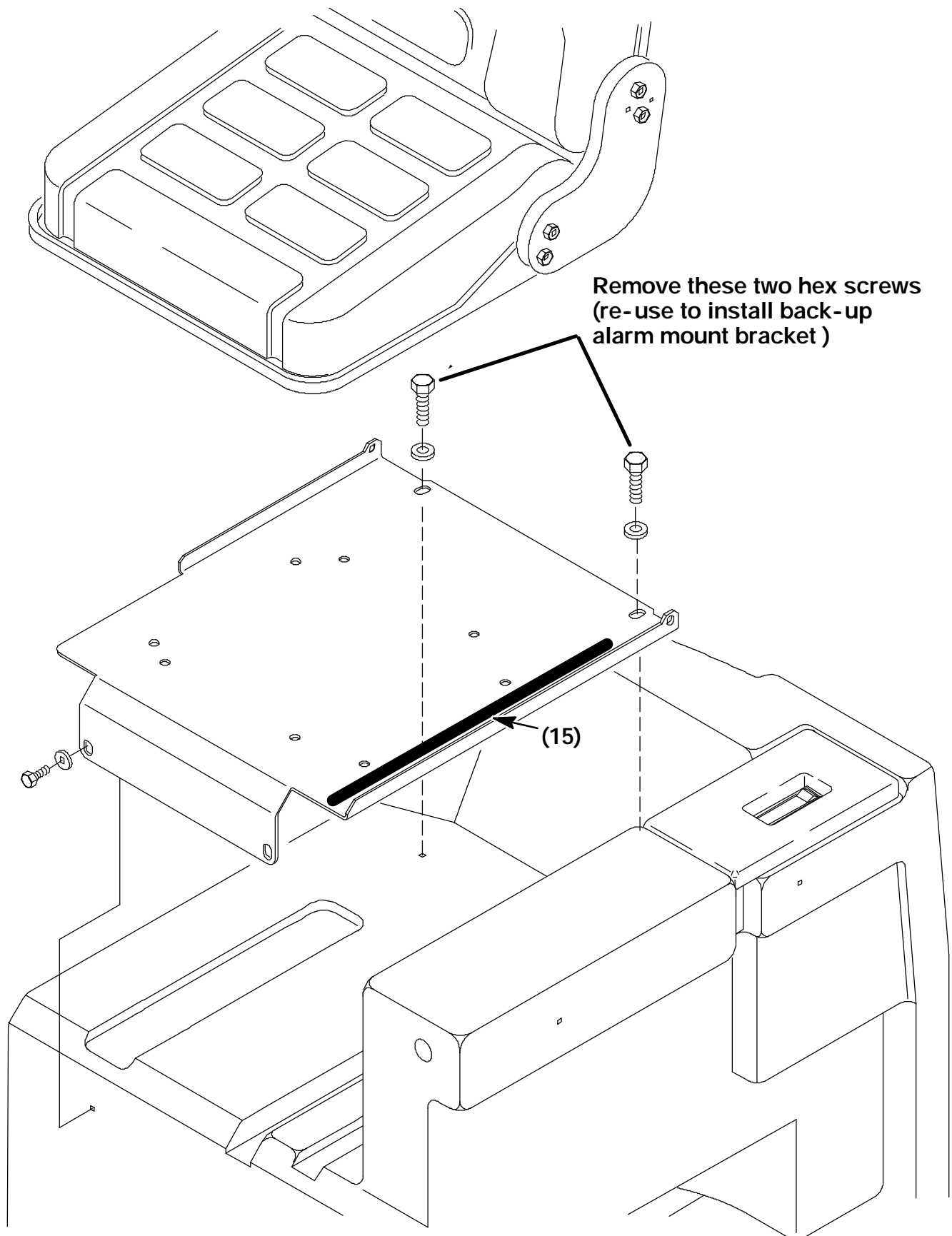

FIG. 3 - Back-up Alarm Assembly

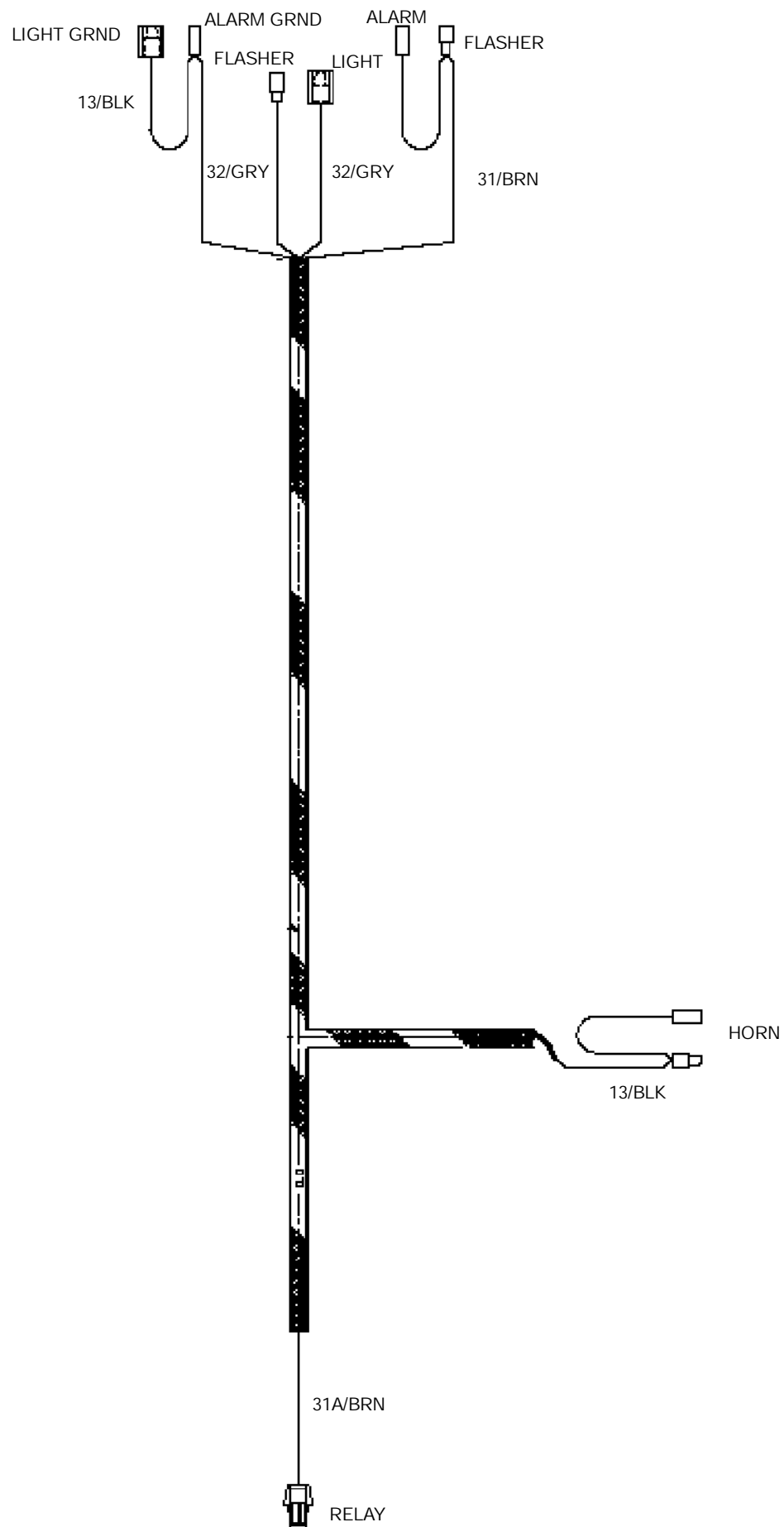

FIG. 4 - Back-up Alarm Wire Harness 365202

BILL OF MATERIALS FOR BACK-UP ALARM KIT 365199

Ref.	TENNANT Part No.	Description	Qty.
1	365192	Back-up alarm bracket	1
2	10632-9	Grommet	1
3	61920	Horn assembly	1
4	16931	M8 hex screw, 20mm	2
5	32491	Flat washer	2
6	08709	M8 nyloc nut	2
7	36438	Headlight assembly	1
8	24576-1	Flasher bracket	1
9	09206	M4 hex screw, 12mm	1
10	02850	M4 nyloc nut	1
11	31922	Flasher, 12v	1
12	80187	Rubber seal	1
13	365202	Wire harness	1
14	36330	Vinyl duct, 10 inch	1
15	36331	Vinyl duct, 16 inch	1

TENNANT COMPANY
P. O. Box 1452
Minneapolis, MN 55440-1452