



INSTRUCTION BULLETIN

No. 340012
Machine: 6400 E W/O OHG
Published: 10-96/00
System: OPTIONS

NOTE: DO NOT DISCARD the Parts List from the Instruction Bulletin. Place the Parts List in the appropriate place in your machine manual for future reference. Retaining the Parts List will make it easier to reorder individual parts and will save you the cost of ordering an entire kit.

NOTE: Numbers in parenthesis () are reference numbers for parts listed in Bill of Materials.

Installation Instructions for Kit number 361301.

SYNOPSIS / PROBLEM:

This kit contains the parts needed to install a Revolving Light Kit on the model 6400 sweeper (without an overhead guard).

Please follow step-by-step instructions.

SPECIAL TOOLS / CONSIDERATIONS: Hand Drill. 5/16" and 1/2" drill bits, 1" hole saw.
(Estimated time to complete: 1 hour)

INSTALLATION OF REVOLVING LIGHT, GUARD, AND SWITCH:

(Refer to FIG. 1, 2, and 3)

1. Raise hopper and engage support bar.

FOR SAFETY: Always stop machine on a level surface, set parking brake, then turn engine off and remove the key before leaving or servicing machine.

2. Remove rubber dust shield from operator side of machine.
3. Open seat support.
4. Disconnect battery cables from machine.



WARNING: Always disconnect battery cables from machine before working on electrical components.

5. Close seat support.
6. Drill mount holes in the seat support according to dimensions in FIG. 1. (Refer to FIG. 1)

NOTE: Drill the light mount hole to 5/16" on top and 1" on the underside of the seat support shroud.

7. Route wire harness (3) through 1/2" hole in seat support . (Refer to FIG. 1 and 2)
8. Plug wire harness (3) into light (1). (Refer to FIG. 2)
9. Install light (1) and guard strip (7) with hardware provided (5). (Refer to FIG. 2)

10. Use pre-drilled holes in louver flange to secure wire harness with cable ties (6).
(Refer to FIG. 3).

NOTE: Route and secure wire harness on the outside of the louver flange. (Refer to FIG. 3).

11. Remove switch plug from instrument panel. (Refer to FIG. 2)

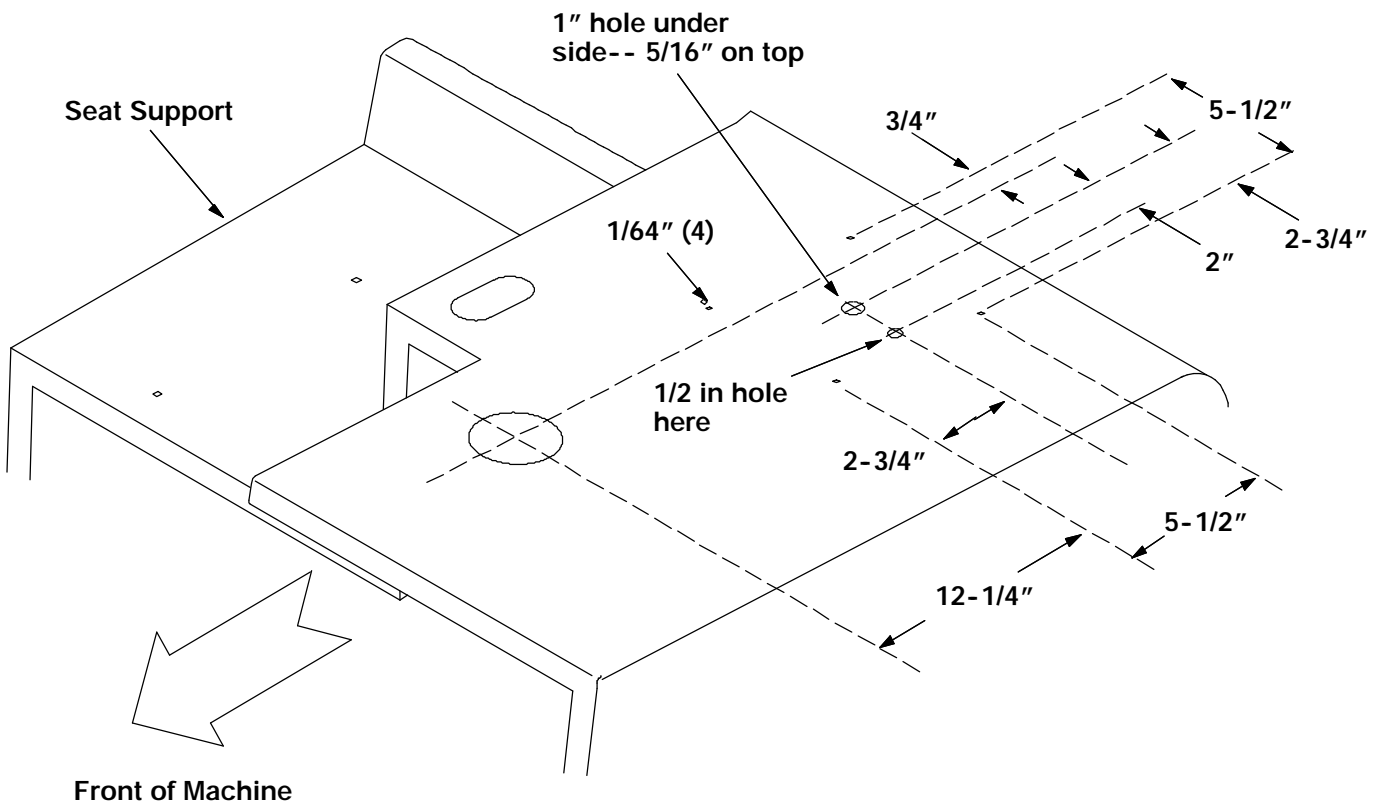

FIG. 1 - Dimensions of Holes to be Drilled for Installation of Revolving Light

12. Install switch (2) into instrument panel and plug into wire harness (3). (Refer to FIG. 2)
13. Open seat support and reconnect battery cables to battery.
14. Close seat support and lower hopper.
15. Reinstall rubber dust shield.

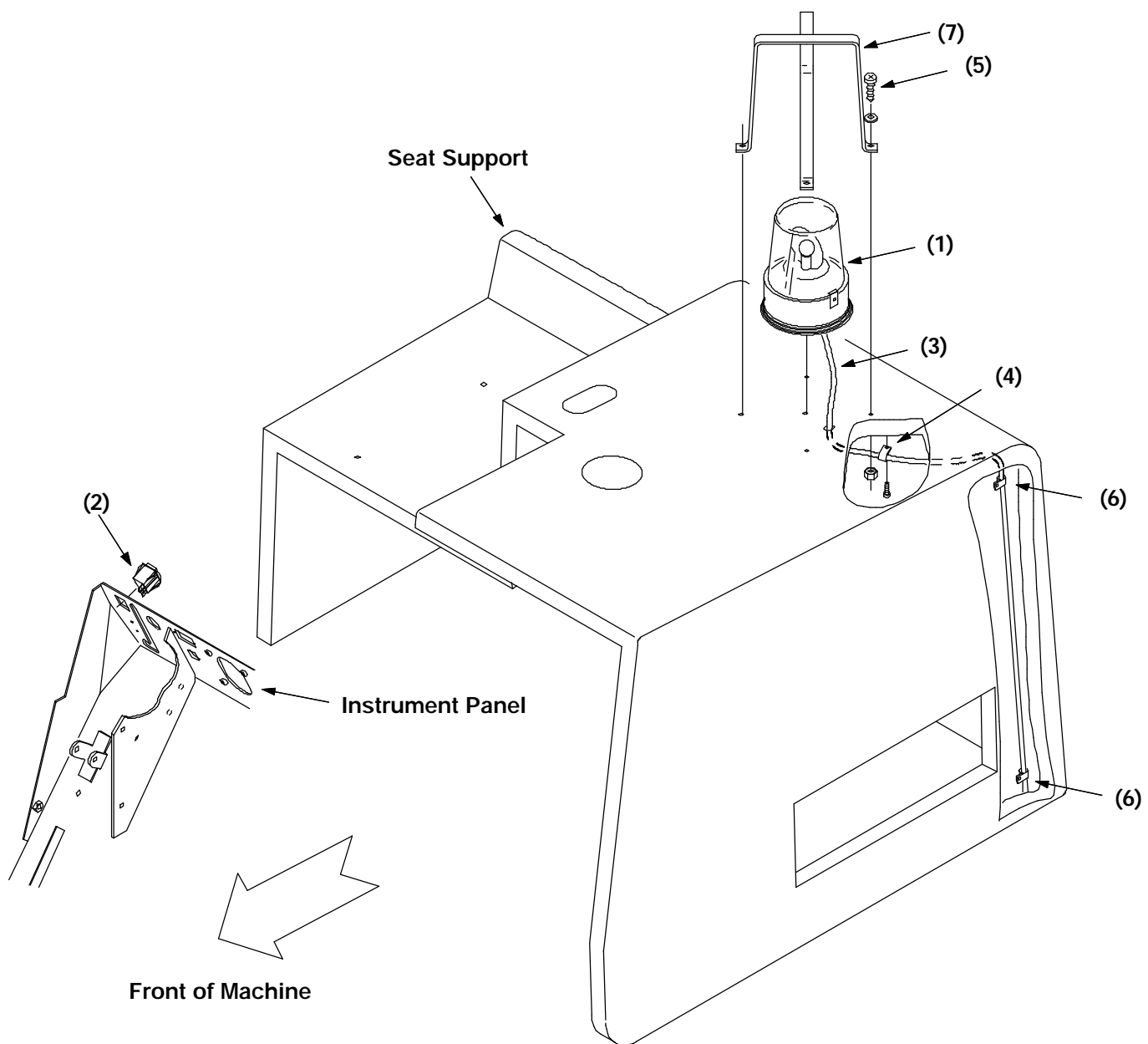

FIG. 2 - Revolving Light and Switch Assembly

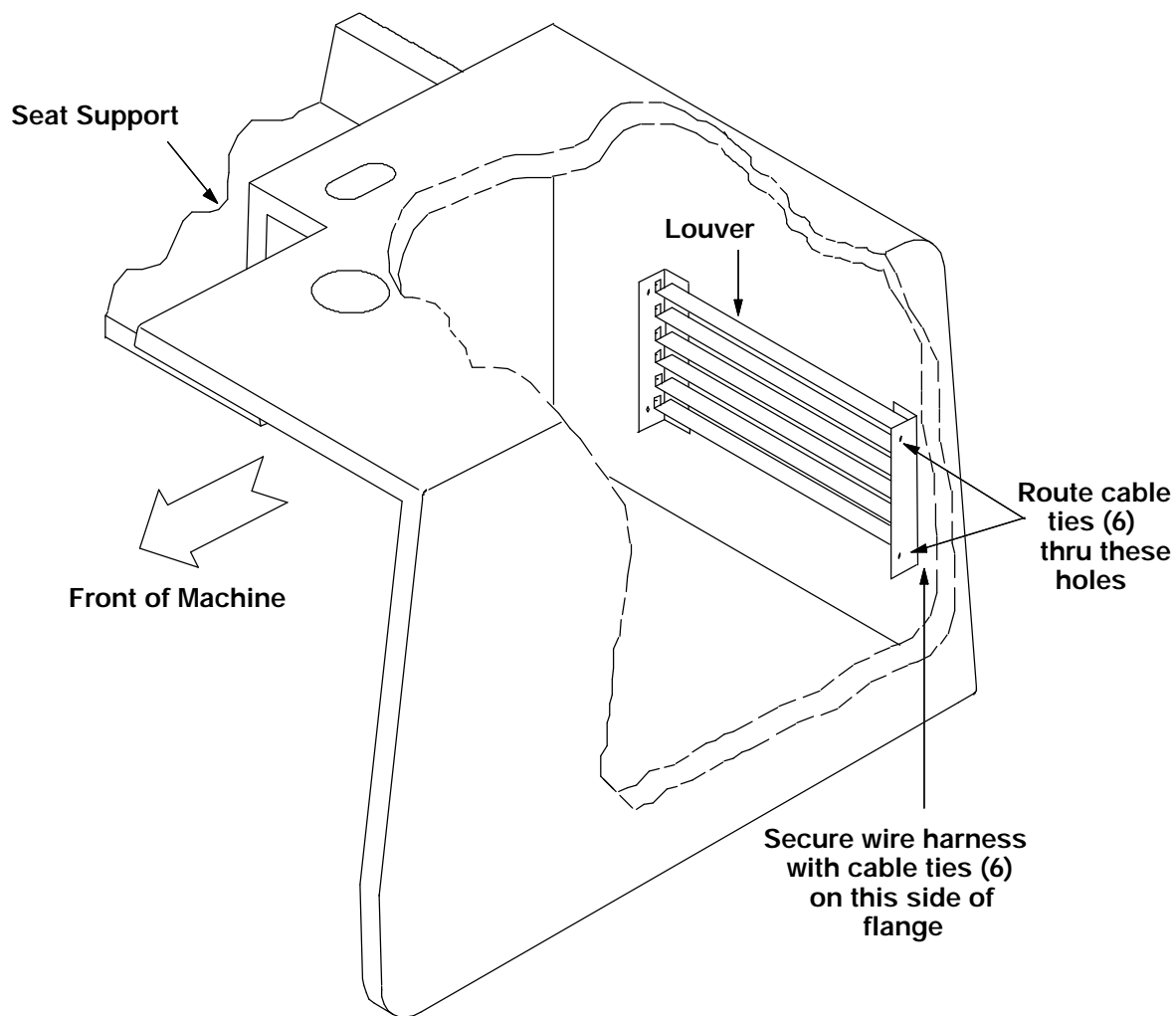

FIG. 3 - Location of Holes Used for Securing Wire Harness with Cable Ties

BILL OF MATERIALS FOR KIT NUMBER 361301

Ref.	TENNANT Part No.	Description	Qty.
1	361976	36V Revolving Amber Light	1
2	360520	Rocker Switch, 3 Pos. Spdt	1
3	360500	Warning Light Wire Harness 6400	1
4	26395-2	Cable Clamp, 0.38D, 0.38W Stl	1
5	360973	Pan Screw, 12 X 50 F/PLST PL	5
6	49266	Cable Tie	2
7	361940	Guard Strip	1

TENNANT COMPANY
P. O. Box 1452
Minneapolis, MN 55440-1452