



INSTRUCTION BULLETIN

No. 340007
Machine: 385 DLH
Published: 11-99/01
System: ENGINE

NOTE: DO NOT DISCARD the Parts List from the Instruction Bulletin. Place the Parts List in the appropriate place in your machine manual for future reference. Retaining the Parts List will make it easier to reorder individual parts and will save you the cost of ordering an entire kit.

NOTE: Numbers in parenthesis () are reference numbers for parts listed in Bill of Materials.

Installation Instructions for Kit number 374502

SYNOPSIS / PROBLEM:

This kit contains the parts needed to replace the exhaust pipes on the model 385DLH sweeper. Please follow step-by-step instructions.

SPECIAL TOOLS / CONSIDERATIONS: Hand drill, .438 dia. drill bit, Grinder or torch.

(Estimated Time to complete: 1 hour)

INSTALLATION:

(Refer to FIG. 1)

FOR SAFETY: Before leaving or servicing machine, stop on level surface and set parking brake. Then turn off machine and remove key.

1. Jack up the rear of the machine and install jack stands under the frame.
2. Remove the four muffler clamps from the machine exhaust system. (Refer to FIG. 1)
3. Remove the muffler, lower exhaust pipe, and upper exhaust pipe. Retain the muffler and discard the two other pipes. (Refer to FIG. 1)
4. Remove the four hex screws holding the engine exhaust pipe to the engine manifold. Remove and discard the manifold exhaust pipe.
5. Install the new engine exhaust pipe (2) to the engine manifold. Use the four new hex screws (7) and flat washers (8). Tighten to 11 - 14 Nm. (Refer to FIG. 1)
6. Install the new upper exhaust pipe (3) on the new engine manifold (2). Loosely install one new muffler clamp (5). (Refer to FIG. 1)
7. Install the new lower exhaust pipe (4) on the new upper exhaust pipe (2). Loosely install one new muffler clamp (5). (Refer to FIG. 1)
8. Reinstall the old muffler on the new lower exhaust pipe (4). Loosely install one new muffler clamp (5). (Refer to FIG. 1)

9. Reinstall the muffler clamp on the outlet on the engine muffler. Firmly tighten all of the muffler clamps. (Refer to FIG. 1)

NOTE: If the muffler hanger mount bracket is broken, see IB 340006 for repair instructions.

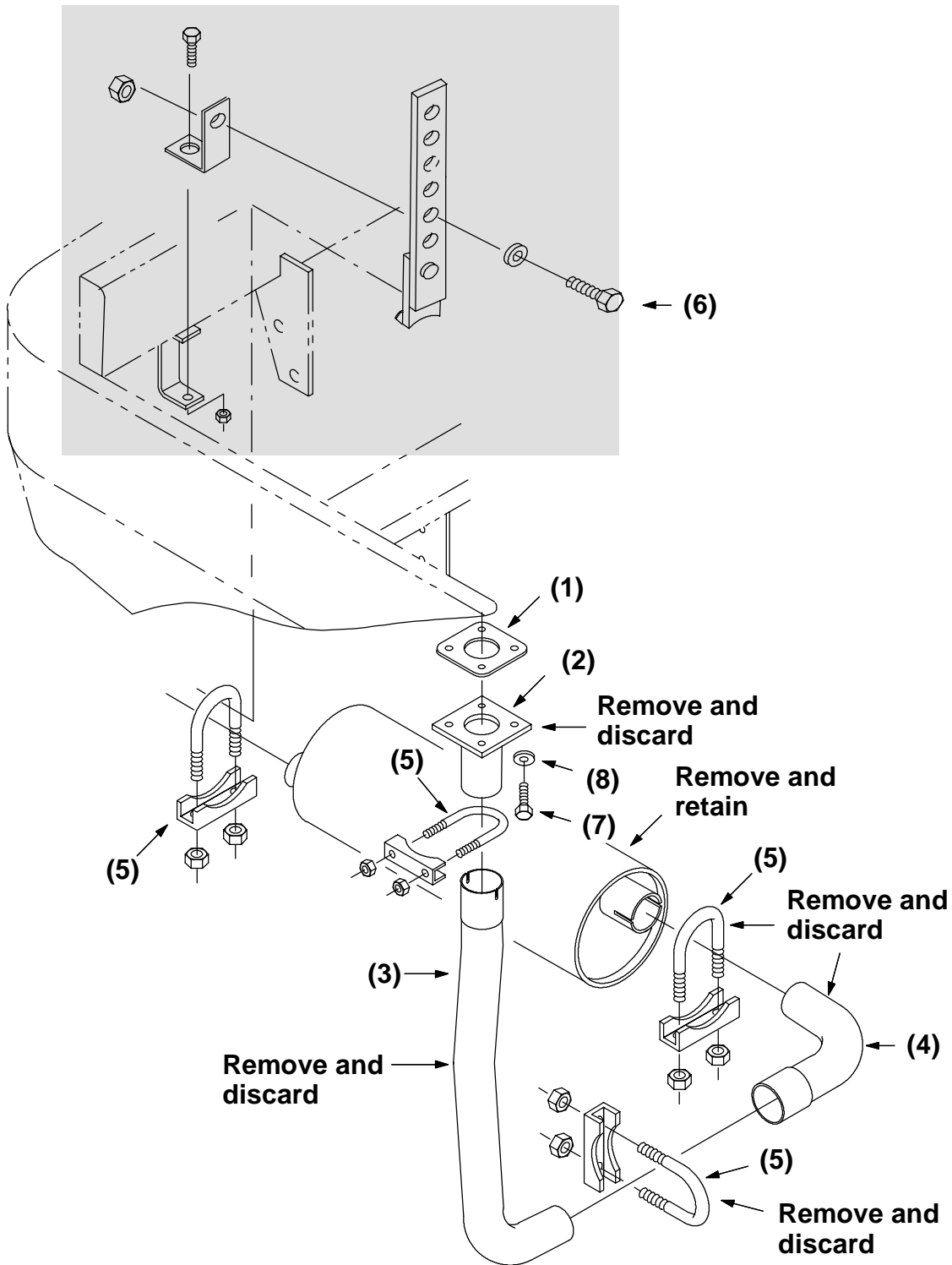

FIG. 1 - 385DLH Muffler, Tail Pipe, And Hanger Assembly

10. Remove the jack stands and lower the machine.
11. Start the machine and check the new exhaust system for proper operation. (Refer to FIG. 1)

BILL OF MATERIALS FOR MUFFLER HANGER BRACKET KIT 374501

Ref.	TENNANT Part No.	Description	Qty.
1	51332	Gasket	1
2	74452	Exhaust pipe, manifold	1
3	72563	Exhaust pipe, upper	1
4	72484	Exhaust pipe, lower	1
5	24012	Muffler clamp	3
6	374677	Hanger kit	1
7	16931	Hex bolt	4
8	32984	Flat washer	4

TENNANT COMPANY
P. O. Box 1452
Minneapolis, MN 55440-1452